



## Drayton Park, N5

£500,000

Located within the desirable Ashburton Triangle, this spacious three bedroom apartment features open plan living and three well proportioned bedrooms. The principal bedroom also benefits from a private balcony.

Ashburton Triangle is located off Drayton Park, moments from Arsenal tube station (Piccadilly Line) as well as being within easy reach of Drayton Park, Holloway Road and Highbury & Islington stations (Overground).

### Features

- Three Bedroom
- Open Plan Living
- Two Balconies
- Concierge
- Lift Access
- Premium Location

# Drayton Park, London, N5

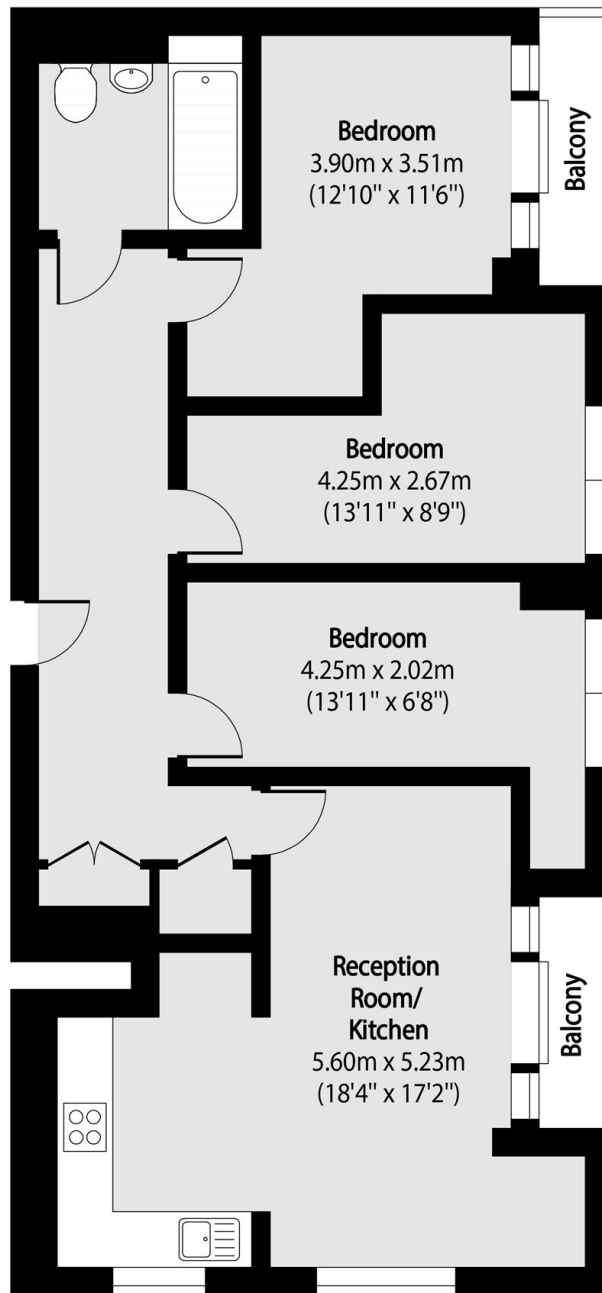

Total area (approx): 70.95 sq m (764 sq. ft)

Balcony total area (approx): 3.78 sq m (41 sq. ft)