



**2 Lower Stoke
Bath, BA2 7FU**

Guide Price £525,000

A three bedroom, detached, 1920's extended bungalow in an elevated position with ample driveway parking.

2 Lower Stoke, Limpley Stoke, Bath BA2 7FU

Approximate Gross Internal Area = 81.3 sq m / 875 sq ft

Terrace = 78.6 sq m / 846 sq ft

Total = 159.9 sq m / 1721 sq ft

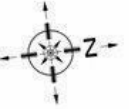
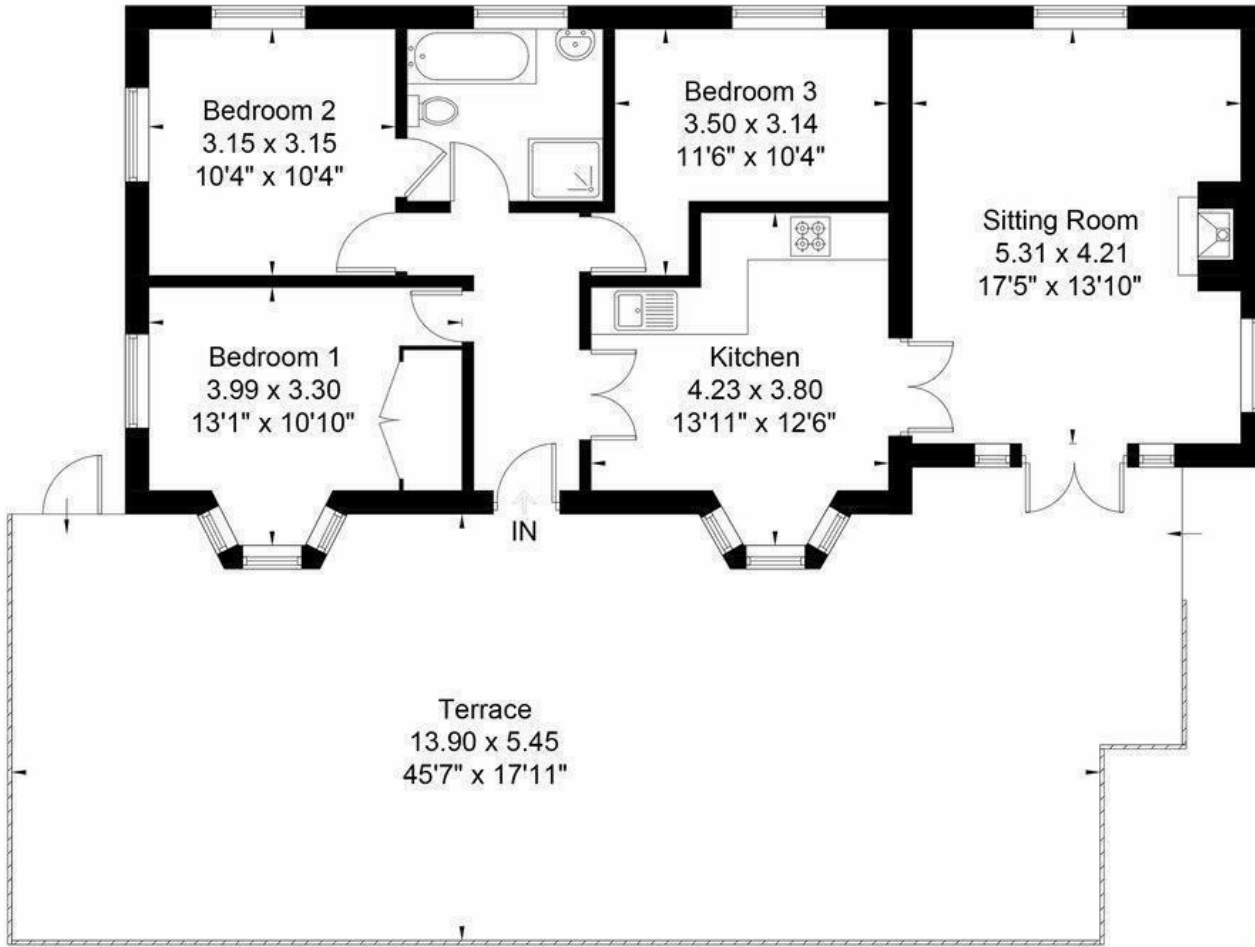

These plans are prepared in accordance with the guidelines as set out by the RICS Code of Measuring Practice. Whilst every attempt has been made to ensure accuracy, all measurements should be treated as approximate and as such are for illustrative purposes only. Not to Scale. Photography | Video Tours | Floor Plans | Energy Performance Certificates | Design | Print | www.roomcpm.com | © Room - Creative Property Marketing Ltd 2021

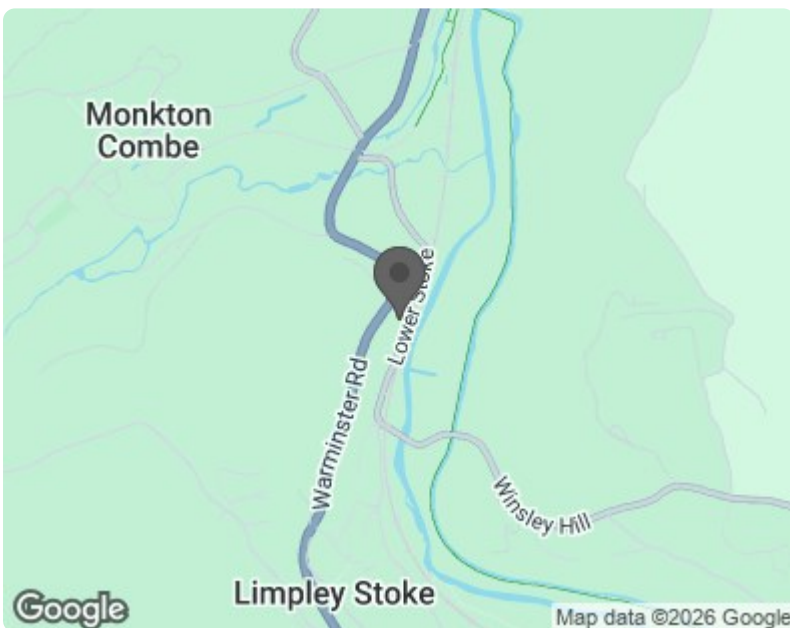

Energy Efficiency Rating		Current	Potential
Very energy efficient - lower running costs			
(92 plus)	A		100
(81-91)	B		
(69-80)	C		
(55-68)	D		
(39-54)	E		
(21-38)	F		
(1-20)	G		
Not energy efficient - higher running costs			
England & Wales		EU Directive 2002/91/EC	

Environmental Impact (CO ₂) Rating		Current	Potential
Very environmentally friendly - lower CO ₂ emissions			
(92 plus)	A		
(81-91)	B		
(69-80)	C		
(55-68)	D		
(39-54)	E		
(21-38)	F		
(1-20)	G		
Not environmentally friendly - higher CO ₂ emissions			
England & Wales		EU Directive 2002/91/EC	