



Asking Price Of £219,950

St. Marys Park,  
Collaton St. Mary,  
Paignton, TQ4 7DA

A two bedroom semi detached bungalow, in the highly popular Collaton St. Mary location. The property benefits from a good sized plot with driveway and large gardens to the rear. Whilst benefitting from gas central heating and uPVC double glazing, the property does require some updating. No forward and viewing is recommended.



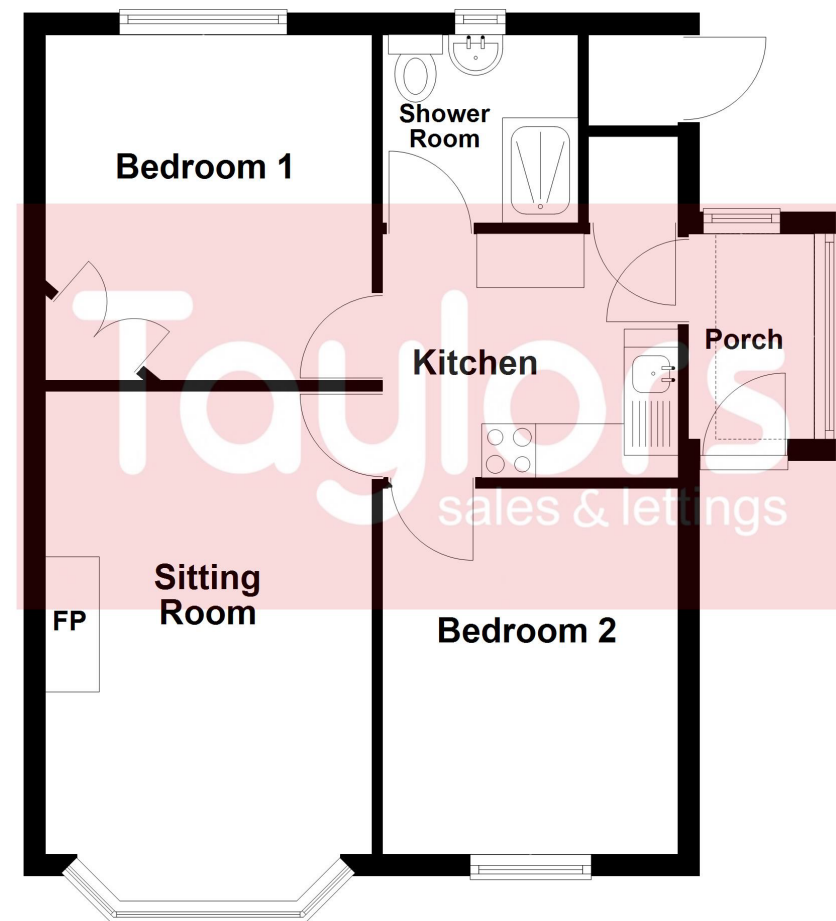

uPVC double glazed front door to:-

ENTRANCE PORCH Half glazed door to:-

KITCHEN - 3m x 2.6m (9'10" x 8'6") Fitted wall and base units. Walk in pantry.

LOUNGE/DINER - 4.9m INTO BAY x 3.1m MAX (16'0" x 10'2") Feature fireplace with inset coal effect fire. uPVC double glazing. Countryside views. Central heating radiator.

BEDROOM ONE - 3.5m x 2.8m (11'5" x 9'2") uPVC double glazing. Central heating radiator. Country views.

BEDROOM TWO - 3.2m x 3.2m (10'5" x 10'5") uPVC double glazing. Central heating radiator. Views over garden.

SHOWER ROOM Laid out as a wet room with large shower cubicle area, electric shower, vanity basin and low level WC. Fully tiled, central heating radiator and uPVC double glazing.

OUTSIDE Driveway

FRONT GARDEN Lawned garden area.

REAR GARDEN Patio area onto large lawned gardens with mature borders. Garden shed installed in 2024. Garden store with a new Worcester Bosch boiler installed in August 2024. Side access.

Address 'St. Marys Park, Collaton St. Mary, Paignton, TQ4 7DA'

Tenure 'Freehold'

Council Tax Band 'C'

EPC Rating '73 | C'

Taylor's Estate Agents  
24-26 Hyde Road  
Paignton  
Devon  
Tq4 5by