



£190,000

Roger Close, Sutton-In-Ashfield,

Welcome to **BuckleyBrown**, where every home is carefully presented, so you can explore with clarity and confidence.

**BuckleyBrown**  
ESTATE AGENTS

"A fantastic example of a move-in-ready bungalow, this detached two-bedroom home has been tastefully refreshed with neutral décor throughout, creating a bright and welcoming environment. Vacant and available for immediate occupation, it presents an excellent opportunity for buyers seeking a straightforward purchase and a home they can enjoy

- Luke, Valuer



## WHERE COMFORT MEETS CONVENIENCE

*Stepping inside, the first impression is one of space, light and simplicity.*

Freshly decorated in neutral tones throughout, the accommodation provides a clean and inviting canvas ready for a new owner to make their own. The practical single-storey layout makes the property particularly well suited to those looking to downsize, retirees seeking comfortable and manageable living, or buyers searching for an easily accessible home with the convenience of being ready to move straight into.



## THE FINER DETAILS

*Offering well-proportioned accommodation throughout and presented in move-in-ready condition, this delightful detached bungalow combines practicality with comfort in an appealing residential setting.*

The accommodation is entered via a welcoming entrance porch, complete with a useful storage cupboard, leading through to a spacious lounge featuring an attractive fireplace that creates a natural focal point to the room. Adjacent is a fully equipped kitchen, offering ample storage and workspace to cater for everyday living.

The bungalow continues with two generous double bedrooms, both providing comfortable and versatile accommodation, together with a well-appointed three-piece bathroom suite.

Externally, the property enjoys a private gated driveway to the front, complemented by decorative gravel for ease of maintenance and kerb appeal. To the rear, an enclosed garden provides a wonderful sun trap, beautifully enhanced by an array of established plants and shrubs, creating a peaceful outdoor space in which to relax and unwind.





**BuckleyBrown**  
ESTATE AGENTS







## LIFE IN SUTTON-IN-ASHFIELD

***Situated in the heart of Sutton-in-Ashfield, the property enjoys a convenient location with a wide range of everyday amenities close at hand.***

The town centre offers an excellent selection of shops, supermarkets, cafés and leisure facilities, while nearby retail parks provide further choice for shopping and dining. Regular public transport services and easy access to major road networks, including the A38 and M1, make travelling throughout the region straightforward.

For those who enjoy the outdoors, Sutton-in-Ashfield is well placed to take advantage of a variety of green spaces and recreational opportunities. Nearby parks, walking routes and nature reserves offer plenty of scope for leisurely strolls and outdoor activities, while the surrounding Nottinghamshire countryside provides an attractive backdrop to daily life. Combining convenience, community spirit and excellent connectivity, the area continues to be a popular choice for a wide range of buyers.



Ground Floor  
63sq.m/680.40sq.ft  
Approx

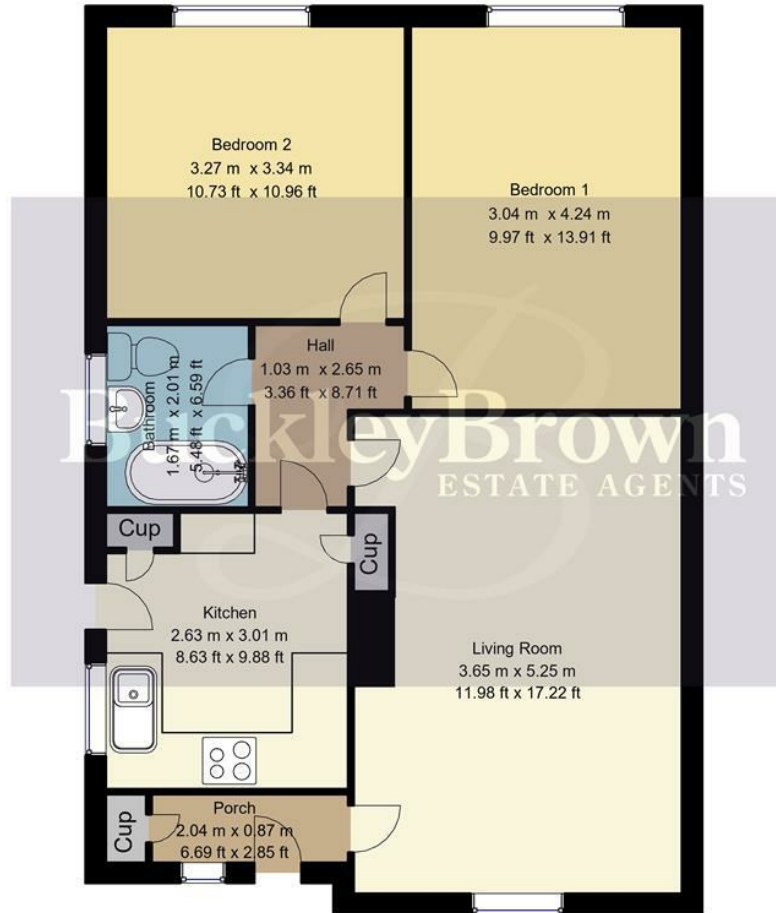

Whilst every attempt has been made to ensure the accuracy of the floor plan contained here, no responsibility is taken for incorrect measurements of doors, windows, appliances and room or any error, omission or misstatement. Exterior and interior walls are drawn to scale based on interior measurements. Any figure given is for initial guidance only and should not be relied on as basis of valuation. These plans are for marketing purposes only and should be used as such by any prospective purchase. Specially no guarantee is should not be relied on as a basis of valuation. These plans are for marketing purposes only and should be used as such by any prospective purchase. Specifically no guarantee is given on the total square footage of the property if quoted on this plan.

## Key Features

Detached two bedroom bungalow

---

Move in ready and neutral throughout

---

Private driveway

---

Spacious lounge with feature fireplace

---

Enclosed rear garden sun trap

---

Three piece bathroom

---

Fully equipped kitchen

---

Size Approximately 680 sq.ft

---

Energy Performance Certificate (EPC)

Rating D

---

Council Tax Band B

---



These particulars are intended as a guide only and do not form part of any offer or contract. All descriptions, measurements, images and plans are provided for illustration purposes and should not be relied upon as statements of fact. Prospective purchasers should satisfy themselves as to the accuracy of the information. Buckley Brown Estate Agents accept no liability for any loss arising from reliance on these details.

© Buckley Brown Estate Agents 2026. All rights reserved.

Exceptional homes deserve  
exceptional representation.

Let's Chat.

01623 633633

[mansfield@buckleybrown.co.uk](mailto:mansfield@buckleybrown.co.uk)

[buckleybrown.co.uk](http://buckleybrown.co.uk)

**BuckleyBrown**  
ESTATE AGENTS