



**20a Park Street, Ivybridge, PL21
9DP
Guide Price £189,950**

MILLINGTON TUNNICLIFF

20a Park Street,
Ivybridge, PL21
9DP

FLOORPLAN

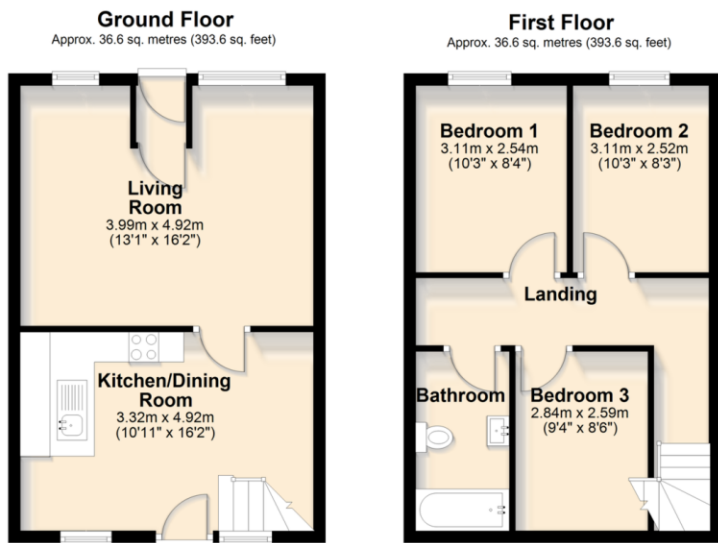

Total area: approx. 73.1 sq. metres (787.3 sq. feet)



3



1



2



A



EPC

D 63



787.3
SQFT

Guide Price £199,950

SUMMARY

A 3 bedroom mid terraced cottage located centrally within Ivybridge, convenient to local amenities. The house offers a spacious living room and kitchen/diner on the ground floor, together with landing, the 3 bedrooms and bathroom/WC on the upper floors. The house is Upvc double glazed and gas centrally heated. Externally there is a courtyard garden. No chain. EPC D 63.

No Chain | EPC D 63 | Gas Central Heating | Upvc Double Glazing | Enclosed South Westerly Facing Courtyard Garden | Kitchen/Diner | Spacious Living Room | First Floor Bathroom/WC | Located Centrally Convenient To Amenities | 3 Bedroom Mid Terraced Cottage

CONTACT

19 Fore Street, Ivybridge,
Devon, PL21 9AB

EMAIL

info@millingtontunnicliff.co.uk

TEL

01752 896020

www.millingtontunnicliff.co.uk