



Creffield Road, W5

Long Let. A large one bedroom flat on the first floor of this grand period building situated on the highly desirable Creffield Road just a short stroll from Ealing Common.

- Large one bedroom
- Period conversion
- First floor
- Walking distance to the tube
- Great for local amenities
- Available from July 1st 2026

£1,975 Per Month

Creffield Road

Approximate Gross Internal Area
474 sq ft - 44 sq m

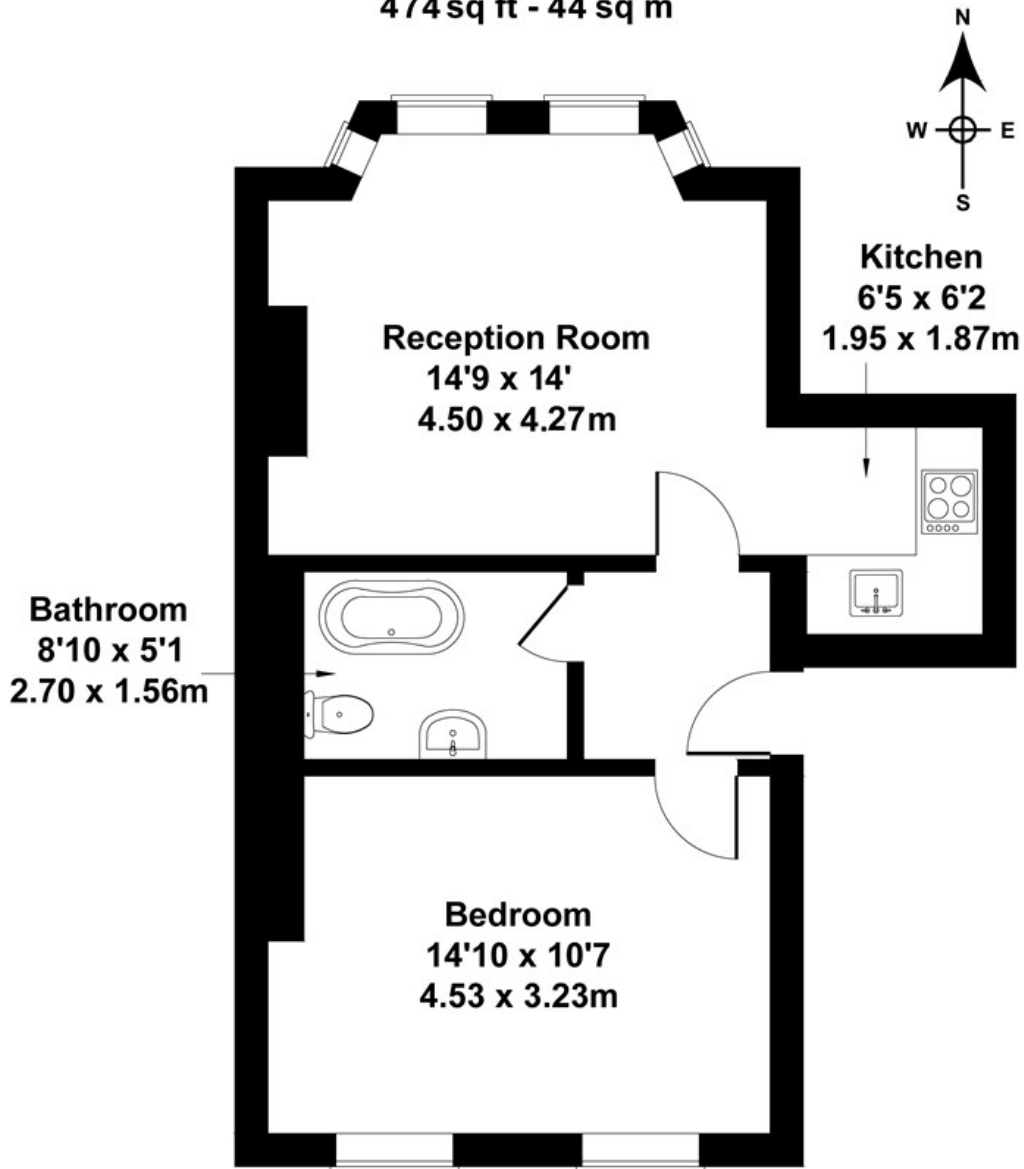

FIRST FLOOR

Not to Scale. Produced by The Plan Portal 2023
For Illustrative Purposes Only.

Energy Efficiency Rating		Current	Potential
<i>Very energy efficient - lower running costs</i>			
(92 plus) A			
(81-91) B			
(69-80) C			
(55-68) D			
(39-54) E			
(21-38) F			
(1-20) G			
<i>Not energy efficient - higher running costs</i>			
England & Wales		EU Directive 2002/91/EC	