



Plantation Avenue, Marcham, Abingdon, OX13 6FS

welcome to

Plantation Avenue, Marcham Abingdon

Allen and Harris are proud to present this three-bedroom property situated in the popular village of Marcham, constructed in approximately 2017 by Taylor Wimpey homes. The property is approached via an entrance hall which gives access to the sitting room, the sitting room measures just under 14ft in length and gives access to the kitchen dining room. The generous kitchen/dining room measures in excess of 15ft and has a range of modern eye and base level units and is fully integrated to include built in oven, built in gas hob with built in extractor fan, built in dishwasher, fridge and washing machine, there is also French doors leading out to the rear garden and a door to a modern downstairs cloakroom.



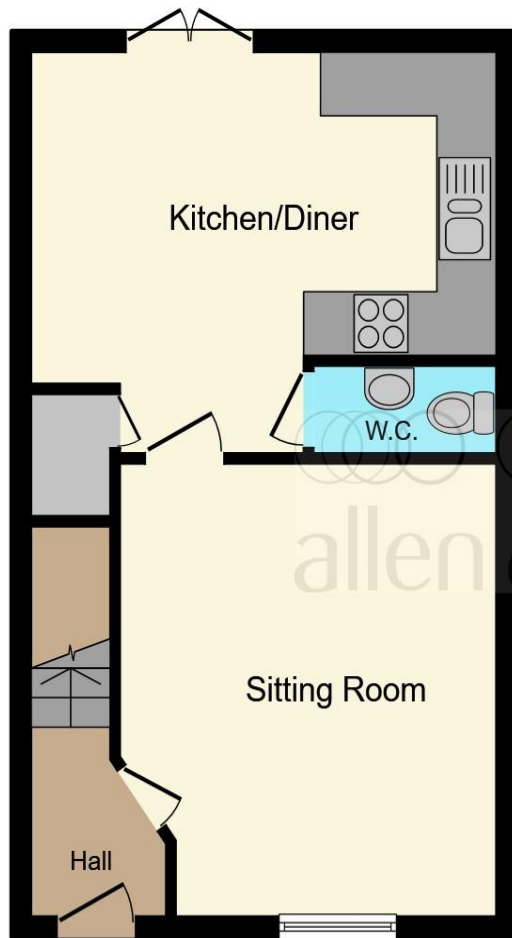

Ground Floor

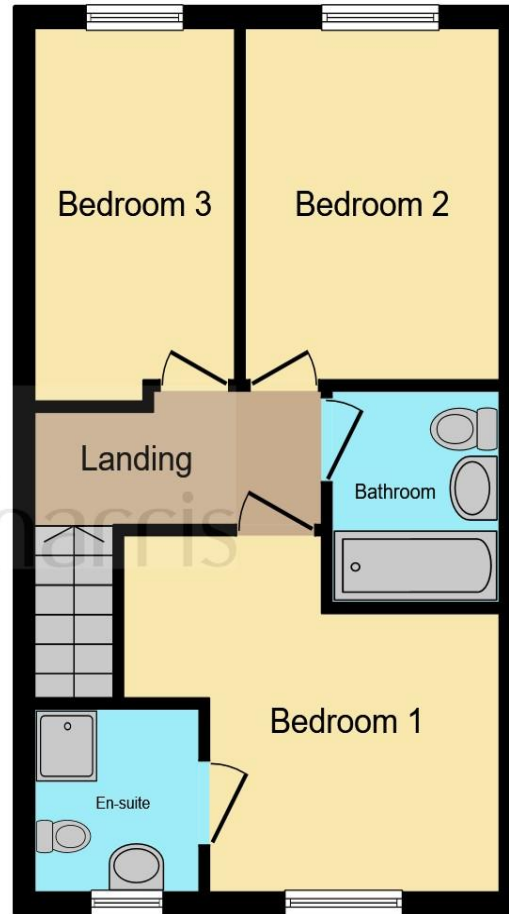

First Floor

Entrance Hall

Lounge

12' 11" x 14' (3.94m x 4.27m)

Kitchen

15' 5" x 9' 4" (4.70m x 2.84m)

Bedroom One

11' 2" x 9' 8" (3.40m x 2.95m)

Bedroom Two

8' 6" x 10' 8" (2.59m x 3.25m)

Bedroom Three

6' 6" x 11' 2" (1.98m x 3.40m)

Rear Garden

This floor plan is for illustrative purposes only. It is not drawn to scale. Any measurements, floor areas (including any total floor area), openings and orientation are approximate. No details are guaranteed, they cannot be relied upon for any purpose and they do not form part of any agreement. No liability is taken for any error, omission or misstatement. A party must rely upon its own inspection(s). Powered by www.focalagent.com

welcome to

Plantation Avenue, Marcham Abingdon

- Three-Bedroom
- Village Location of Marcham
- Generous Kitchen/Dining Room
- French Doors to Rear Garden
- En-suite Shower Room
- Garage
- Driveway Parking for Several Cars
- The Property Has NHBC Guarantee Until November 2027

Tenure: Freehold EPC Rating: B
Council Tax Band: D

guide price

£410,000

The First floor offers three bedrooms and a family bathroom, the main bedroom measures over 11 ft and has the benefit of an en-suite shower room.

To the rear is a pleasant garden with a patio area, lawn and a decked area. There is also a courtesy door into the side of the garage and side gated access to the front of the property.

To the front is a driveway providing parking for several cars leading to the garage.



view this property online allenandharris.co.uk/Property/ABI108333

Please note the marker reflects the postcode not the actual property



Property Ref:
ABI108333 - 0009

1. MONEY LAUNDERING REGULATIONS Intending purchasers will be asked to produce identification documentation at a later stage and we would ask for your co-operation in order that there is no delay in agreeing the sale. 2. These particulars do not constitute part or all of an offer or contract. 3. The measurements indicated are supplied for guidance only and as such must be considered incorrect. Potential buyers are advised to recheck measurements before committing to any expense. 4. We have not tested any apparatus, equipment, fixtures or services and it is in the buyers interest to check the working condition of any appliances. 5. Where an EPC, or a Home Report (Scotland only) is held for this property, it is available for inspection at the branch by appointment. If you require a printed version of a Home Report, you will need to pay a reasonable production charge reflecting printing and other costs. 6. We are not able to offer an opinion either written or verbal on the content of these reports and this must be obtained from your legal representative. 7. Whilst we take care in preparing these reports, a buyer should ensure that his/her legal representative confirms as soon as possible all matters relating to title including the extent and boundaries of the property and other important matters before exchange of contracts.

allen & harris



01235 553777



abingdon@allenandharris.co.uk



1 High Street, ABINGDON, Oxfordshire, OX14 5BD



allenandharris.co.uk