



119 Roebuck Court, Didcot, Oxon, OX11 8US

£1,100 PCM - 3rd August 2026.

- ONE BEDROOM HOUSE
- ALLOCATED PARKING

- FULLY FITTED KITCHEN
- EPC RATING D

- WALKING DISTANCE OF STATION
- COUNCIL TAX BAND B

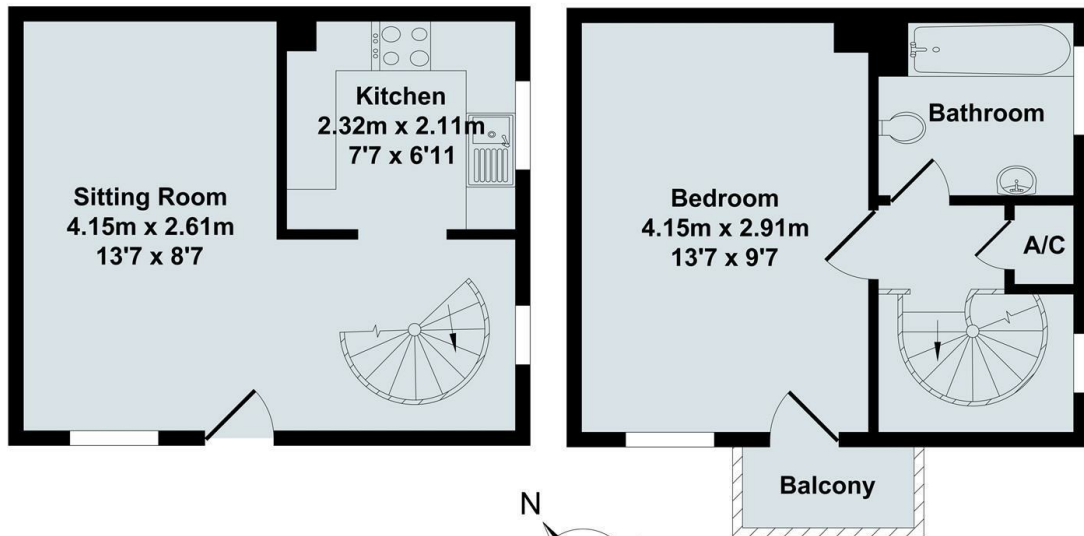

Ground Floor
 Approx. Floor
 Area 20.70 Sq.M.
 (223 Sq.Ft.)

First Floor
 Approx. Floor
 Area 20.70 Sq.M.
 (223 Sq.Ft.)

Total Approx. Floor Area 41.40 Sq.M. (446 Sq.Ft.)

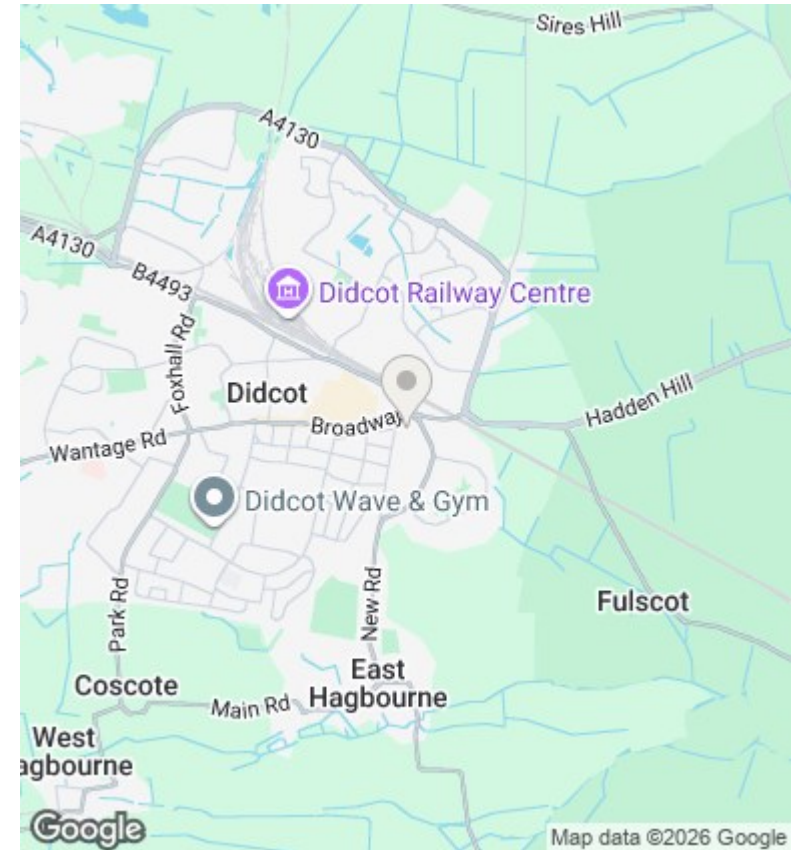

Directions

Viewings

Viewings by arrangement only. Call 01235 514267 to make an appointment.

Council Tax Band

B

EPC Rating:

E

Energy Efficiency Rating		Current	Potential
<i>Very energy efficient - lower running costs</i>			
(92 plus) A			91
(81-91) B			
(69-80) C			
(55-68) D			
(39-54) E		54	
(21-38) F			
(1-20) G			
<i>Not energy efficient - higher running costs</i>			
England & Wales		EU Directive 2002/91/EC	