

# £900 pcm

Meadow Close, Chatteris, Cambridgeshire  
PE16 6PS



To arrange a viewing call us now on 01354 694900

Deposit £1,038

This two bedroom mid terrace property has allocated parking plus a fully enclosed rear garden. The accommodation comprises lounge/diner, kitchen, two bedrooms and bathroom.

Energy rating D.

Available immediately.

Ground Floor

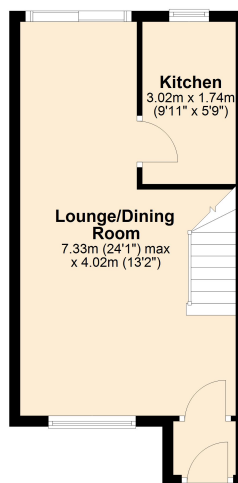

First Floor

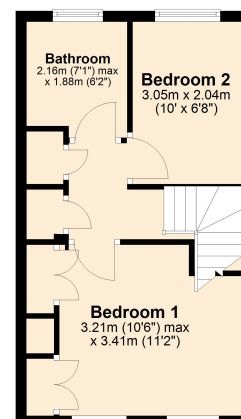

**ellis winters**  
sales & lettings since 2001

# £900 pcm

Meadow Close, Chatteris, Cambridgeshire  
PE16 6PS



## GROUND FLOOR

Lounge/Dining Room  
7.33m (24'1") max. x 4.02m (13'2")

Kitchen  
3.02m (9'11") x 1.74m (5'9")

## FIRST FLOOR

Bedroom 1  
3.41m (11'2") x 3.21m (10'6") max.

Bedroom 2  
3.05m (10') x 2.04m (6'8")

Bathroom  
2.16m (7'1") max. x 1.88m (6'2")



## OUTSIDE

The rear garden is paved for ease of maintenance and there is a garden shed. A rear gate leads to the parking area.



## SERVICES

Mains gas, electricity, water and drainage.  
The property has gas fired central heating.



Fenland District Council tax band A  
Energy rating D



## Tenant Reference and Credit Checks

As part of our standard pre-tenancy process, we carry out credit and reference checks on all prospective tenants. These checks are essential to ensure suitability for the tenancy and are conducted in accordance with relevant data protection laws (GDPR). The cost of these checks is fully covered by Ellis Winters, and no charge is passed on to the applicant.

## Disclaimer

All property details, photographs, floorplans, and other marketing materials produced by Ellis Winters are for general guidance only and do not form part of any contract. While we strive for accuracy, measurements, descriptions, and other information are provided in good faith but should be independently verified. We recommend that prospective tenants conduct their own due diligence before making any decisions.

ellis winters 20 Market Hill, Chatteris, Cambridgeshire, PE16 6BA

Tel: 01354 694900 Email: [info@elliswinters.co.uk](mailto:info@elliswinters.co.uk) [www.elliswinters.co.uk](http://www.elliswinters.co.uk)

**ellis winters**  
sales & lettings since 2001

