

# CHARMILL

RESIDENTIAL



Rotherfield Street, Islington N1

£450



# Rotherfield Street



## Description

A well-presented one bedroom apartment set within a purpose built block in the sought-after area of Islington. The property comprises a reception room with wooden flooring, a separate fully fitted kitchen with modern appliances, a generously sized double bedroom with ample storage, and a family bathroom. Finished to a good standard throughout, the apartment is well located close to transport links, local shops, and green spaces. It is conveniently situated approximately 0.7 miles from Highbury & Islington Underground Station (Victoria Line) and Canonbury Overground Station (Mildmay Line), and 0.8 miles from Haggerston Overground Station (Windrush Line).

- Double bedroom apartment
- Unfurnished
- Ideally located
- One bathroom
- Fully-fitted kitchen
- Wooden flooring throughout





# Floor Plan

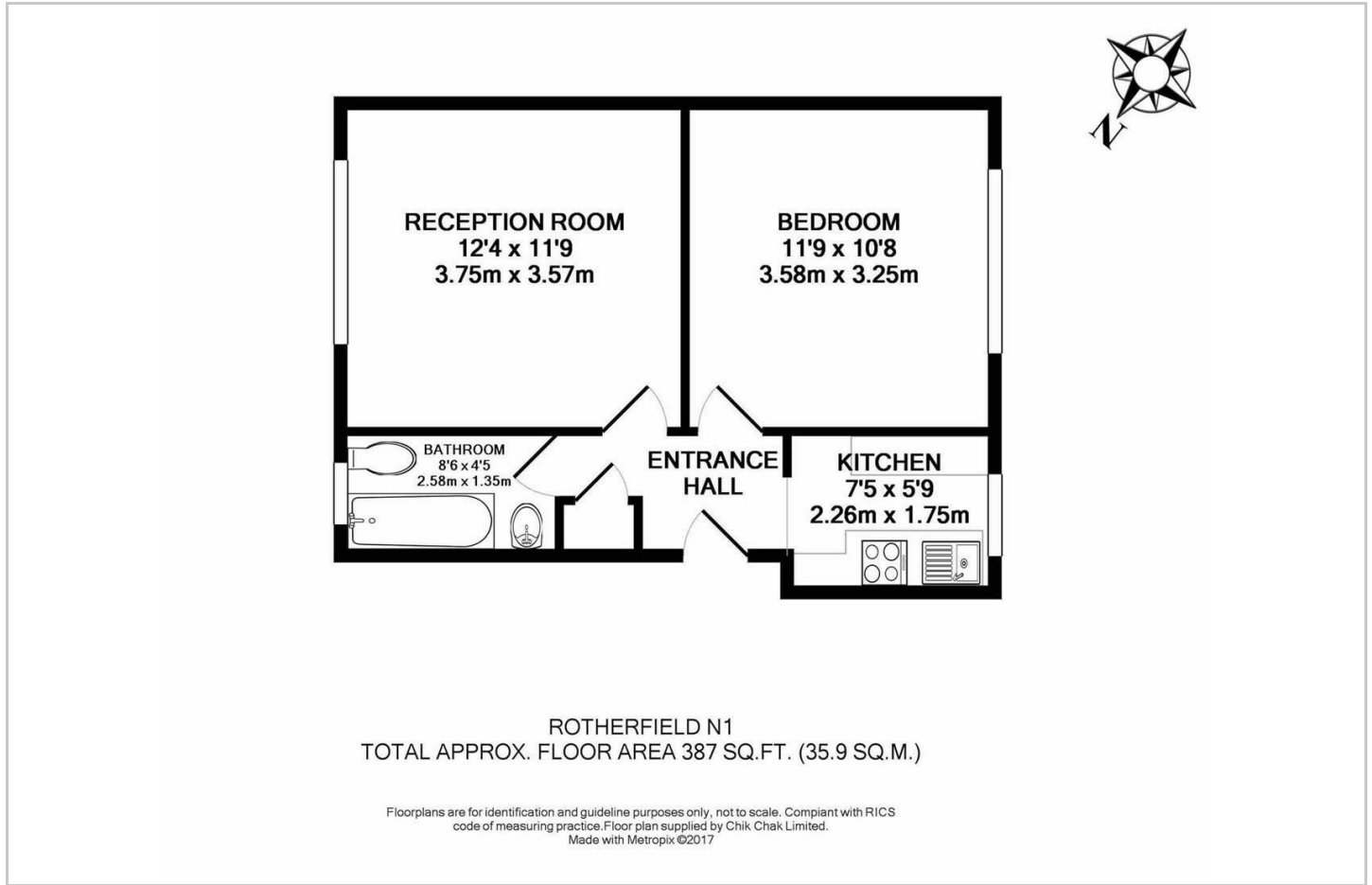

## Area Map

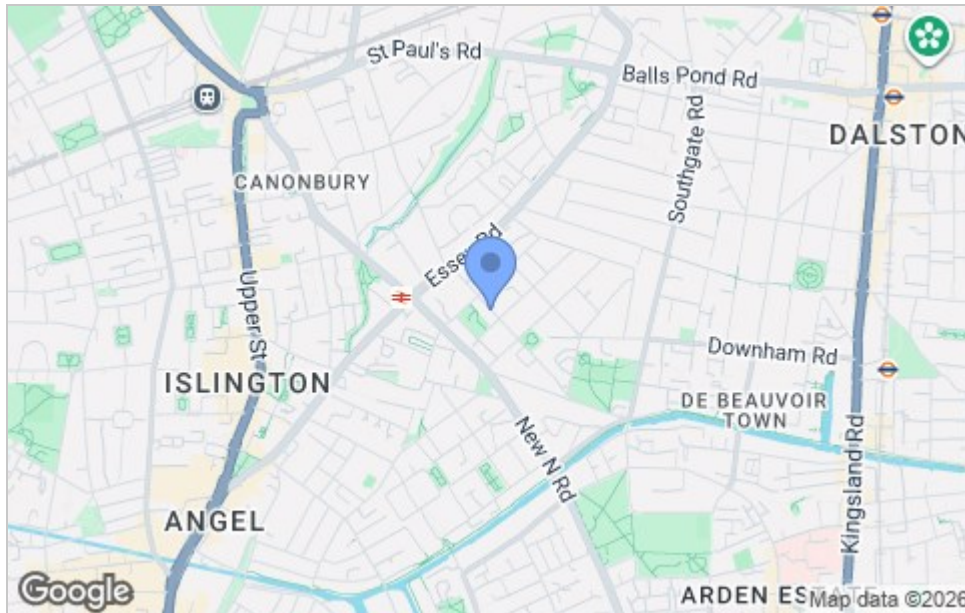

## Energy Efficiency Graph

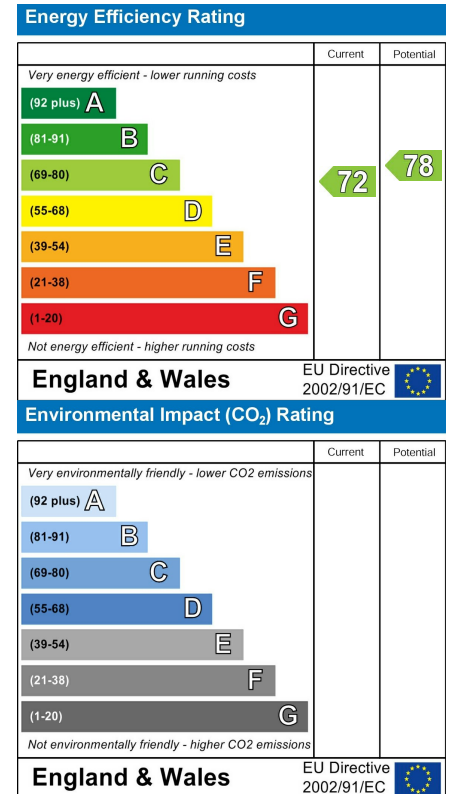

## Viewing

Please contact us on 020 7046 6275 if you wish to arrange a viewing appointment for this property or require further information.



These particulars, whilst believed to be accurate are set out as a general outline only for guidance and do not constitute any part of an offer or contract. Intending purchasers should not rely on them as statements of representation of fact, but must satisfy themselves by inspection or otherwise as to their accuracy. No person in this firm's employment has the authority to make or give any representation or warranty in respect of the property.

020 7046 6275 • sales@charmillresidential.co.uk • 51 Maida Vale, Little Venice, London W9 1SD  
charmillresidential.co.uk