



3 The Paddock Willows Riverside Park, Windsor, Berkshire, SL4 5UU
Offers in excess of £195,000

 **HORLER**

3 The Paddock Willows Riverside Park, Windsor, Berkshire, SL4 5UU

This charming two-bedroom park home located in the Willows, offers a delightful retreat for those aged over 50. Located to the west of Windsor, the property enjoys a picturesque setting on the banks of the River Thames, providing a tranquil atmosphere while remaining conveniently close to local amenities and transport links.

Call today on 01753 621234 to arrange a viewing.



Property Summary

Located on Willows Riverside Park, this charming two-bedroom park home offers a delightful retreat for those aged over 50. Located to the west of Windsor, the property enjoys a picturesque setting on the banks of the River Thames, providing a tranquil atmosphere while remaining conveniently close to local amenities and transport links.

Upon entering, you are welcomed into a dual aspect open plan living and dining room, which is bathed in natural light, creating a warm and inviting space for relaxation and entertaining. The separate kitchen is well-appointed with a range of eye and base level units, complemented by integral appliances that make cooking a pleasure.

The property boasts two generously sized double bedrooms, both featuring fitted wardrobes and ample storage space. The main bedroom benefits from an ensuite shower room, ensuring privacy and convenience, while a separate shower room serves the second bedroom and guests alike.

Outside, the park home is surrounded by a wrap-around south facing garden, offering a paved area to the side and rear, perfect for outdoor dining or simply enjoying the fresh air. A metal shed along the back fence provides additional storage, while the front of the property features hard standing parking for one vehicle and a well-maintained lawn.

This well-presented park home is an ideal choice for those seeking a peaceful lifestyle in a beautiful setting, with the added benefit of being close to the vibrant town of Windsor. Don't miss the opportunity to make this lovely property your new home.

General Information

Council Tax Band 'A'

Over 50s only

No cats or dogs

Pitch Fee /Ground Rent: £265

Double Unit 36' x 20'

Legal Note

Although these particulars are thought to be materially correct their accuracy cannot be guaranteed and they do not form part of any contract





The Paddock SL4

Approximate Gross Internal Floor Area = 65.1 sq m / 700 sq ft

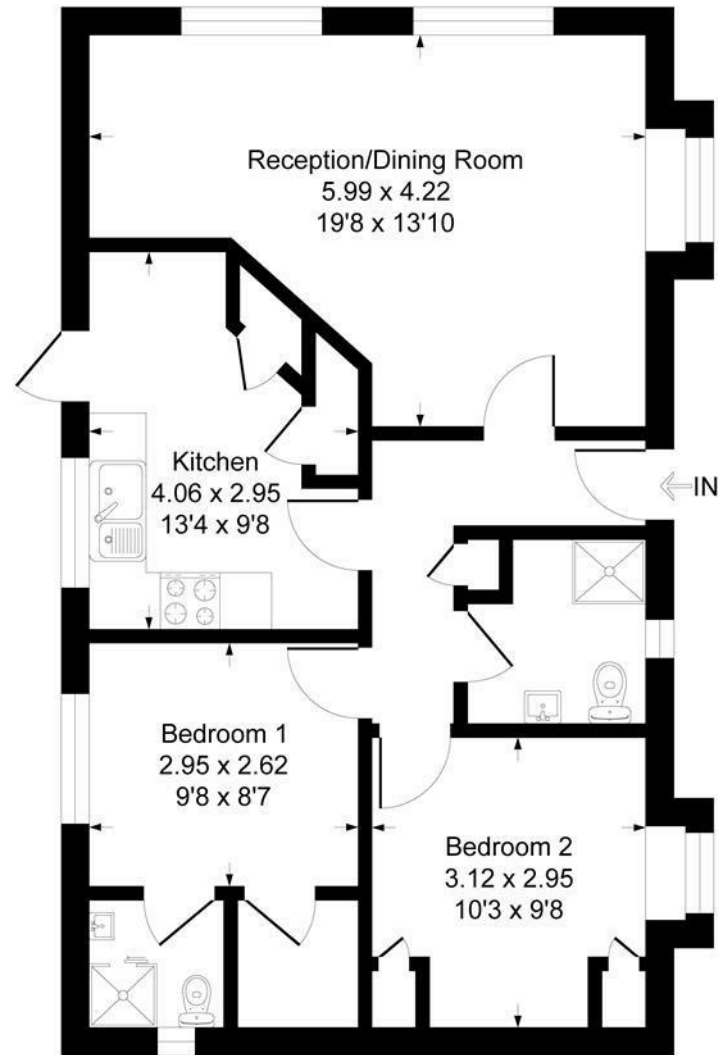

Illustration for identification purposes only, measurements are approximate, not to scale.
Produced By Esjay Property Marketing