

# BRENNAN

BESPOKE

£260,000

Churchill Way

Kettering, NN15 5RT

## PROPERTY SUMMARY

Welcome to this stunning, fully refurbished three-bedroom home, perfectly situated in the heart of Burton Latimer. Every detail has been thoughtfully updated, offering a fresh and modern living space ready for you to move straight in. The ground floor features a welcoming entrance hall leading to a spacious lounge, complete with a stylish media wall, ideal for relaxing with family or entertaining friends. At the rear, the impressive kitchen/dining room is the true heart of the home, providing plenty of space for cooking, dining, and socialising, all finished to a high standard. Upstairs, you'll find three well-proportioned bedrooms, each beautifully presented, along with a stylish family bathroom. Whether you're looking for extra space for guests, a home office, or a growing family, this home offers flexibility to suit your needs. Outside, the property benefits from a private garden, perfect for enjoying the warmer months and convenient parking to the front. There's also a garage and a separate gym area, providing fantastic additional space for storage, hobbies, or fitness. Located close to local amenities, schools, and transport links, this is a rare opportunity to secure a turnkey home in a popular area. Early viewing is highly recommended to appreciate the quality and space on offer.

3



1



1





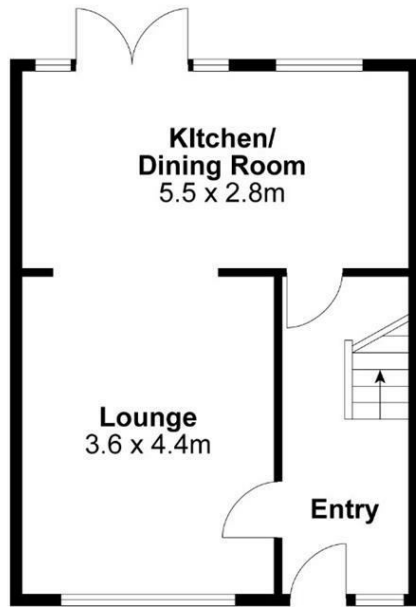

**Ground Floor**

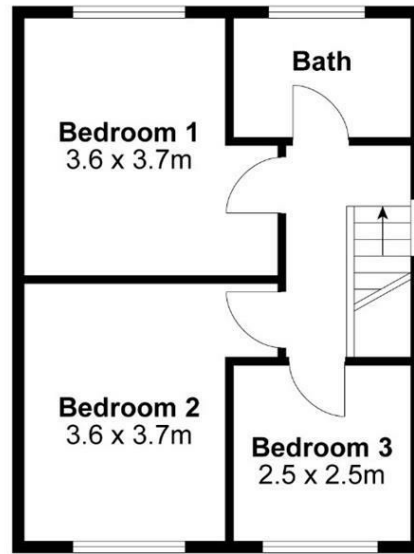

**First Floor**

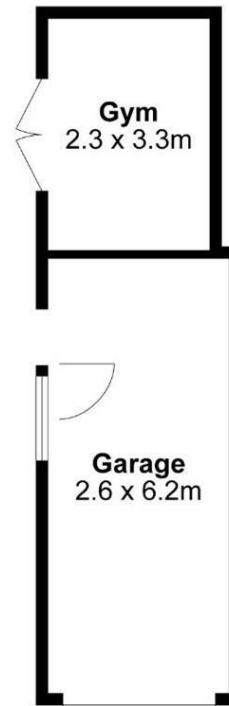

Internal Area Approx. : 105m<sup>2</sup>

**BRENNAN**  
BESPOKE

For identification only not to scale

**LOCAL AUTHORITY**  
North Northamptonshire

**TENURE**  
Freehold

**COUNCIL TAX BAND**  
B

**VIEWINGS**  
By prior appointment only

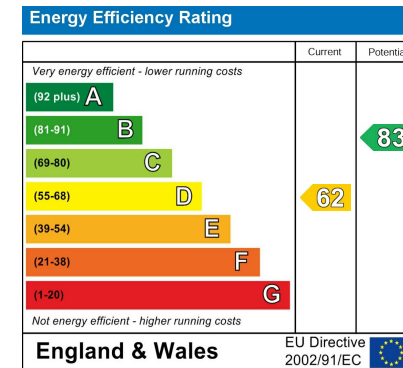

Agents Note: Whilst every care has been taken to prepare these particulars, they are for guidance purposes only. All measurements are approximate and are for general guidance purposes only and whilst every care has been taken to ensure their accuracy, they should not be relied upon and potential buyers/tenants are advised to recheck the measurements

**BRENNAN**  
BESPOKE

**OFFICE ADDRESS**  
BRENNAN BESPOKE  
2 The Tithe Barn Glendon Lodge Farm  
Glendon  
Kettering  
Northamptonshire  
NN14 1QF

**OFFICE DETAILS**  
01536 904400  
info@brennanbespoke.co.uk  
<https://www.brennanbespoke.co.uk>