

SNELLERS

ESTATE AGENTS



The Green, TW2

£1,850 PCM

Ideally located moments from Twickenham Green, this bright and airy one bedroom apartment features a spacious reception room, separate kitchen, and a private terrace overlooking The Green.



The Green is the street adjacent to Twickenham Green and within walking distance to both Twickenham and Strawberry Hill station with direct transport links into Central London. As well as being positioned for easy access to Twickenham's finest schools, Twickenham high street is also nearby with an array of pubs, restaurants, café's and amenities.

- Excellent Location • Private Terrace • Bright and Airy •
- Close to Amenities • Walking Distance to Station • Separate Kitchen •



SNELLERS

ESTATE AGENTS

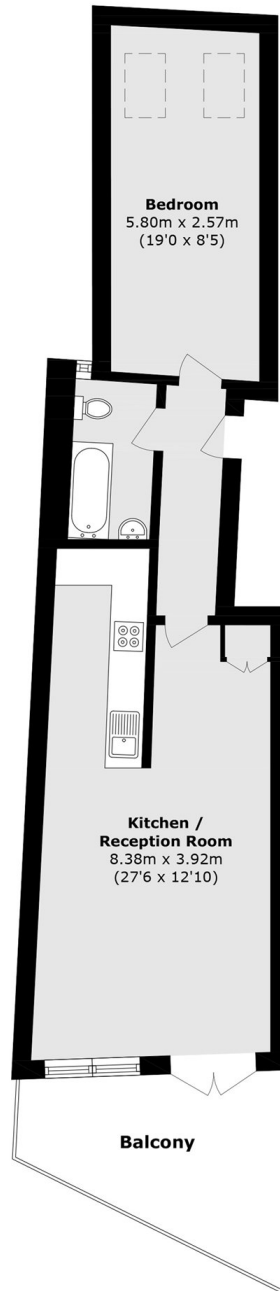

Total area (approx.): 50.9 sq. m (547.8 sq. ft)
Balcony area (approx.): 10.9 sq. m (117.3 sq. ft)

Snellers Twickenham Lettings
64-66 Heath Road
Twickenham
TW1 4BX
020 8892 5678
twickenhamlettings@snellers.co.uk

Energy Rating: We aim to make our particulars both accurate and reliable. However they are not guaranteed; nor do they form part of an offer or contract. If you require clarification on any points then please contact us, especially if you're traveling some distance to view. Please note that appliances and heating systems have not been tested and therefore no warranties can be given as to their good working order