



Montpelier Road, W5

£699,999

A top floor penthouse of a modern boutique development benefiting from around five years remaining on the build warranty. At nearly 1000 sqft there is an open plan living, kitchen and dining area opens onto a wide private terrace with excellent views. There are two double bedrooms, a bathroom, extensive storage and potential to create a third bedroom. Lift access adds further convenience.

Located in a prime Ealing setting, the property is close to well-regarded schools, green open spaces and a wide range of amenities. Ealing Broadway is nearby, providing excellent shopping, dining and superb transport link.

Features

- Penthouse
- Large Terrace
- Modern Finish
- 5 Years Old
- Low Service Charges
- Lift Access

Montpelier Road, London, W5

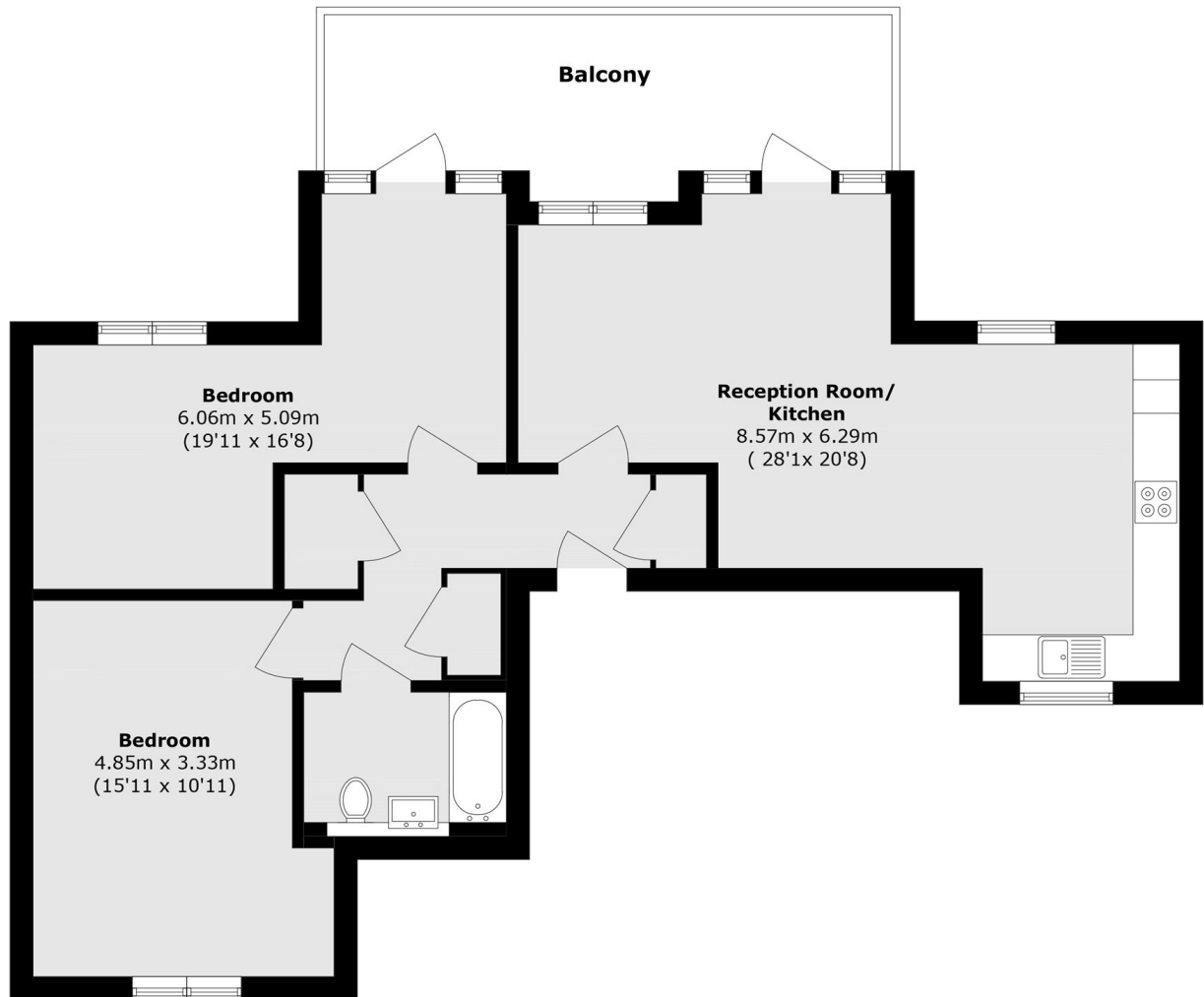

Total area (approx.): 87.7 sq. m (944.0 sq. ft)
Balcony area (approx.): 15.4 sq. m (165.7 sq. ft)