



**Oxford Road  
Cannock**

# Oxford Road Cannock



Lovett&Co. Estate Agents are pleased to offer for sale this beautifully presented, three bedroom semi detached house, overlooking a quiet green to the front and backing onto woodland to the rear.

On the ground floor, the property features a good sized front lounge with feature fireplace and log burner, sizeable inviting entrance hall, modern fitted kitchen-diner along with a convenient guest w/c. Upstairs are three well proportioned bedrooms, landing area and a contemporary fitted family bathroom.

Externally is a generously sized private rear garden which is not overlooked with lawn and patio area. There is also a driveway and car port providing off road parking and a lawn directly in front of the property.

The property is well placed to provide easy access to Cannock & Hednesford town centres, both offering a wide range of amenities with both local & national bus and train services available. The location also benefits from being just a few minutes away from Cannock Chase, an area of outstanding natural beauty. Commuter benefits include A460, A5 and M6 toll road linking the midlands motorway network.

The property benefits from new flooring, re-decoration, UPVC double glazing and central heating through out.

## RECEPTION HALL:

Front entrance door, laminate flooring, ceiling light point, carpeted stairs to first floor accommodation and doors to guest w/c, kitchen-diner and lounge.

## LOUNGE:

3.49m x 4.28m

Feature fireplace with fitted log burner, laminate flooring, coving, TV & phone sockets, ceiling light point and window to front.

## KITCHEN:

5.47m x 3.21m

Range of matching wall and base units incorporating display cabinets and work surfaces, inset bowl sink and drainer with mono tap, integrated oven and 4 ring hob with extractor fan, space for further appliances, two storage cupboards, space for dining table and chairs, door to side of property, window and French doors to rear garden.

## FIRST FLOOR LANDING:

Carpeted flooring, ceiling light point, doors off to three bedrooms, family bathroom and access to loft.

## MASTER BEDROOM:

3.28m x 3.66m

Built in wardrobe, carpeted flooring, radiator, ceiling light point and window to front

## BEDROOM TWO:

3.21m x 3.47m

Built in wardrobe, carpeted flooring, ceiling light point, radiator and window to rear.

## BEDROOM THREE:

2.73m x 2.64m

Carpeted flooring, window to rear, ceiling light points and radiator.

## FAMILY BATHROOM:

White suite comprising: shower cubicle, cabinet wash hand basin,, W/C, wall tiling, vinyl flooring, ceiling spot lights and window to front.

## VIEWING:

Please contact us on 01543 889410 if you would like to arrange a viewing appointment for this property or require further information.





Identification Checks (R) - Should a purchaser(s) have an offer accepted on a property marketed by Lovett&Co Estate Agents they will need to undertake an identification check. This is done to meet our obligation under Anti Money Laundering Regulations (AML) and is a legal requirement. We use a specialist third party service to verify your identity. The cost of these checks is £35.00 inc. VAT per buyer, when an offer is agreed and prior to a sales memorandum being issued. This charge is non-refundable.

**DISCLAIMER:**  
These particulars are set up as a general outline only for the guidance of intending purchasers or lessees, and do not constitute part of an offer or contract.

The sellers has given permission for all descriptions, dimensions, references to conditions, tenure, service charges and necessary permissions for use, occupation and other details to be used and we have taken them in good faith whether included or not & whilst we believe them to be correct, any intending purchasers or tenants should not rely on them as representations or fact but must satisfy themselves by inspection or otherwise as to the correctness of each of them and have this certified during the conveyancing by their solicitor. No person in the employment of Lovett&Co has any authority to make or give any representation or warranty whatsoever in relation to this property.

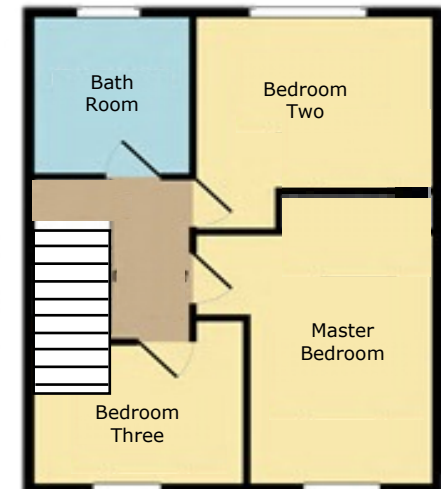
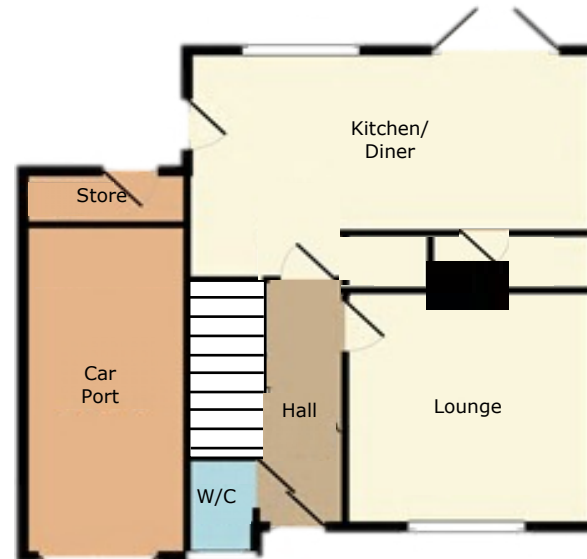

FOR ILLUSTRATIVE PURPOSES ONLY, NOT TO SCALE

