

Scott Avenue, SW15

£575,000

A stunning two bedroom, two bathroom flat in a highly desirable modern development close to East Putney and Southfields tube stations and Putney mainline station. The flat has a 999 year lease, secure underground parking, and access to a private residents-only gym and library.

Repton House is within a 10 minute walk of both East Putney and Southfields. There are well-kept communal gardens surrounding the building and Wimbledon Park, Wimbledon Common and Wandsworth Park are all close by.

Features

- Two Bedrooms
- Two Bathrooms
- Parking
- 999 Year Lease
- Gym & Library
- Balcony

Scott Avenue, London, SW15

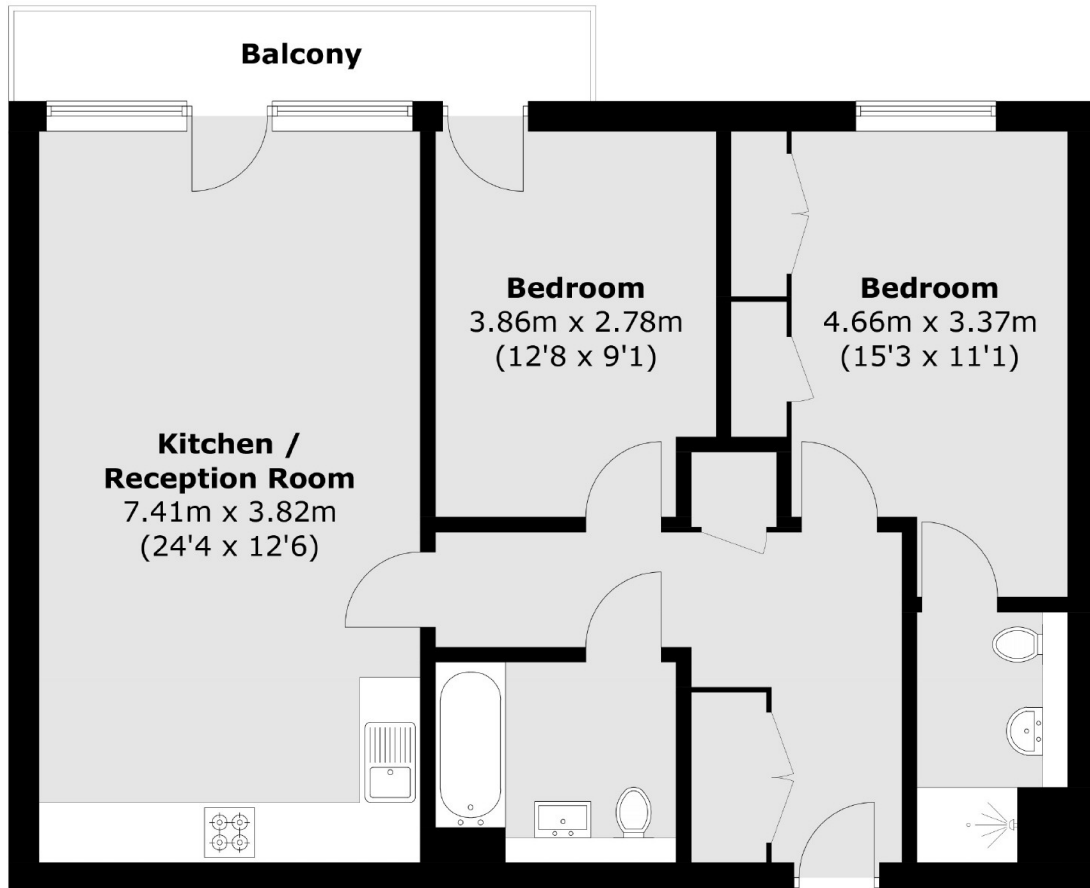

Total area (approx.): 75.2 sq. m (809.4 sq. ft)
Balcony: 5.2 sq. m (56.0 sq. ft)