

Towers Wills

Town & Country

📞 01935 577 032 | 01460 298 530 | ✉ info@towerswills.co.uk



1, Hillborne Gardens, Yeovil, Somerset BA21 3SA

Offers Over **£290,000**

Towers Wills welcome to the market this well-presented detached property in the popular Abbey Manor Park. Briefly comprising hall, lounge, kitchen, dining room, three bedrooms, bathroom, front and rear gardens, off road parking and garage. Priced for immediate interest and early viewing is advised.

Entrance door leading into the hall.

WC 1.06m x 1.07m

Fitted with WC, wash hand basin, radiator and window with outlook to the side.

Kitchen 2.35m x 3.27m

Fitted with patterned worktops and timber effect doors with a range of wall and base units. A stainless-steel sink drainer unit with mixer tap, a four ring gas hob with oven under, extractor over, space for fridge/freezer, plumbing for washing machine, central heating boiler, part tiled walls, serving hatch and windows with outlook to the front and rear.

Lounge 4.57m x 4.92m

A good size lounge with window outlook to the side, radiator, stairs to first floor landing and small window with outlook to the front.

Dining Room 2.52m x 2.88m

With patio doors leading out to the rear, serving hatch from the kitchen and radiator.

Landing

With window outlook to the front and hatch to roof space.

Bedroom One 2.71m x 3.85m

With window outlook to the rear and radiator.

Bedroom Two 2.22m x 2.57m

With window outlook to the side and radiator.

Bedroom Three 2.11m x 2.16m

With window outlook to the front and radiator.

Bathroom 1.70m x 2.55m maximum measurements

A white suite with panel bath, shower over, mixer tap, WC, pedestal hand basin mixer tap, heated towel rail, built in cupboard and window with outlook to the side.

Gardens

To the front and side there is a lawned area whilst to the rear the garden is low maintenance with patio area, lawn and mature shrubs and benefits from a gate leading out to the front and outside water tap.

Parking

A drive provides off road parking and in turn leads into the garage.

Garage 2.47m x 5.47m

With up and over door, light and power connected and door leading out to the rear garden.

Key Features

- Detached
- Three bedrooms
- Well presented
- Desirable Abbey Manor Park
- Off road parking and garage

Contact Us

Towers Wills Estate Agents - Yeovil

114, Hendford Hill

Yeovil

Somerset

BA202RF

T: 01935 577032

E: info@towerswills.co.uk

Energy Efficiency

Score	Energy rating	Current	Potential
92+	A		
81-91	B		84 B
69-80	C	69 C	
55-68	D		
39-54	E		
21-38	F		
1-20	G		



Floor Plan

GROUND FLOOR

1ST FLOOR

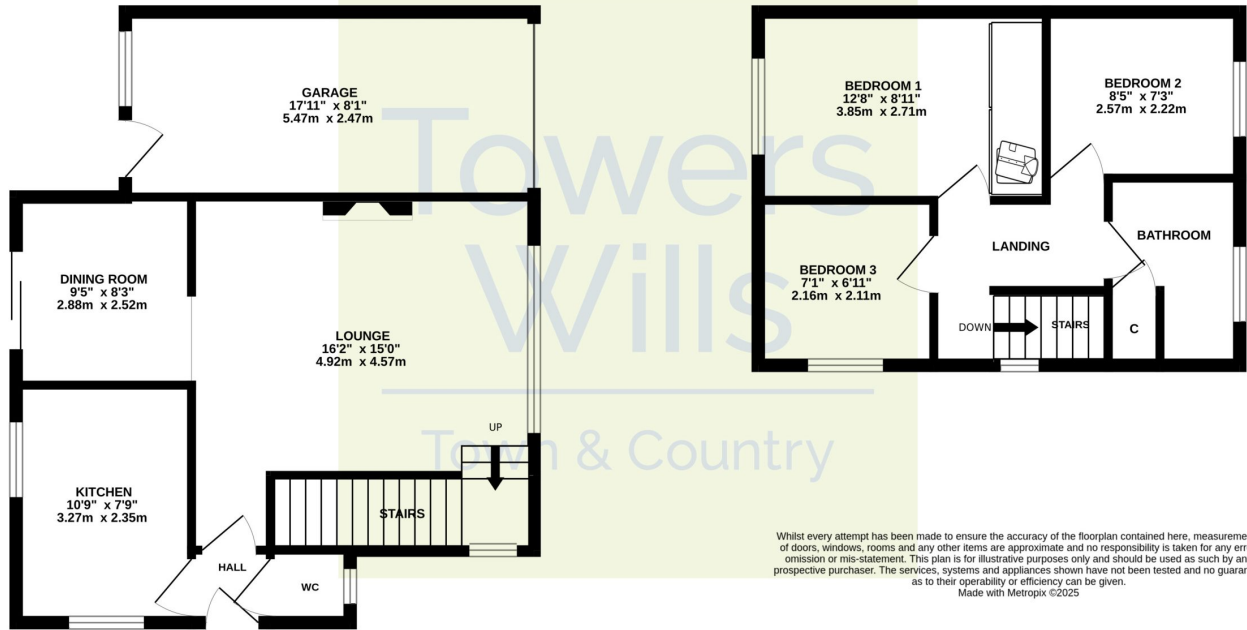

Please Note No tests have been undertaken of any of the services and any intending purchasers should satisfy themselves in this regard. Towers Wills Ltd for themselves and for the vendor of this property whose agents they are, give notice that, (i) these particulars do not constitute any part of an offer or contract, (ii) all statements contained within these particulars are made without responsibility on the part of Towers Wills or the vendor, (iii) whilst made in good faith, none of the statements contained within these particulars are to be relied upon as a statement of representation or fact, (iv) any intending purchaser must satisfy him/herself by inspection or otherwise as to the correctness of each of the statements contained within these particulars, (v) the vendor does not make or give either Towers Wills or any person in their employment any authority to make or give representation or warranty whatsoever in relation to this property.

Photographs / Floor Plans Photographs are reproduced for general information and it must not be inferred that any item is included for sale with this property. Please note floor plans are not to scale and are for identification purposes only. The photographs used in these particulars may have been taken with the use of a wide angle lens. If you have any queries as to the size of the accommodation or plot, please address these with the agent prior to making an appointment to view