



## Price

£1,400 PCM

Fees Apply



Available 31/03/26

High Street Snodland  
ME6

*Wards*

Helping you move forwards



## Main Features

Large Three Bedroom Maisonette

Great Central Location

Kitchen Appliances

Freshly Decorated & New Carpets

Gas Central Heating

Set over Three Floors



Deposit required is £1,615.38

Tonbridge and Malling District - Council Tax Band Tax Band B

Renting a property is a big commitment and we recommend that you visit the local authority website and these websites which offer helpful information and advice about letting

[www.gov.uk/government/publications/how-to-rent](http://www.gov.uk/government/publications/how-to-rent)

[www.gov.uk/private-renting](http://www.gov.uk/private-renting)

[www.wardsofkent.co.uk/renting/tenancy-fees-individuals/](http://www.wardsofkent.co.uk/renting/tenancy-fees-individuals/)

[www.gov.uk/green-deal-energy-saving-measures](http://www.gov.uk/green-deal-energy-saving-measures)

Call Maidstone 01622 675064 ■ [wardsofkent.co.uk](http://wardsofkent.co.uk)

IMPORTANT INFORMATION: Please contact our Lettings Team who will confirm the total costs involved in renting this property. For clarification, we wish to inform the prospective tenant that we have prepared these details as a general guide. The agent has not carried out a detailed survey nor tested the services, appliances, or specific fittings (unless otherwise stated), and no warranty can be given as to their condition. All room measurements are taken at floor level. We strongly recommend that all the information which we provide about the property is verified by yourself and your advisers. The contents of this publication are © Wards, 2015. Wards is a trading name of Arun Estates Limited Registered in England No. 2597969

## Accommodation

Entrance Porch

Stairs & 1st Landing

Kitchen/Living Area 6.57x3.57

Bedroom 1 6.57x4.80

Bathroom 2.60x1.86

Stairs & 2nd Landing

Bedroom 2 4.80x3.61

Bedroom 3 4.80x5.30



**First Floor**



**Second Floor**

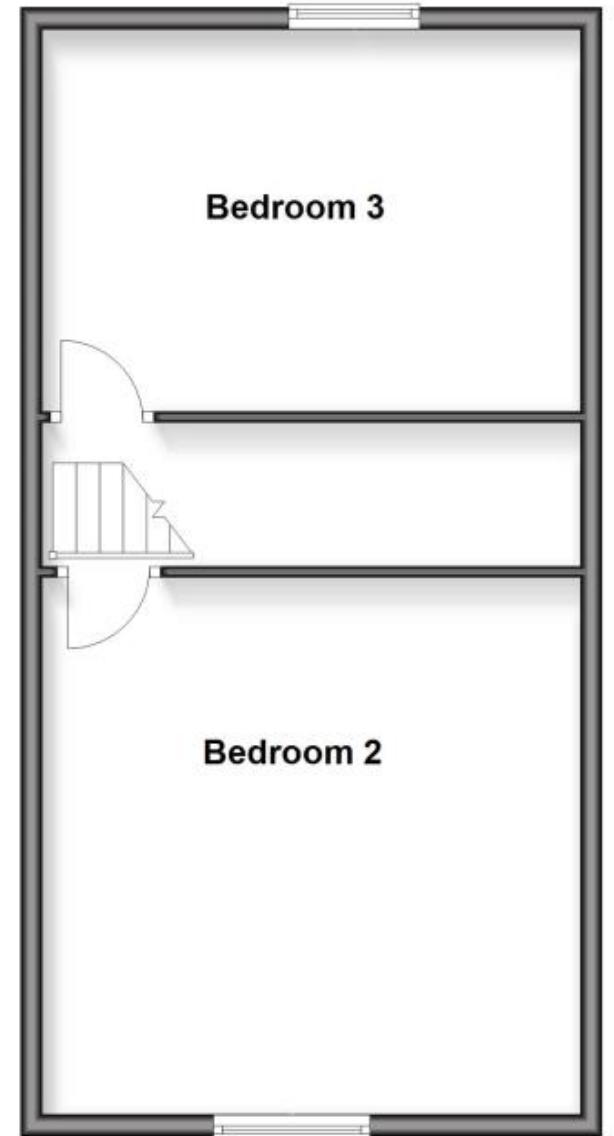

**Ground Floor**

