

To Let - Alexandra Mews, Ormskirk, L39 **£875.00PCM**



KEY FEATURES:

- Top Floor Apartment • Two Bedrooms • Ormskirk Location • Close to Transport Links and Local Amenities • Convenient Off Road Parking • Immediate Availability • Neutrally Decorated Throughout • Three Piece Bathroom •

naea | propertymark

PROTECTED

Sales

T: 01704 550048

E: sales@ajestateagents.co.uk

arla | propertymark

PROTECTED

Rentals

T: 01704 543434

E: rentals@ajestateagents.co.uk

Property Management

T: 01704 545800

E: pm@ajestateagents.co.uk



The Property Ombudsman

Property Description

Anthony James are delighted to present to the rental market this ideally located top-floor apartment in the heart of Ormskirk. Beautifully modernised throughout, this impressive two-bedroom apartment offers modern living in a highly sought-after location.

Recently redecorated, the property features a newly fitted kitchen and a stylish three-piece bathroom, creating a fresh and contemporary finish. Both bedrooms are well-proportioned and benefit from built-in storage, while the bright and spacious living area further enhances the apartment's appeal. Recently installed electric radiators and sleek modern finishes ensure the property is both comfortable and energy efficient.

Conveniently situated close to local amenities, this stunning apartment is perfect for those seeking both style and convenience.

Available immediately, subject to satisfactory checks.

EPC Rating: D Council Tax Band: B

Please note, this property is managed by the landlord's agent.



Rooms

Hallway

Step into a bright and inviting hallway that seamlessly blends modern elegance with practicality. The sleek laminate flooring extends throughout, providing a stylish and low-maintenance foundation. Crisp white walls enhance the sense of space, while a contemporary pendant light casts a warm, welcoming glow. The hallway is fitted with a secure intercom system for added peace of mind, and the door frames, painted in a striking dark grey, add a touch of sophistication. Recently installed electric radiators ensure a comfortable and energy-efficient environment year-round.

Living Room

Step into a beautifully refreshed living room that exudes modern charm and comfort. Soft, fitted carpets provide warmth underfoot, complementing the fresh white décor that enhances the sense of space and light. The striking dark grey door frame and skirting add a bold, contemporary touch, creating a stylish contrast. A large front-facing window allows natural light to flood the room, making it feel bright and airy, while a fitted curtain pole is ready for your choice of window dressings. A sleek, recently installed electric radiator ensures warmth and efficiency, and a pendant light completes the space with a soft, ambient glow—perfect for both relaxing and entertaining.

naea | propertymark

PROTECTED

Sales

T: 01704 550048

E: sales@ajestateagents.co.uk

arla | propertymark

PROTECTED

Rentals

T: 01704 543434

E: rentals@ajestateagents.co.uk

Property Management

T: 01704 545800

E: pm@ajestateagents.co.uk



The Property Ombudsman

Kitchen

This newly fitted kitchen is a perfect blend of modern style and practicality. Sleek wall and base units provide ample storage, ensuring a clutter-free cooking space. The elegant black single-bowl sink with a matching drainer sits beneath a well-placed window, allowing natural light to brighten the workspace. A built-in electric hob and oven offer convenience for home cooking, while a washing machine for added functionality. The crisp white painted walls create a fresh, clean aesthetic, complemented by stylish grey tiles in wet areas for a contemporary touch. Durable laminate flooring runs throughout, adding both warmth and easy maintenance. A handy pantry provides additional storage, perfect for keeping essentials neatly tucked away. This kitchen is designed for both style and efficiency, making it an inviting space to cook and entertain.



Bedroom 1

This beautifully refreshed master bedroom offers a perfect blend of modern elegance and comfort. Freshly decorated in crisp white, the walls create a bright and airy feel, while the dark grey door frame and skirting add a bold, sophisticated contrast. Plush fitted carpeting enhances warmth and coziness underfoot, making the space feel inviting and luxurious. Built-in wardrobes provide ample storage, ensuring a sleek and clutter-free environment. A striking chandelier-style light fitting adds a touch of charm and character to the room. Natural light pours in through the window, illuminating the space, with a newly installed electric radiator positioned below to provide efficient warmth and comfort year-round. This stylish and serene retreat is perfect for relaxation.



Bathroom

This newly fitted three-piece bathroom offers a perfect blend of style and functionality. Designed with a modern touch, it features a luxurious bathtub with a sleek glass shower screen and an electric shower, providing both convenience and comfort. The contemporary sink unit and toilet complement the space beautifully, enhancing the clean and sophisticated look. Crisp white tiles in the wet areas create a fresh, polished feel, while the white painted walls maintain a bright and airy atmosphere. Durable laminate flooring adds warmth and practicality, ensuring easy maintenance. A stylish ladder-style electric radiator not only provides efficient heating but also offers a convenient space to keep towels warm. Whether you're unwinding with a relaxing soak or enjoying an invigorating shower, this elegant bathroom is designed for comfort and style.



Bedroom 2

This beautifully refreshed bedroom offers a stylish and comfortable retreat. Decorated in crisp white, the walls create a bright and airy feel, while the dark grey doorframes and skirtings add a sophisticated contrast. Soft fitted carpeting enhances the warmth and coziness of the space, making it an inviting place to relax. The room features a convenient integral wardrobe, providing ample storage while maintaining a sleek, uncluttered look. A window allows natural light to flow in, complete with a fitted curtain pole for your choice of window dressings. Below, a recently installed electric radiator ensures warmth and efficiency year-round. Overhead, a classic pendant light fixture adds a soft, ambient glow, completing the room's elegant and modern aesthetic.



Sales

T: 01704 550048

E: sales@ajestateagents.co.uk



Rentals

T: 01704 543434

E: rentals@ajestateagents.co.uk

Property Management

T: 01704 545800

E: pm@ajestateagents.co.uk



The Property Ombudsman

First Floor

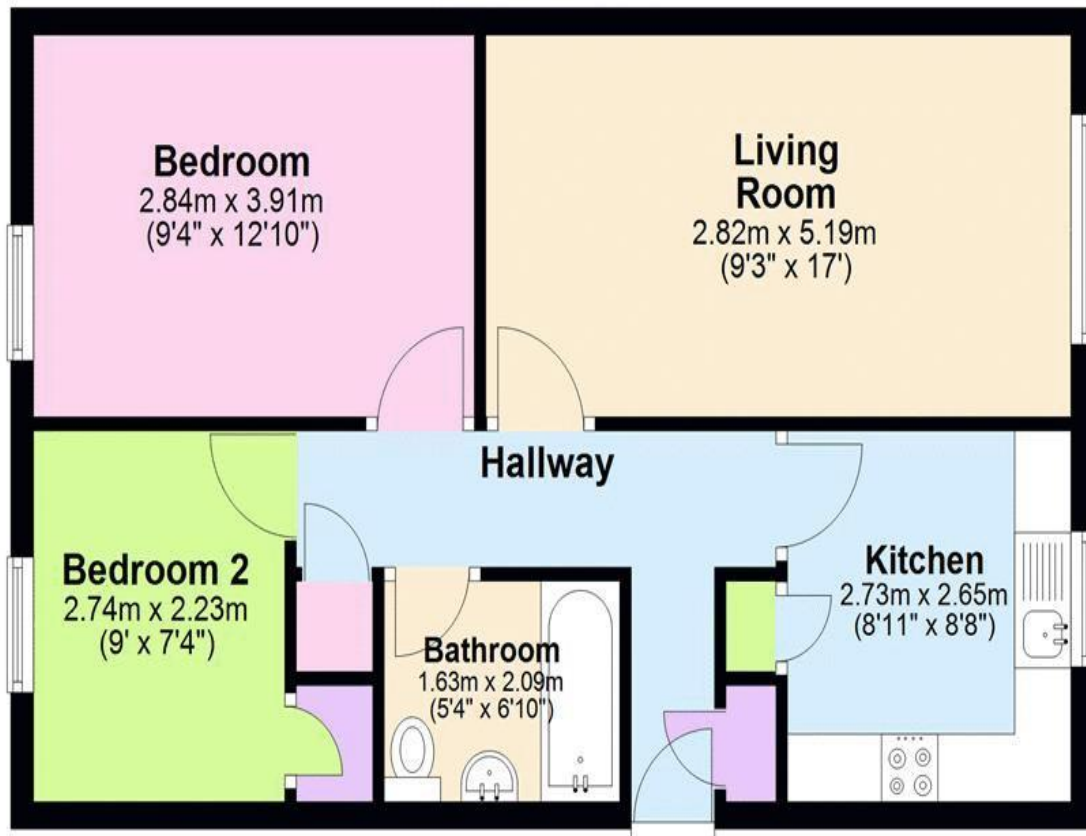

"Whilst every attempt has been made to ensure the accuracy of the floor plan contained here, measurements of doors, windows, rooms and any other item are approximate and no responsibility is taken for any error, omission, or misstatement. This plan is for illustrative purposes only and should only be used as such by any prospective purchaser.

Plan produced using PlanUp.

Additional Information

EPC: D

Council Tax Band: B

Tenure: Leasehold

Score	Energy rating	Current	Potential
92+	A		
81-91	B		
69-80	C		80 C
55-68	D	67 D	
39-54	E		
21-38	F		
1-20	G		

Disclaimer: Interested parties should satisfy themselves, by inspection or otherwise as to the accuracy of the description given and any floor plans shown in these property details. All measurements, distances and areas listed are approximate. Fixtures, fittings and other items are NOT included unless specified in these details. Please note that any services, heating systems, or appliances have not been tested and no warranty can be given or implied as to their working order. **For detailed information on tenant fees, please visit our website at www.ajestateagents.co.uk and navigate to Services > Lettings > Tenant Fees.**



Sales

T: 01704 550048

E: sales@ajestateagents.co.uk



Rentals

T: 01704 543434

E: rentals@ajestateagents.co.uk

Property Management

T: 01704 545800

E: pm@ajestateagents.co.uk



The Property Ombudsman



Sales

T: 01704 550048

E: sales@ajestateagents.co.uk



Rentals

T: 01704 543434

E: rentals@ajestateagents.co.uk



Property Management

T: 01704 545800

E: pm@ajestateagents.co.uk



The Property Ombudsman