

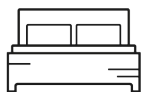

81 Black Prince Road

2



1



1

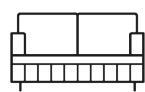

**£640 Per week**

Apartment - Furnished

Size - 810.00 sq ft

Deposit - £3,200

Available - 10th November 2025

Council Tax Band - E

# 81 Black Prince Road, London, SE1 7ET

## £640 Per week

Large and spacious two-bedroom apartment is now available to rent. This bright apartment further benefits from its own private balcony, a concierge, private residents' gymnasium, cycle storage and communal roof terrace. The property comprises an open plan reception with modern integrated kitchen, double bedrooms and luxury bathroom.

Located in central London and within walking distance of the South bank with a variety of lovely restaurants, Borough Market, and unique shopping experiences. Parliament House is also well connected with Waterloo, Westminster and Vauxhall and Nine Elms underground stations.  
\*\*The beds have been digitally dressed for marketing purposes.

Council Tax Band: Lambeth- E  
Minimum contract: 12 months  
Change of contract fee: £50 including VAT  
Lift access / EWS1: Ask Agent  
Holding Deposit - £640 (1 weeks rent, subject to agreed offer)

To check broadband and mobile phone coverage please visit Ofcom.  
To check planning permission please visit Lambeth Council Website, Planning & Building Control

### Floorplan

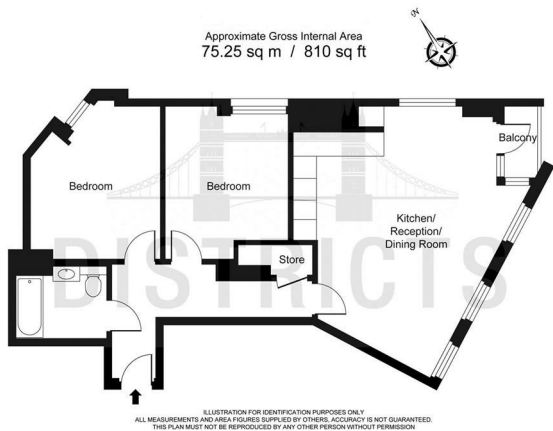

### Key Information

- Open Plan Reception with Smart Integrated Kitchen / Dining
- Two Double Bedrooms
- Luxury Family Bathroom
- Balcony
- Cycle Storage
- Exclusive Residents Gym
- Concierge
- Moments From Westminster, Vauxhall and Nine Elms Underground Stations

### EPC CERTIFICATE

Energy Efficiency Rating		Current	Potential
Very energy efficient - lower running costs			
(92 plus) A			
(81-91) B			
(69-80) C			
(55-68) D			
(39-54) E			
(21-38) F			
(1-20) G			
Not energy efficient - higher running costs			
England & Wales		EU Directive 2002/91/EC	

Environmental Impact (CO <sub>2</sub> ) Rating		Current	Potential
Very environmentally friendly - lower CO <sub>2</sub> emissions			
(92 plus) A			
(81-91) B			
(69-80) C			
(55-68) D			
(39-54) E			
(21-38) F			
(1-20) G			
Not environmentally friendly - higher CO <sub>2</sub> emissions			
England & Wales		EU Directive 2002/91/EC	

