



---

70B BRISTOL RD

PORTISHEAD  
BS20 6QG

# 70B BRISTOL RD

PORTISHEAD BS20 6QG







**Ground Floor**  
Approx. 41.2 sq. metres (443.7 sq. feet)

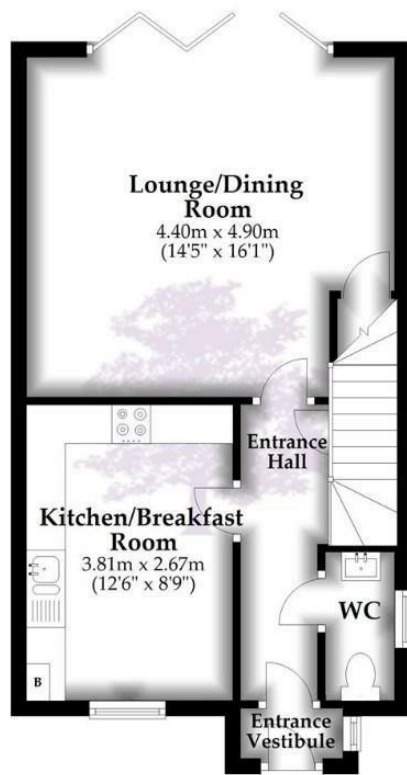

**First Floor**  
Approx. 41.3 sq. metres (444.1 sq. feet)

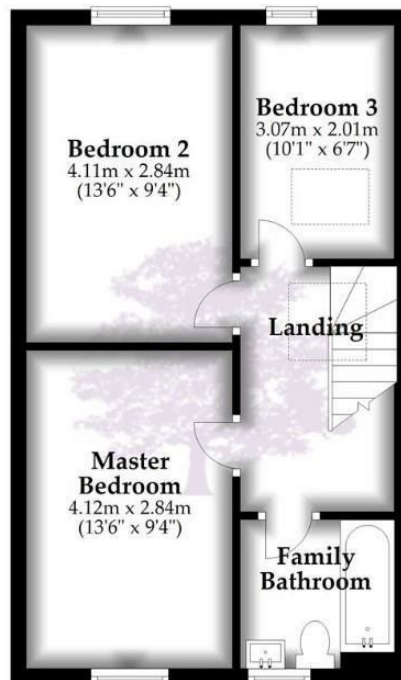

Total area: approx. 82.5 sq. metres (887.8 sq. feet)

3 BEDROOMS  
TENURE -

- Lower Portishead
- Unfurnished Property
- Sorry, No Smokers
- Driveway Parking Available
  - 1 Bathroom

1 RECEPTION ROOMS  
IN ALL SQ.FT

1 BATHROOMS  
COUNCIL TAX BAND - D

- House
- Gas C/H
- Medium Sized Garden
- 3 Bedrooms

**GOODMAN & LILLEY  
BRANCH NETWORK**

**HENLEAZE**

156 Henleaze Road  
Henleaze  
BS9 4NB  
0117 213 0777  
henleaze@goodmanlilley.co.uk

**SHIREHAMPTON**

9 HIGH STREET  
SHIREHAMPTON  
BS11 0DT  
0117 213 0333  
SHIRE@GOODMANLILLEY.CO.UK

**PORTISHEAD**

Rembrandt House  
36 High Street] Portishead  
BS20 6EN  
01275 430440  
sales@goodmanlilley.co.uk

**LETTINGS**

01275 299010  
LETTINGS@GOODMANLILLEY.CO.UK

**CLEVEDON**

28 Hill Road  
Clevedon  
BS21 7PH  
01275 403 660  
clevedon@goodmanlilley.co.uk

**LAND & NEW HOMES**

0117 213 0151  
LNH@GOODMANLILLEY.CO.UK

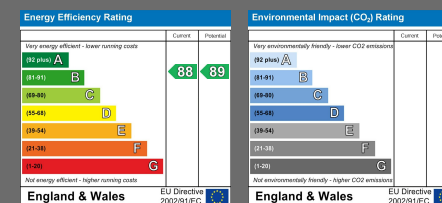

Opening hours vary slightly in each office  
Mon to Fri - Usually 9am till 6pm  
Saturday 9.00am-4.00pm