

Simon Road, Hollywood, Birmingham, B47 5LH

Offers In Region Of £425,000

3 1 2



3-Bed Semi-Detached Home in Hollywood with Open-Plan Living, Conservatory and Office Space

Key Features

- Three-bedroom Semi-detached family home
- Spacious lounge opening into a bright conservatory
- Well-appointed kitchen plus large office room
- Versatile bedroom sizes suitable for family or home office use
- Private rear garden accessed via conservatory
- Sought-after, peaceful Hollywood location
- Formal dining room with bay window
- Utility to the side
- Excellent transport links including local rail stations
- Close to reputable schools, shops, and green spaces

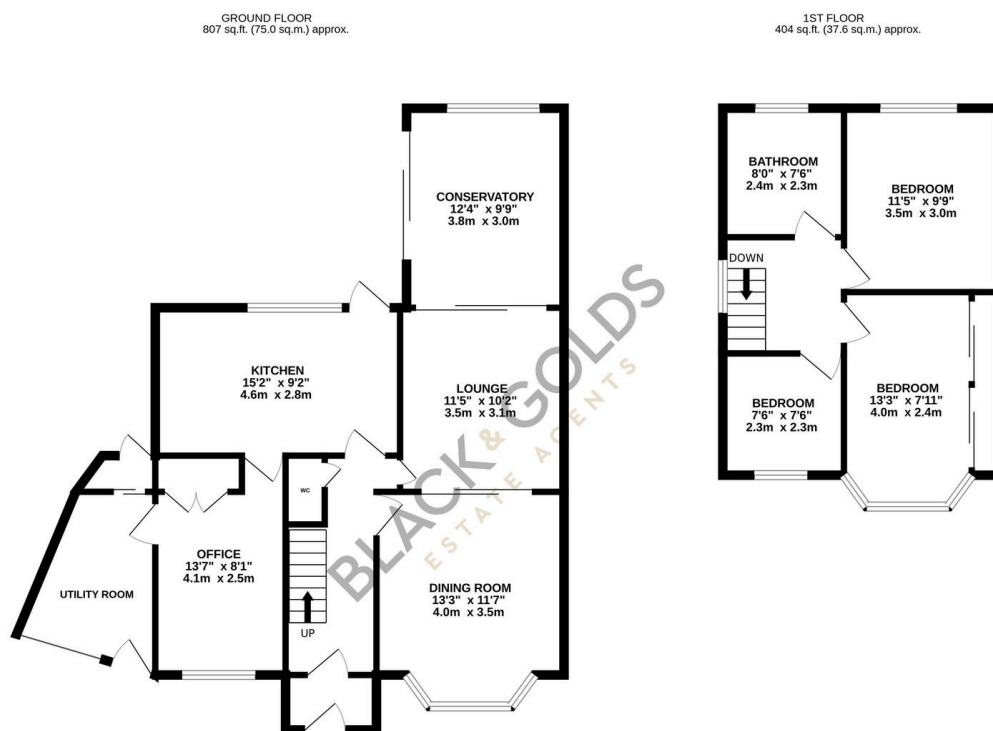

TOTAL FLOOR AREA: 1211 sq.ft. (112.5 sq.m.) approx.

Whilst every attempt has been made to ensure the accuracy of the floorplan contained here, measurements of doors, windows, rooms and any other items are approximate and no responsibility is taken for any error, omission or mis-statement. This plan is for illustrative purposes only and should be used as such by any prospective purchaser. The services, systems and appliances shown have not been tested and no guarantee as to their operability or efficiency can be given.

Made with Metropix ©2026