

Graham Road, Halesowen, B62 8LJ

£239,950

🛏 2 🚿 1 🚗 1



A Beautifully Presented Two Bedroom Semi-Detached Home with Stylish Modern Living Spaces

Key Features

- NO UPWARD CHAIN
- Highly Sought After Area
- Spacious Reception Room with Bay Window
- Private Rear Garden
- Freshly Renovated
- Modern Fitted Kitchen
- Contemporary Family Bathroom
- Spacious Driveway

GROUND FLOOR
411 sq.ft. (38.2 sq.m.) approx.

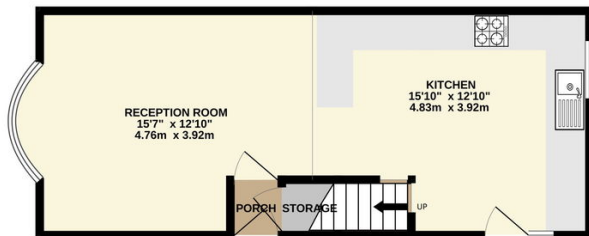

1ST FLOOR
332 sq.ft. (30.8 sq.m.) approx.

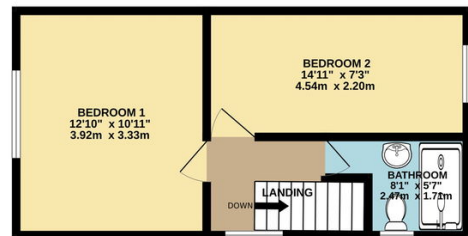

TOTAL FLOOR AREA : 743 sq.ft. (69.0 sq.m.) approx.

Whilst every attempt has been made to ensure the accuracy of the floorplan contained here, measurements of doors, windows, rooms and any other items are approximate and no responsibility is taken for any error, omission or mis-statement. This plan is for illustrative purposes only and should be used as such by any prospective purchaser. The services, systems and appliances shown have not been tested and no guarantee as to their operability or efficiency can be given.
Made with Metropix ©2025