



Stoneacre
Properties



Woodlands Way, Leeds, LS14 2EY

£220,000

Offered to the market is this three bedroom mid terrace town house located on Woodlands Way, Leeds. The property is situated in a sought after location close to all local amenities including: shops, schools and transport links. The property briefly comprises of: entrance hall way, kitchen, lounge, guest w.c, first floor landing, two bedrooms, family bathroom, second floor landing, master bedroom. Externally the property benefits from grass laid to lawn to the front and rear elevation. This property is not one to be missed to make this house your home please contact the office today to arrange your viewing.

ENTRANCE HALL WAY

Door to the front elevation. Stairs leading to first floor landing.

LOUNGE



French door leading to the rear garden. Central heating radiator.

KITCHEN



Range of wall and base units. Sink and drainer. Space for fridge freezer. Plumbing for washing machine. Breakfast bar area. Door off leading to guest w.c.

GUEST W.C



Low flush w.c. Wash hand basin. Central heating radiator.

FIRST FLOOR LANDING

BEDROOM TWO



Double glazed window to the rear elevation. Central heating radiator.

BEDROOM THREE



Two double glazed windows to the front elevation. Central heating radiator.

BATHROOM



Bath with shower above. Low flush w.c. Hand basin. Central heating radiator.

SECOND FLOOR LANDING

Storage cupboard.

BEDROOM ONE

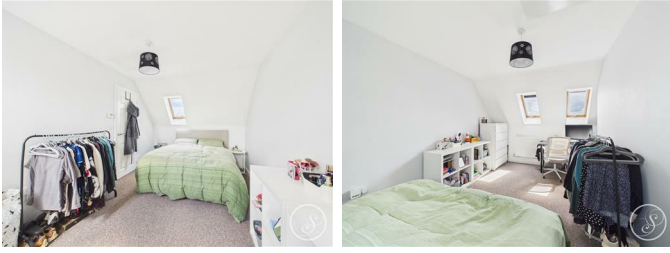

Double glazed window to the rear elevation. Two velux windows. Central heating radiator.

EXTERNAL



Grass laid to lawn to the rear elevation. Grass laid to the front elevation.

Floor Plan

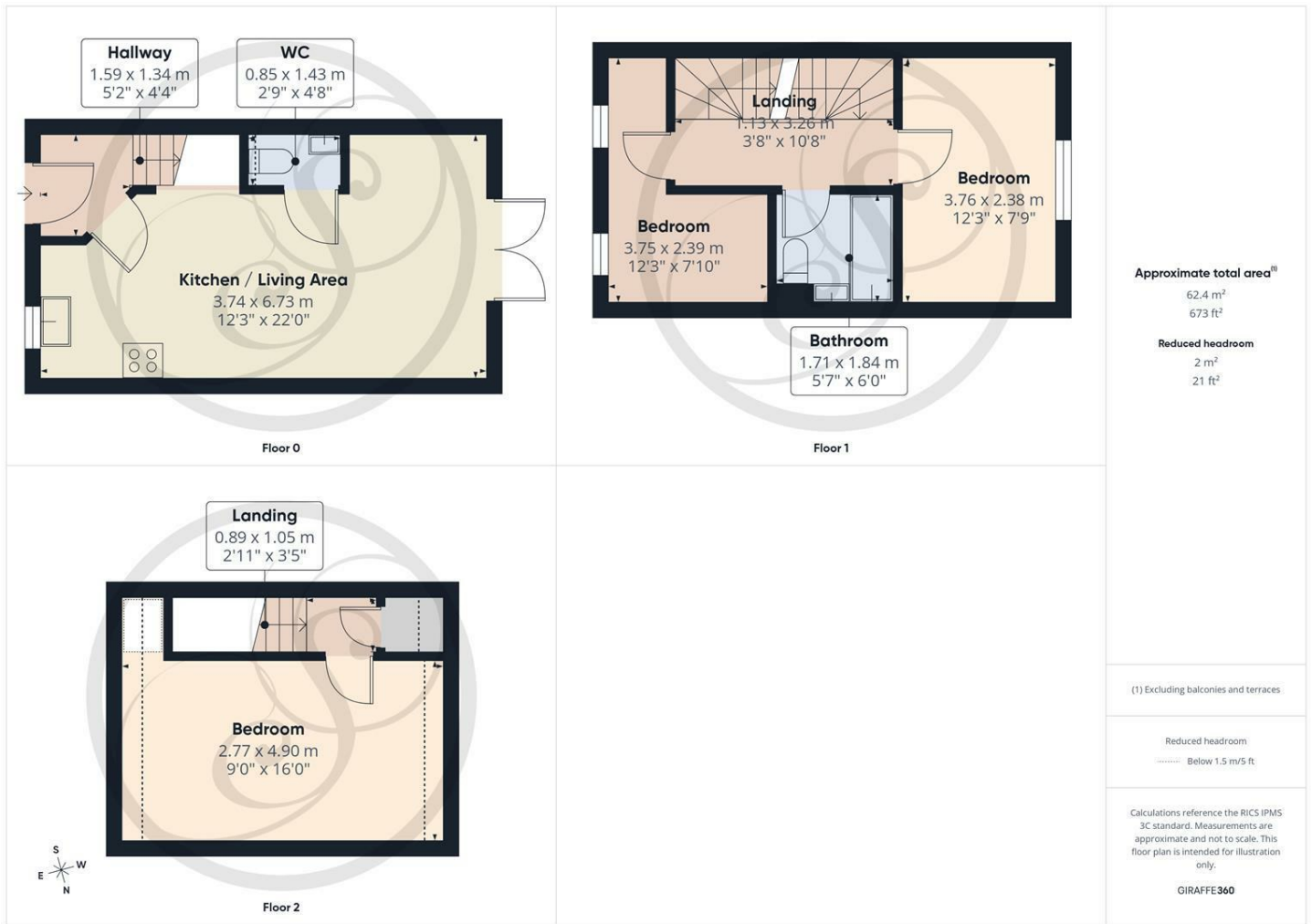

Area Map



Energy Efficiency Graph

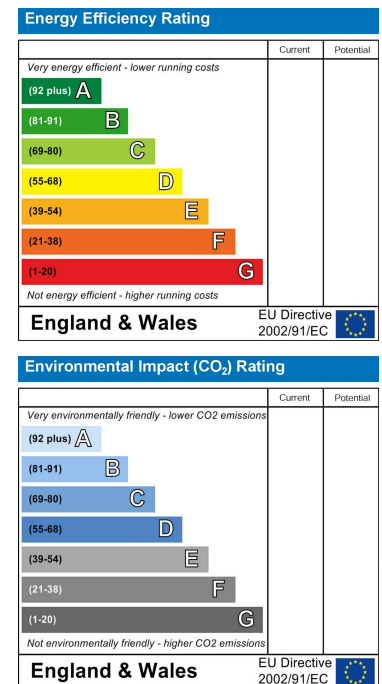

These particulars, whilst believed to be accurate are set out as a general outline only for guidance and do not constitute any part of an offer or contract. Intending purchasers should not rely on them as statements of representation of fact, but must satisfy themselves by inspection or otherwise as to their accuracy. No person in this firm's employment has the authority to make or give any representation or warranty in respect of the property.

