



Connells

Culworth Crescent
Northampton



Property Description

Offered to the market with NO UPWARD CHAIN, and set on a spacious corner plot is this three bedroom semi-detached house located in the popular area of Kingsthorpe and within easy access to local schools and amenities.

The property in brief comprises entrance hall, lounge and open plan kitchen/dining room. To the first floor there are three bedrooms and a family shower room.

Outside there are lawned gardens to the front, rear and side, and a single garage with off road parking set to the front.

With an opportunity to extend subject to gaining the correct planning permission, viewing is highly advised to fully appreciate.

Entrance Hall

Door to the front elevation with complimentary UPVC double glazed window to the side. Further doors lead off to the lounge and open plan kitchen/dining room. Wall mounted radiator and stairs rising to the first floor landing.

Lounge

UPVC double glazed window to the front elevation. Gas fire, wall mounted lights, coving to ceiling and wall mounted radiator.

Kitchen/ Dining Room

Fitted kitchen with a range of wall and base level units. Stainless sink and drainer set into work surfaces and tiled to splash back areas. Peninsula providing extra storage and work space. Plumbing for washing machine and slim line dishwasher, and integrated appliances comprise fridge/freezer, oven and grill, and four ring gas hob with cooker hood over. Wall mounted radiator, tiled floor and space for dining table and chairs. UPVC

double glazed window to the rear elevation and UPVC double glazed French doors leading out to the rear garden. Further UPVC door to the side elevation provides access to the side patio area.

First Floor Landing

Stairs rise from the entrance hall. Doors lead off to three bedroom and the family bathroom. Airing cupboard, UPVC double glazed window to the side elevation and access to the loft space.

Bedroom One

UPVC double glazed window to the rear elevation, wall mounted radiator and fitted wardrobes.

Bedroom Two

UPVC double glazed window to the front elevation, wall mounted radiator and fitted wardrobes.

Bedroom Three

UPVC double glazed window to the front elevation and wall mounted radiator.

Shower Room

Three piece suite comprising shower cubicle, low level flush w.c and pedestal wash hand basin with tiling to splash back area. Wall mounted radiator and UPVC opaque double glazed window to the rear elevation.

Outside

Front Garden

Mainly laid to lawn with pathway leading to the front door. Retaining low level brick wall and gated access to the rear and side garden.

Rear/ Side Garden

Mainly laid to lawn with shrub borders and retaining timber fencing. Paved patio to the side of the property with low level brick wall. Gated access to the rear of the garden leads to the single garage and driveway. Outside water tap and gated access to the front garden.

Garage/ Parking

Single garage with up and over door and off road parking set to the front of the garage.

Council Tax Band

C



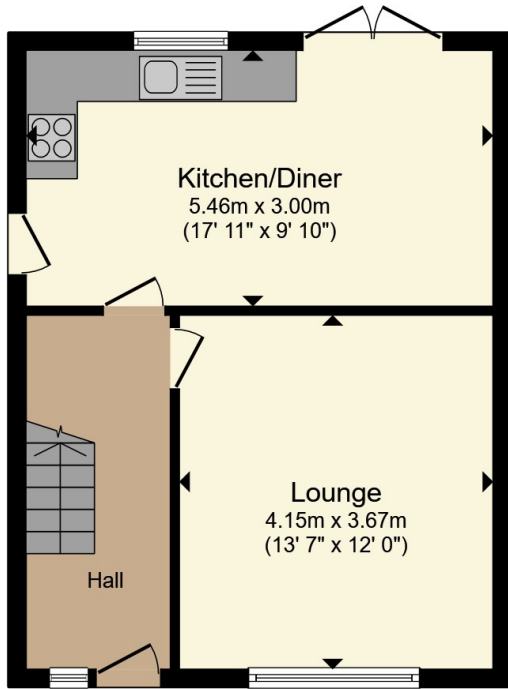

Ground Floor

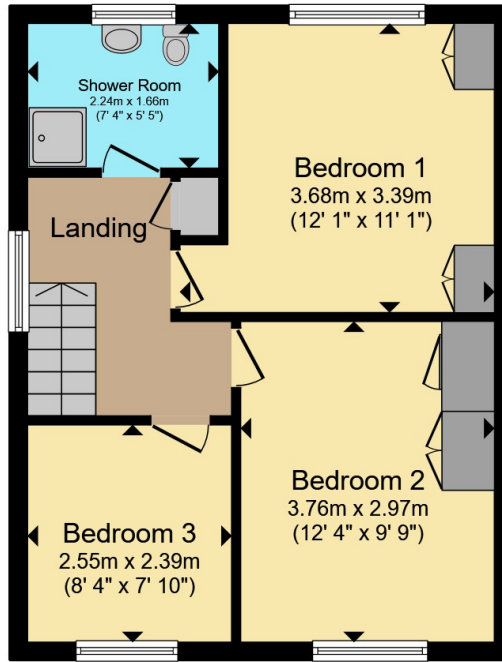

First Floor



Total floor area 79.2 m² (852 sq.ft.) approx

This floor plan is for illustrative purposes only. It is not drawn to scale. Any measurements, floor areas (including any total floor area), openings and orientation are approximate. No details are guaranteed, they cannot be relied upon for any purpose and they do not form part of any agreement. No liability is taken for any error, omission or misstatement. A party must rely upon its own inspection(s). Powered by www.propertybox.io



To view this property please contact Connells on

T 01604 716 655
E kingsthorpe@connells.co.uk

87 Harborough Road KINGSTHORPE
NORTHAMPTON NN2 7SL

EPC Rating: D Council Tax
Band: C

view this property online connells.co.uk/Property/KTP408108

Tenure: Freehold



1. MONEY LAUNDERING REGULATIONS Intending purchasers will be asked to produce identification documentation at a later stage and we would ask for your co-operation in order that there will be no delay in agreeing the sale. 2. These particulars do not constitute part or all of an offer or contract. 3. The measurements indicated are supplied for guidance only and as such must be considered incorrect. Potential buyers are advised to recheck measurements before committing to any expense. 4. We have not tested any apparatus, equipment, fixtures, fittings or services and it is in the buyers interest to check the working condition of any appliances.

Connells Residential is registered in England and Wales under company number 1489613, Registered Office is Cumbria House, 16-20 Hockliffe Street, Leighton Buzzard, Bedfordshire, LU7 1GN. VAT Registration Number is 500 2481 05.

See all our properties at www.connells.co.uk | www.rightmove.co.uk | www.zoopla.co.uk

Property Ref: KTP408108 - 0011