

Mather Lane, Leigh, WN7 2FS
£125,000

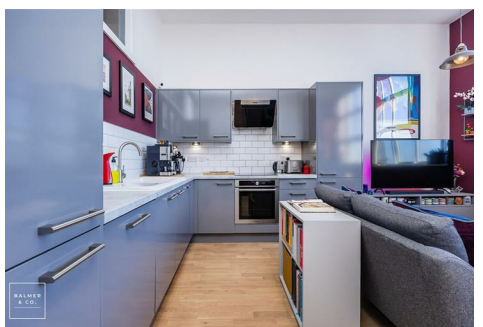

BALMER & CO in LEIGH are delighted to offer FOR SALE this spacious one bedroom apartment with allocated parking space, located on the third floor of the converted Mather House Mill in Leigh. Immaculately presented throughout with access to a range of on site amenities including a cinema room, private dining room as well as a gym, it would suit a wide range of buyers. Comprising in brief; secure intercom system, lift access to all floors, entrance hallway, stunning open plan living/dining room/kitchen with integrated appliances, master double bedroom with fitted wardrobes and a three piece fitted bathroom suite. An allocated parking space completes the accommodation on offer. Externally, the property is located alongside the Bridgewater canal with transport links to Manchester city centre within walking distance. Early viewings highly recommended, all enquiries welcome.

Floor Plan

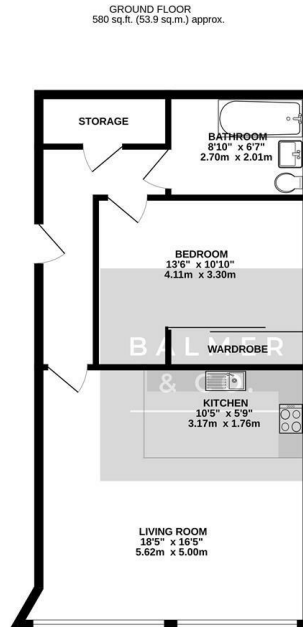

TOTAL FLOOR AREA: 580 sq.ft. (53.9 sq.m.) approx.
While every attempt has been made to ensure the accuracy of the floorplan contained here, measurements of floors, walls, rooms and any other areas are approximate and no responsibility is taken for any error, omission or misstatement. This plan is for illustrative purposes only and should be used as such by any prospective purchaser. The vendor accepts no liability for errors or omissions and the purchaser is to be bound by the actual measurements shown on the ground plan.
Made with Metaphor CAD

Area Map

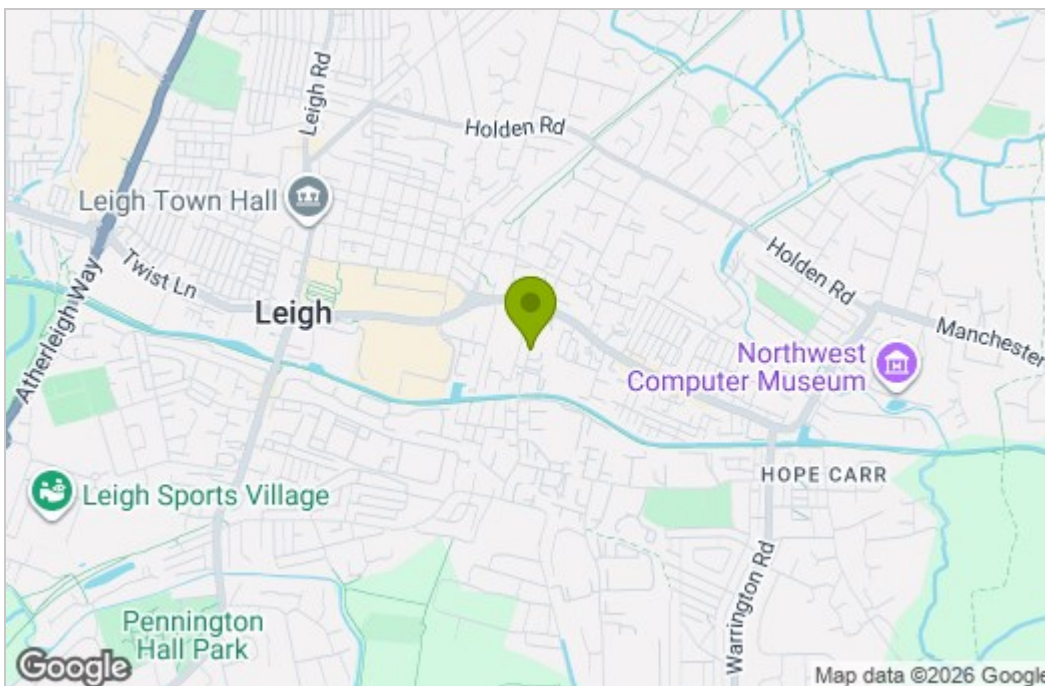

Energy Efficiency Graph

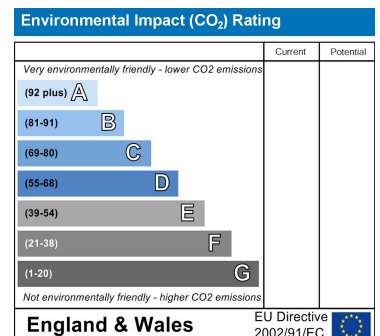
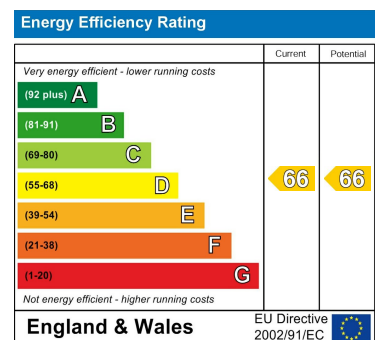

These particulars, whilst believed to be accurate are set out as a general outline only for guidance and do not constitute any part of an offer or contract. Intending purchasers should not rely on them as statements of representation of fact, but must satisfy themselves by inspection or otherwise as to their accuracy. No person in this firm's employment has the authority to make or give any representation or warranty in respect of the property.