



LANCASTER TERRACE, W2

£699,000

Excellent Transport Links
Close Proximity to Hyde Park
Share of Freehold
24/7 Concierge
Balcony
Lift

@marshandparsons
marshandparsons.co.uk

MARSH &
PARSONS



ABOUT THE PROPERTY

Positioned within an attractive red brick portered building, this lovely, spacious apartment boasts high ceilings throughout. The accommodation comprises a very generous reception room with excellent dining space and a pleasant south/westerly aspect leading to balcony, a separate well appointed kitchen, large bedroom with ample storage space and a bathroom with a bath. The service charge also includes heating and hot water.

Maitland Court is a popular portered building with the highly sought after area of Lancaster Gate, with excellent transport links close by at Lancaster Gate tube station (Central Line) and Paddington Station (Heathrow Express and Elizabeth line). There is also a wealth of local shops,



STEP INSIDE LANCASTER TERRACE

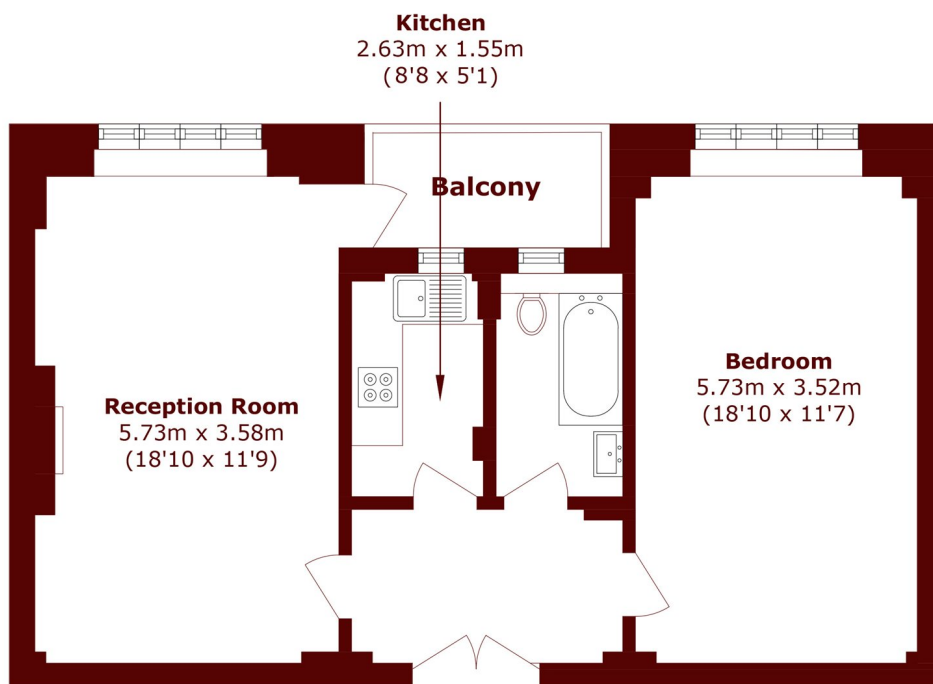

Total area (approx.): 57.6 sq. m (620.0 sq. ft)

Balcony area (approx.): 3.0 sq. m (32.2 sq. ft)

Notting Hill
020 7313 2890

Energy Rating: C We aim to make our particulars both accurate and reliable. However, they are not guaranteed; nor do they form part of an offer or contract. If you require clarification on any points then please contact us, especially if you're traveling some distance to view. Please note that appliances and heating systems have not been tested and therefore no warranties can be given as to their good working order

**MARSH &
PARSONS**