



Price

£330,000

Leasehold

2x  1x  1x 

**The Saddlery, Little
Bookham, Leatherhead,
Surrey, KT23**

OVER 60?

Secure this property
for up to **59% less!**

cubitt&west
Helping you move forwards



Main features

- Located in the popular village, close to shops and local amenities
- Open plan kitchen/living room
- Private development
- Allocated parking
- Ideal for first-time buyers, investors or downsizers

Accommodation

GROUND FLOOR

Hallway

Kitchen/Living Room: 21'7 x 11'9 (6.58m x 3.58m)

Bedroom 1: 12'4 x 10'7 (3.76m x 3.23m)

Bedroom 2: 11'4 x 9'9 (3.46m x 2.97m)

Bathroom

OUTSIDE

2 Allocated Parking Spaces

Ground Floor

Approx. 61.1 sq. metres (657.9 sq. feet)

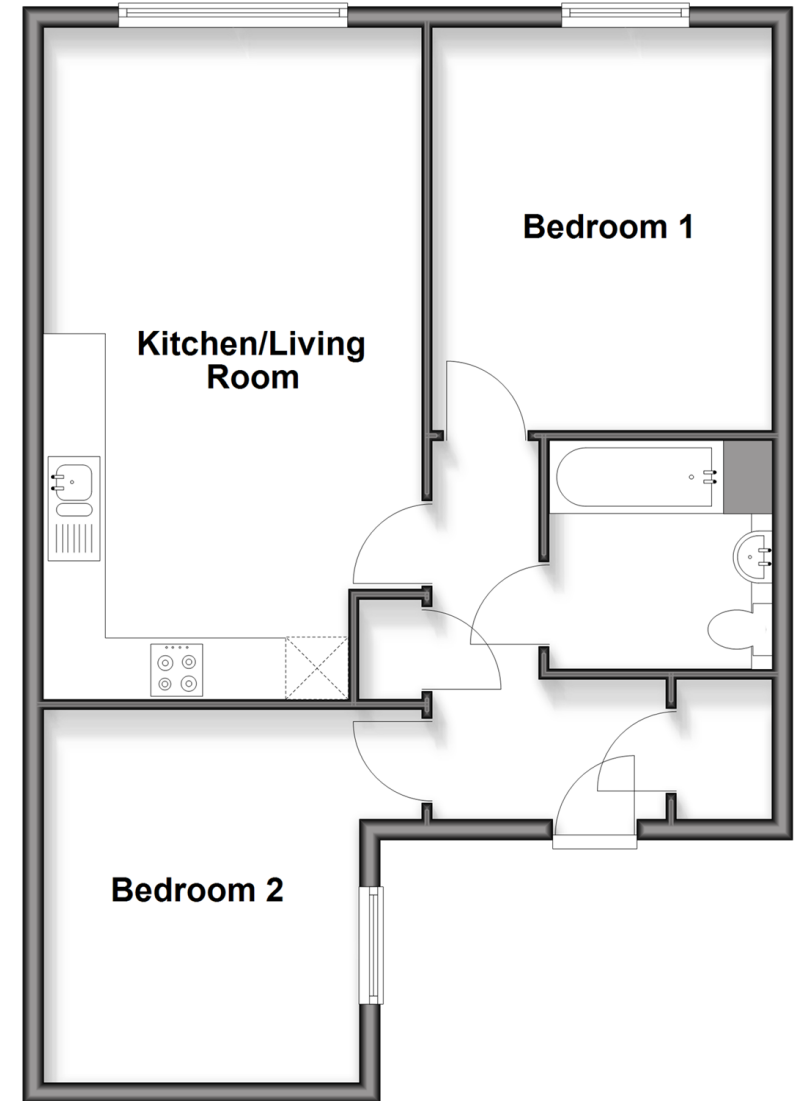

Call Leatherhead - 01372 373780 ■ CubittAndWest.Co.Uk

- Legal advice should be taken to verify fixtures/fittings, planning, alterations and/or lease details
- Appliances & services are untested, dimensions are approximate and floor plans are not to scale
- Through a Homewise Home For Life Plan people aged 60+ can secure this property for up to 50% less, by purchasing a Lifetime Lease



21108376/20251209/JL/JL