

## The Meadows, Biddenden, Ashford, Kent

### **Offers Around £218,500**

#### **DESCRIPTION**

Superb three bedroom semi detached family home, which is situated in an established position in the sought after Walden village of Biddenden. Biddenden village has primary schools and shops for most needs. The property enjoys a pleasant aspect to the front and a good size rear garden. Internally the accommodation comprises three bedrooms and bathroom to the first floor. To the ground floor there is a spacious sitting room, dining room, modern fitted kitchen, hallway and boasts double glazing. The accommodation is complemented by gas fired central heating and tasteful, well presented decoration. Early viewing is recommended by the vendors agents. Please call the branch for further details and to arrange your viewing via the sole selling agent. A copy of the EPC will be available on request. EPC Grade C.

#### **LOCATION**

Biddenden village is approx three miles distance from Tenterden town centre. Tenterden the Jewel of the Weald, has comprehensive range of amenities including pubs, shops, boutiques, restaurants, leisure centre and golf course.

#### **DIRECTIONS**

From the agents Tenterden office proceed on the A28 towards Ashford, continue turning left, sign posted toward Biddenden village, proceed to the centre of Biddenden village, continue and turn left as indicated into the Meadows where the property can be found on the left hand side.



Ground Floor  
Floor Size: 41.2 m<sup>2</sup>, 443.4 ft<sup>2</sup>

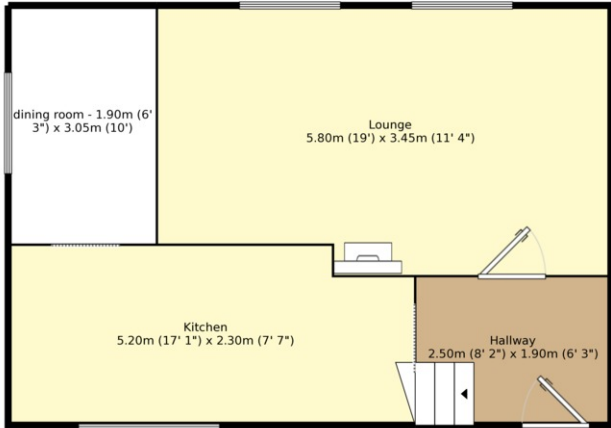

First Floor  
Floor Size: 41.2 m<sup>2</sup>, 443.4 ft<sup>2</sup>

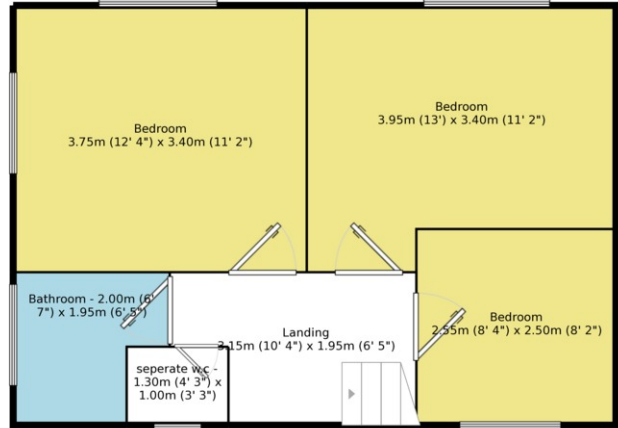

Measurements are approximate. Not to scale. For illustrative purposes only.



For full EPC please contact the branch

Your Move is a trading name of your-move.co.uk, registered in England at Newcastle House, Albany Court, Newcastle Business Park, Newcastle upon Tyne NE4 7YB (number 01864469).

IMPORTANT NOTE TO PURCHASERS: We endeavour to make our sales particulars accurate and reliable, however, they do not constitute or form part of an offer or any contract and none is to be relied upon as statements of representation or fact. The services, systems and appliances listed in this specification have not been tested by us and no guarantee as to their operating ability or efficiency is given. All measurements have been taken as guide to prospective buyers only, and are not precise. Floor plans where included are not to scale and accuracy is not guaranteed. If you require clarification or further information on any points, please contact us, especially if you are travelling some distance to view. Fixtures and fittings other than those mentioned are to be agreed with the seller.

\*Source: Nielsen, Oct 2012.

\*\*Calls may be recorded and/or monitored for training and/or security purposes.



53 High Street, Tenterden, TN30 6BJ

tel: 01580 762241 \*\*

email: Tenterden@your-move.co.uk

www.your-move.co.uk - The UK's most visited estate agency website\*



YOUR MOVE

WWW.YOUR-MOVE.CO.UK

Our properties also appear on... **Zoopla.co.uk** **rightmove.co.uk** **PrimeLocation.com**