



DANIEL ARCHER

exp[®] UK

@ daniel.archer@exp.uk.com

🌐 danielarcher.exp.uk.com

☎ 07792 947 756

Tolverne Road, West Wimbledon, SW20

£1,050,000

🛏 3 🚿 2 🚗 2

- Beautiful Three Double Bedroom Edwardian Home (1,275 Sq.Ft)
- Character Appeal and Modern Finish
- Well Equipped Extended Kitchen with Utility Room
- Private Garden
- Short Walk to Shops, Schools and Amenities
- Sought After West Wimbledon Location
- Double Length Through Reception/Dining Room
- Two Bath/Shower Rooms
- Close to Raynes Park Station
- Property Ref; DA0587



Well presented three double bedroom Edwardian terraced property (1,275 Sq.Ft) with private garden, conveniently situated just a short walk from Raynes Park station, fantastic local schools and amenities. The property offers bright, well proportioned accommodation arranged over three floors, sympathetically updated with modern interiors and neutral décor which complement the property's character appeal. Flowing living space, extended to the ground and second floors, provides ample space for a growing family, with features including an inviting double length reception/dining room, well equipped extended kitchen/diner with separate utility, first floor bathroom and ground floor shower room, quality floor coverings, gas central heating and double glazing.



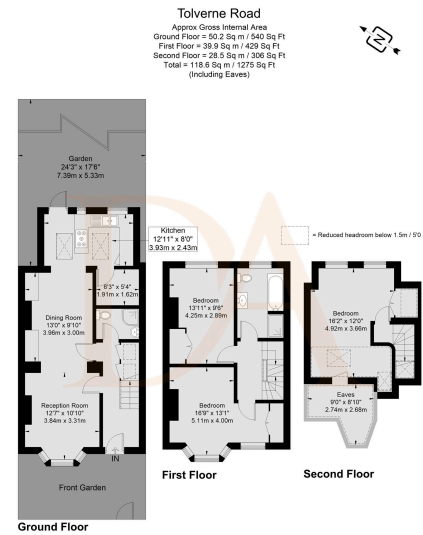

Viewmedia © 2024
 Viewmedia.co.uk
 Whilst every effort has been made to ensure the accuracy of this floor plan, measurements of doors, windows and rooms are approximate and no responsibility is taken for any error or omission. This illustration is for identification purposes only, has been drawn to scale, unless stated. Dimensions shown are to the nearest 2" and are to the points indicated by the arrow heads.

