



## Pine Road, NW2 Freehold - £750,000

FOR SALE and offered Chain Free is this refurbished three bedroom period mid-terraced house offering 1,458 sq ft of well-proportioned accommodation set in the heart of Cricklewood.

The Ground Floor is comprised of a bright bay fronted reception room, dining room, modern kitchen with access to a 17 ft private rear garden and a downstairs shower room. The First Floor features three double bedrooms serviced by a three piece family bathroom. There is also potential to extend to the side and into the loft (SSTP).

Pine Road is moments away from Cricklewood Broadway and Willesden Green. The area offers an array of local amenities and the green open spaces of the 86-acre Gladstone Park. Transport links include Cricklewood (Thameslink- Zone 3) and Willesden Green (Jubilee - Zone 2).

- Offered CHAIN FREE
- 3 bedroom mid-terraced Period house
- Offering 1,458 sq ft of accommodation over 2 floors
- Potential to extend at the side and into the loft (SSTP)
- New electrical rewiring, loft & floor insulation
- COUNCIL: Brent (D)



020 7328 2828

[enquiries@cameronsstiff.co.uk](mailto:enquiries@cameronsstiff.co.uk)

[cameronsstiff.co.uk](http://cameronsstiff.co.uk)

## Pine Road, London, NW2

Approximate Area = 1458 sq ft / 135.4 sq m

For identification only - Not to scale

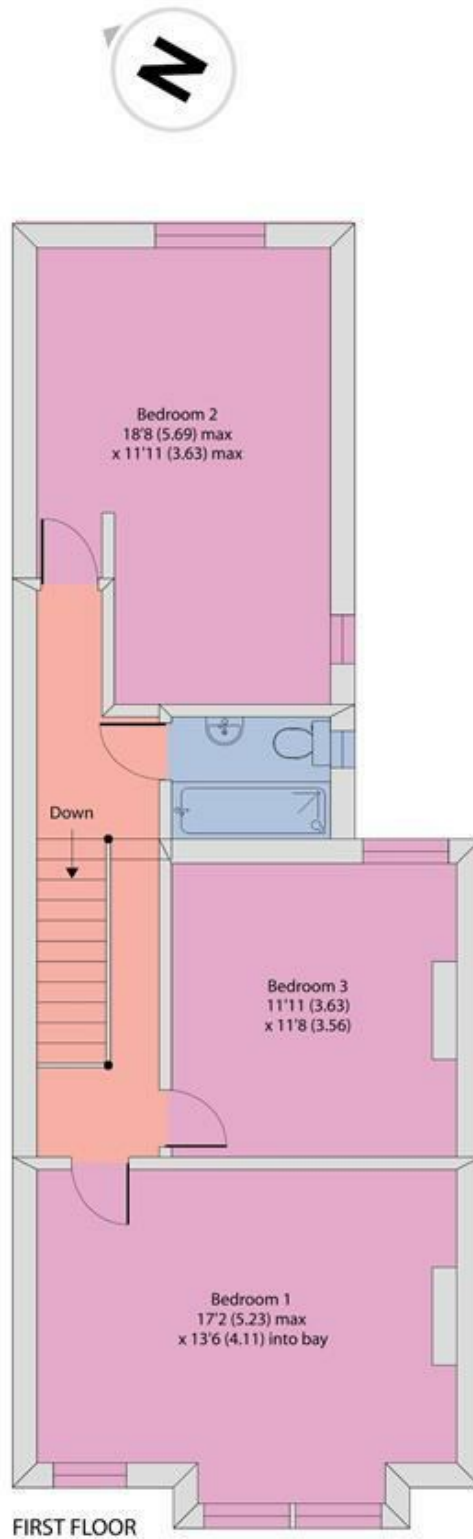

EPC: D

Ref: 19674664



Floor plan produced in accordance with RICS Property Measurement Standards incorporating International Property Measurement Standards (IPMS2 Residential). © nichecom 2024. Produced for Camerons Stiff & Co. REF: 1155382

