



Dunmow Close, Feltham, TW13 6YD

Welcome to Dunmow Close, Feltham

A beautifully presented two-bedroom first-floor apartment situated within the desirable Dunmow Close, offering stylish and well-maintained accommodation throughout.

The property has been modernised to a high standard, creating a bright and contemporary living space ideal for a range of buyers. The spacious reception room provides a comfortable area for both relaxing and entertaining, while the brand new kitchen has been thoughtfully designed with modern fittings and ample storage.

There are two bedrooms, both benefiting from built-in wardrobe storage. The second bedroom is currently utilised as a home office, making it perfect for those working remotely or seeking flexible living space.

Further benefits include gas central heating, a secure entry phone system, and on-street parking.

Located within a quiet residential area, the property is conveniently positioned for local amenities and transport links.



DUNMOW CLOSE

APPROXIMATE GROSS INTERNAL FLOOR AREA: 495 SQ FT - 46.02 SQ M

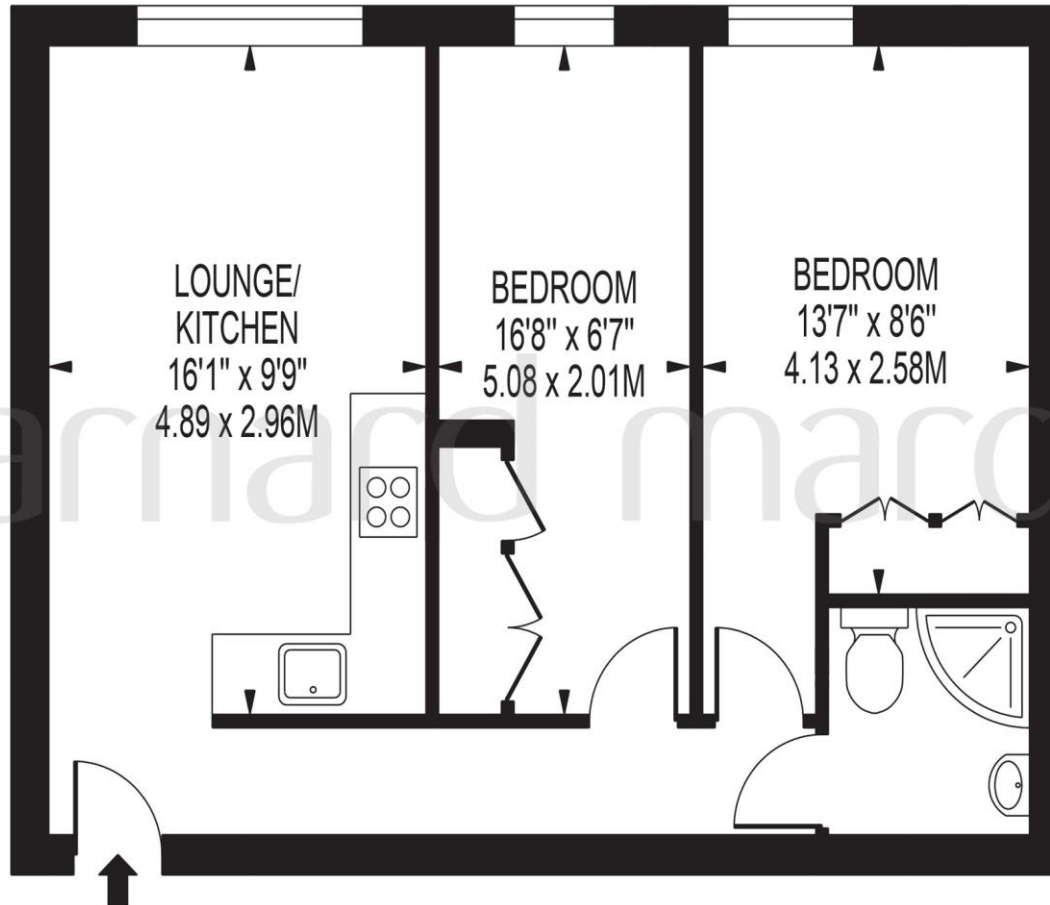

FOR ILLUSTRATION PURPOSES ONLY

THIS FLOOR PLAN SHOULD BE USED AS A GENERAL OUTLINE FOR GUIDANCE ONLY AND DOES NOT CONSTITUTE IN WHOLE OR IN PART AN OFFER OR CONTRACT.
ANY INTENDING PURCHASER OR LESSEE SHOULD SATISFY THEMSELVES BY INSPECTION, SEARCHES, ENQUIRIES AND FULL SURVEY AS TO THE CORRECTNESS OF EACH STATEMENT.
ANY AREAS, MEASUREMENTS OR DISTANCES QUOTED ARE APPROXIMATE AND SHOULD NOT BE USED TO VALUE A PROPERTY OR BE THE BASIS OF ANY SALE OR LET.

Welcome to

Dunmow Close, Feltham

- TWO BEDROOM FIRST FLOOR APARTMENT
- MODERNISED THROUGHOUT
- BRAND NEW CONTEMPORARY KITCHEN
- SPACIOUS AND BRIGHT LIVING AREA
- BUILT-IN WARDROBES TO BOTH BEDROOMS

Tenure: Leasehold EPC Rating: C

Council Tax Band: B Service Charge: 1978.13

Ground Rent: 10.00

This is a Leasehold property with details as follows; Term of Lease 125 years from 12 Feb 1990. Should you require further information please contact the branch. Please Note additional fees could be incurred for items such as Leasehold packs.

guide price

£230,000



Please note the marker reflects the postcode not the actual property

view this property online barnardmarcus.co.uk/Property/FEL113580



Property Ref:

FEL113580 - 0002

1. MONEY LAUNDERING REGULATIONS Intending purchasers will be asked to produce identification documentation at a later stage and we would ask for your co-operation in order that there is no delay in agreeing the sale. 2. These particulars do not constitute part or all of an offer or contract. 3. The measurements indicated are supplied for guidance only and as such must be considered incorrect. Potential buyers are advised to recheck measurements before committing to any expense. 4. We have not tested any apparatus, equipment, fixtures or services and it is in the buyers interest to check the working condition of any appliances. 5. Where an EPC, or a Home Report (Scotland only) is held for this property, it is available for inspection at the branch by appointment. If you require a printed version of a Home Report, you will need to pay a reasonable production charge reflecting printing and other costs. 6. We are not able to offer an opinion either written or verbal on the content of these reports and this must be obtained from your legal representative. 7. Whilst we take care in preparing these reports, a buyer should ensure that his/her legal representative confirms as soon as possible all matters relating to title including the extent and boundaries of the property and other important matters before exchange of contracts.

Barnard Marcus is a trading name of Sequence (UK) Limited which is registered in England and Wales under company number 4268443, Registered Office is Cumbria House, 16-20 Hockliffe Street, Leighton Buzzard, Bedfordshire, LU7 1GN. VAT Registration Number is 500 2481 05.



barnard marcus



020 8890 4037



Feltham@barnardmarcus.co.uk



4 Parkfield Parade, High Street, FELTHAM,
Middlesex, TW13 4HJ



barnardmarcus.co.uk