



Connells

Upper Close  
Forest Row



# Upper Close Forest Row RH18 5DS

for sale  
**£500,000**



## Property Description

This charming three-bedroom semi-detached period home is beautifully positioned in the ever-popular village of Forest Row, combining character, space and a wonderfully tranquil setting. Offering a blend of traditional features and modern comforts, the property provides an inviting layout ideal for both families and those looking to enjoy village life on the edge of the Ashdown Forest.

The ground floor offers a warm and welcoming feel from the moment you step inside. A light-filled sitting room with a feature fireplace creates a cosy focal point, while the adjoining dining area provides an excellent space for entertaining or everyday family living. The kitchen, thoughtfully arranged with ample storage and work surfaces, benefits from lovely views towards the garden.

Upstairs, the property offers three well-proportioned bedrooms, each enjoying good natural light and pleasant outlooks. The main bedroom benefits from views over the surrounding countryside, adding to the home's peaceful atmosphere. A family bathroom completes the first floor, fitted in a clean, timeless style.

Outside, the house continues to impress. A generous driveway provides ample off-street parking-an increasingly rare advantage in this part of Forest Row. The rear garden is a particular feature, offering a mix of lawn, patio and mature planting, ideal for outdoor dining or simply relaxing in the sunshine.

## Sitting Room

15' x 12' 8" ( 4.57m x 3.86m )

## Study

9' 3" x 7' 2" ( 2.82m x 2.18m )

## Conservatory

12' 3" x 9' 4" ( 3.73m x 2.84m )

## Kitchen

15' 11" x 11' 3" ( 4.85m x 3.43m )

## Shower Room

## Bedroom 1

16' 2" x 8' 9" ( 4.93m x 2.67m )

## Bedroom 2

13' 10" x 7' 10" ( 4.22m x 2.39m )

## Bedroom 3

11' 3" x 7' 2" ( 3.43m x 2.18m )

## Family Bathroom

## Driveway

## Garage









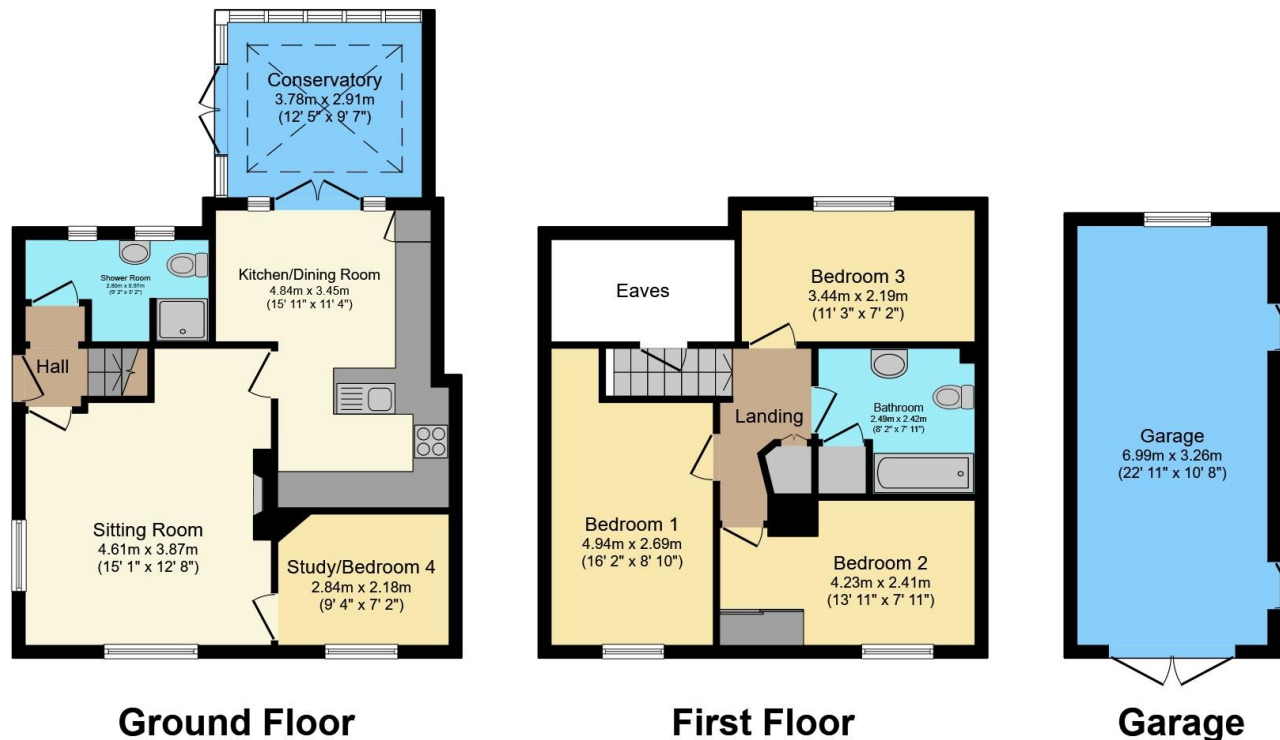

Total floor area 124.3 m<sup>2</sup> (1,338 sq.ft.) approx

This floor plan is for illustrative purposes only. It is not drawn to scale. Any measurements, floor areas (including any total floor area), openings and orientation are approximate. No details are guaranteed, they cannot be relied upon for any purpose and they do not form part of any agreement. No liability is taken for any error, omission or misstatement. A party must rely upon its own inspection(s). Powered by [www.propertybox.io](http://www.propertybox.io)

**Connells**

To view this property please contact Connells on

**T 01342 325 911**  
**E [eastgrinstead@connells.co.uk](mailto:eastgrinstead@connells.co.uk)**

90 London Road  
 EAST GRINSTEAD RH19 1EP

EPC Rating: D Council Tax  
 Band: D

Tenure: Freehold

**view this property online [connells.co.uk/Property/EGR405021](http://connells.co.uk/Property/EGR405021)**



1. MONEY LAUNDERING REGULATIONS Intending purchasers will be asked to produce identification documentation at a later stage and we would ask for your co-operation in order that there will be no delay in agreeing the sale. 2. These particulars do not constitute part or all of an offer or contract. 3. The measurements indicated are supplied for guidance only and as such must be considered incorrect. Potential buyers are advised to recheck measurements before committing to any expense. 4. We have not tested any apparatus, equipment, fixtures, fittings or services and it is in the buyers interest to check the working condition of any appliances.

Connells Residential is registered in England and Wales under company number 1489613, Registered Office is Cumbria House, 16-20 Hockliffe Street, Leighton Buzzard, Bedfordshire, LU7 1GN. VAT Registration Number is 500 2481 05.

**See all our properties at [www.connells.co.uk](http://www.connells.co.uk) | [www.rightmove.co.uk](http://www.rightmove.co.uk) | [www.zoopla.co.uk](http://www.zoopla.co.uk)**

Property Ref: EGR405021 - 0003