



Guide Price
£360,000

Freehold

4x  2x  1x 

**Groombridge Drive,
Gillingham, Kent, ME7**

OVER 60?

Secure this property
for up to **59% less!**

Wards
Helping you move forwards



Main features

- Spacious family home with accommodation laid out over 3 floors
- Double glazed conservatory
- No parking issues with garage and driveway
- Situated on the outskirts of Gillingham in a cul-de-sac position
- Excellent road connections

Accommodation

GROUND FLOOR

Entrance Hall
 Kitchen: 10'5 x 6'8 (3.18m x 2.03m)
 Cloakroom
 Lounge: 15'0 x 13'7 (4.58m x 4.14m)
 Conservatory: 12'2 x 6'4 (3.71m x 1.93m)
 Store Room: 9'8 x 6'3 (2.95m x 1.91m)

FIRST FLOOR

Landing
 Bedroom 1: 13'9 x 11'4 (4.19m x 3.46m)
 En-suite Shower Room
 Bedroom 4: 10'1 x 6'9 (3.08m x 2.06m)

SECOND FLOOR

Landing
 Bedroom 2: 13'7 x 11'3 (4.14m x 3.43m)
 Bathroom
 Bedroom 3: 13'7 into bay (4.14m) narrowing to 10'1 (3.08m) x 9'8 (2.95m)

OUTSIDE

Driveway
 Garage
 Rear Garden

Call Gillingham - 01634 851191 ■ wardsof Kent.co.uk

- Legal advice should be taken to verify fixtures/fittings, planning, alterations and/or lease details
- Appliances & services are untested, dimensions are approximate and floor plans are not to scale
- Through a Homewise Home For Life Plan people aged 60+ can secure this property for up to 50% less, by purchasing a Lifetime Lease.

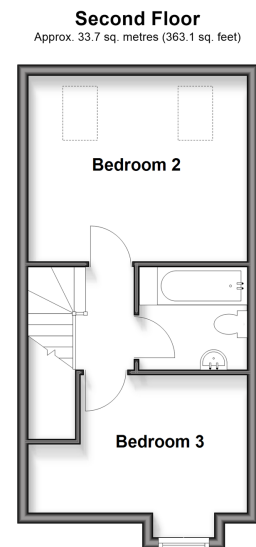
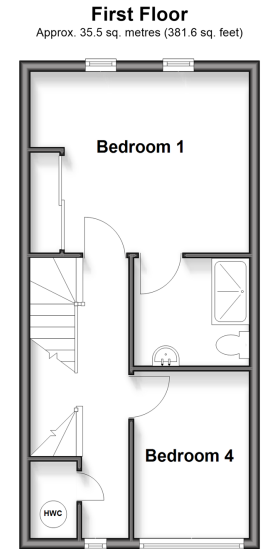
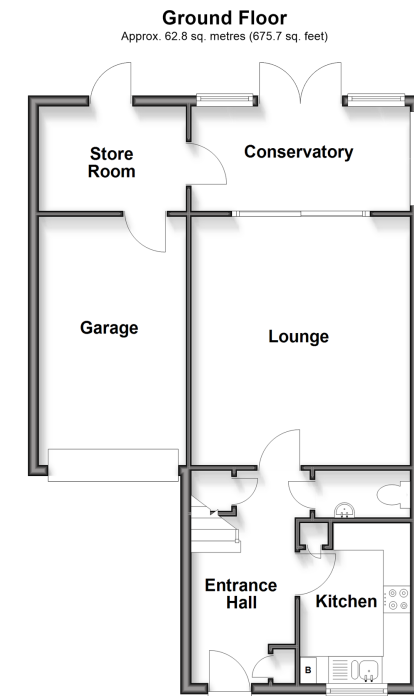

10925999/20251129/GS/GS