



Partridge Road,
Cardiff,
CF24 3QP



Per Month
£1,100 Per Month

2 Bedrooms
Maisonette

This is a super two double bedroom maisonette occupying the first floor of a small private development of just three. Great central location for city centre and with it's own allocated parking bay, new carpets to bedrooms and newly decorated throughout. Spacious kitchen with tastefully tiled flooring, gas hob and boiler. Unfurnished with white goods and fitted to wardrobes to main bedroom. Gas central heating. Council Tax band E. EPC rating C. Available May 2026 for minimum twelve month term.

Features

- Spacious Maisonette on First Floor of Small Private Development
- Two Double Bedrooms/Large Modern Kitchen with Tiled Flooring
- Excellent Location for City Centre/Within 1km
- Allocated Bay Within Private Car Park
- Unfurnished with Kitchen Appliances/Wardrobes to Main Bedroom
- New Carpets to Bedrooms/Newly Decorated Throughout
- Gas Central Heating
- EPC Rating C/Council Tax Band E



Information

- Tenure:
- Council Tax Band: E
- Floor Area: 861.12 sq ft
- Current EPC Rating: C
- Potential EPC Rating:



2 BEDROOMS



1 BATHROOMS



1 RECEPTION ROOMS



ENERGY RATING: C

Ground Floor

Approx. 75.4 sq. metres (811.4 sq. feet)

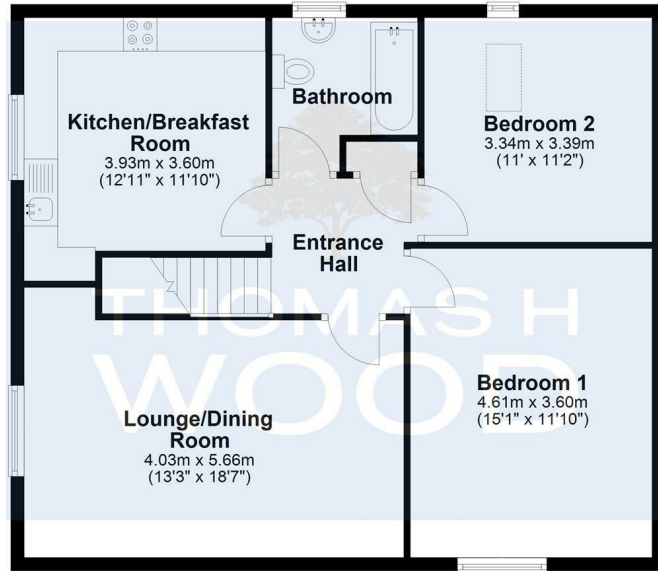

Total area: approx. 75.4 sq. metres (811.4 sq. feet)



Agents Note: Whilst every care has been taken to prepare these sales particulars, they are for guidance purposes only. All measurements are approximate and for general guidance purposes only and whilst every care has been taken to ensure their accuracy, they should not be relied upon and potential buyers are advised to recheck the measurements

Energy Efficiency Rating		Current	Potential
Very energy efficient - lower running costs			
(92 plus) A			
(81-91) B			
(69-80) C			
(55-68) D		71	
(39-54) E			
(21-38) F			
(1-20) G			
Not energy efficient - higher running costs			
England & Wales		EU Directive 2002/91/EC	



CONTACT

sales@thomashwood.com
02920 626 252
thomashwood.com

WHITCHURCH BRANCH

14 Park Road,
Whitchurch
CF14 7BQ

RADYR BRANCH

5 Station Road,
Radyr, Cardiff
CF15 8AA