



Scan me to get a **detailed property report & valuation** on your house!



Warwick Street, Town Centre  
Asking Price £85,000

**complete** ●●●  
ESTATE AGENTS



# Warwick Street, Town Centre, Rugby

Complete Estate Agents are proud to introduce this charming top-floor one-bedroom apartment on Warwick Street offers a delightful blend of modern living and historic character. Situated within a thoughtfully converted building, this property is perfect for those seeking a convenient lifestyle in a vibrant town centre.

Upon entering, you are greeted by a welcoming reception room that provides a warm and inviting atmosphere, ideal for relaxation or entertaining guests. The well-proportioned bedroom offers a peaceful retreat, ensuring a restful night's sleep. The apartment also features a stylish bathroom, designed with contemporary fittings to meet your everyday needs.

The location is truly exceptional, placing you just moments away from an array of local amenities, including shops, cafes, and restaurants. With excellent transport links nearby, commuting to surrounding areas is both easy and efficient, making this property an ideal choice for professionals or anyone looking to enjoy the best of town centre living.

This apartment is not just a home; it is a lifestyle choice, offering comfort and convenience in a sought-after area. Whether you are a first-time buyer or looking to downsize, this property presents a wonderful opportunity to embrace the charm of Rugby. Do not miss the chance to make this delightful apartment your own.

## Communal Hallway.

Intercom entry system

## Hallway

## Lounge / Kitchen

## Bedroom

## Bathroom



## About Rugby

Rugby is a market town in Warwickshire, England, on the River Avon. The town has a population of 70,628 (2011 census[1]) making it the second largest town in the county. The enclosing Borough of Rugby has a population of 100,500 (2011 census). Rugby is 13 miles (21 km) east of Coventry, on the eastern edge of Warwickshire, near the borders with Northamptonshire and Leicestershire. The town is credited with being the birthplace of rugby football.

## Rugby Borough Council

Rugby Borough Council,  
Town Hall,  
Evreux Way,  
Rugby  
CV21 2RR

## Agents Note

The property is currently let at a monthly rent of £630.00.





Ground Floor

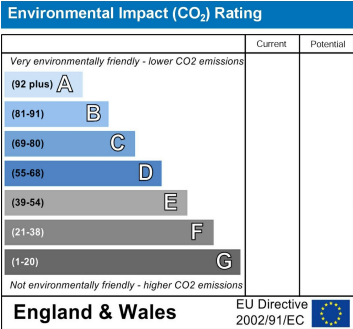
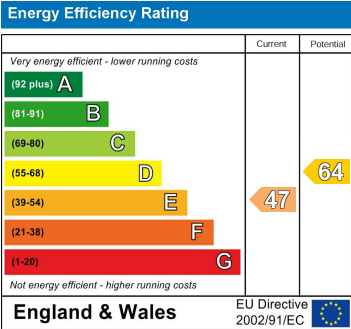
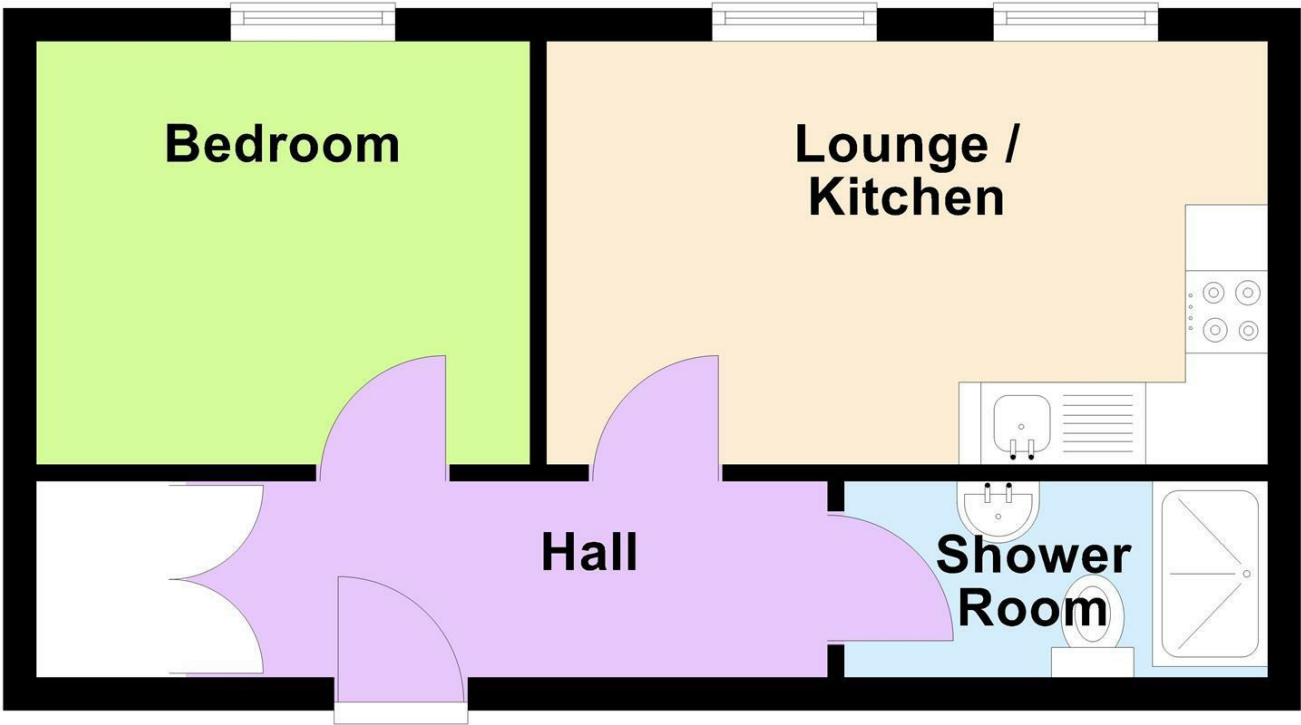

Misrepresentation Act 1967 - These particulars are believed to be correct but their accuracy is not guaranteed nor do they form part of any contract.