

St. Marys Close, Bluntisham, Huntingdon, PE28 3XQ

Guide Price £250,000

3 1 1



- A three bedroom semi-detached home in the village of Bluntisham
- Generous kitchen/dining room ideal for everyday family life
- Garage to the rear with parking in front
- Easy access to the A14 corridor for commuters
- Virtual tour available upon request
- Comfortable sitting room perfect for relaxing and unwinding
- Three bedrooms and a family bathroom upstairs
- Convenient village location close to St Ives and Huntingdon
- A lovely family home in a quiet and friendly village setting
- EPC Rating C/69

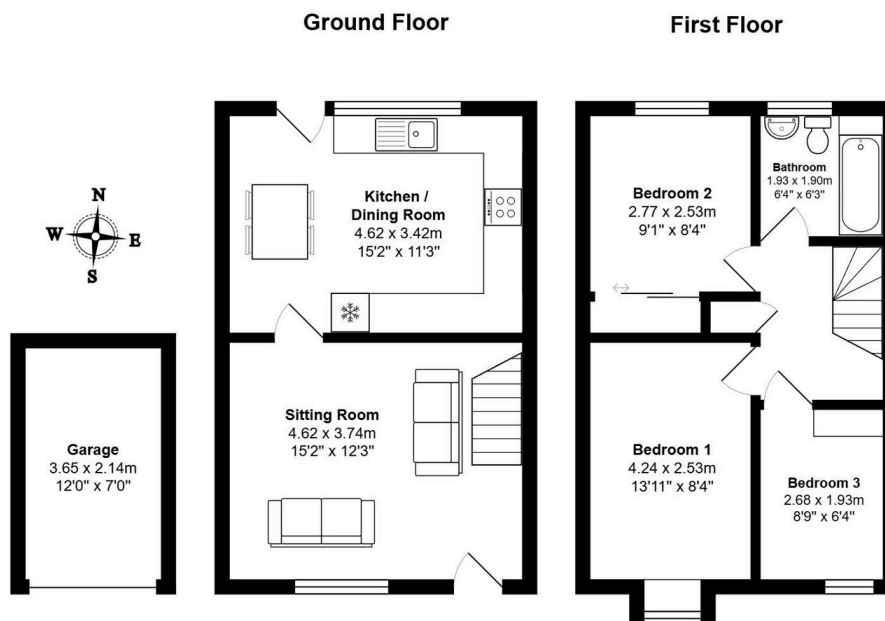

Total Area: 75.8 m<sup>2</sup> ... 816 ft<sup>2</sup>

All measurements are approximate and for display purposes only

Three bedrooms, a garage and a quiet village setting – St Marys Close ticks all the right boxes!