



Woodley Crescent, NW2

£363,000

Situated on the first floor of a recently built development, this one bedroom flat boasts an open-plan reception room with a fully fitted kitchen leading on to a private balcony, a large bathroom and ample storage cupboards. The property benefits from a communal garden.

Located on Woodley Crescent, situated a short distance from Cricklewood Station (Thameslink), and David Lloyds Gym, as well as numerous road connections including the A406, A41 and the M1.

Features

- Purpose Built Block
- One Bedroom Flat
- Open Plan Living
- Fully Fitted Kitchen
- Private Balcony
- Communal Gardens

Woodley Crescent, London, NW2

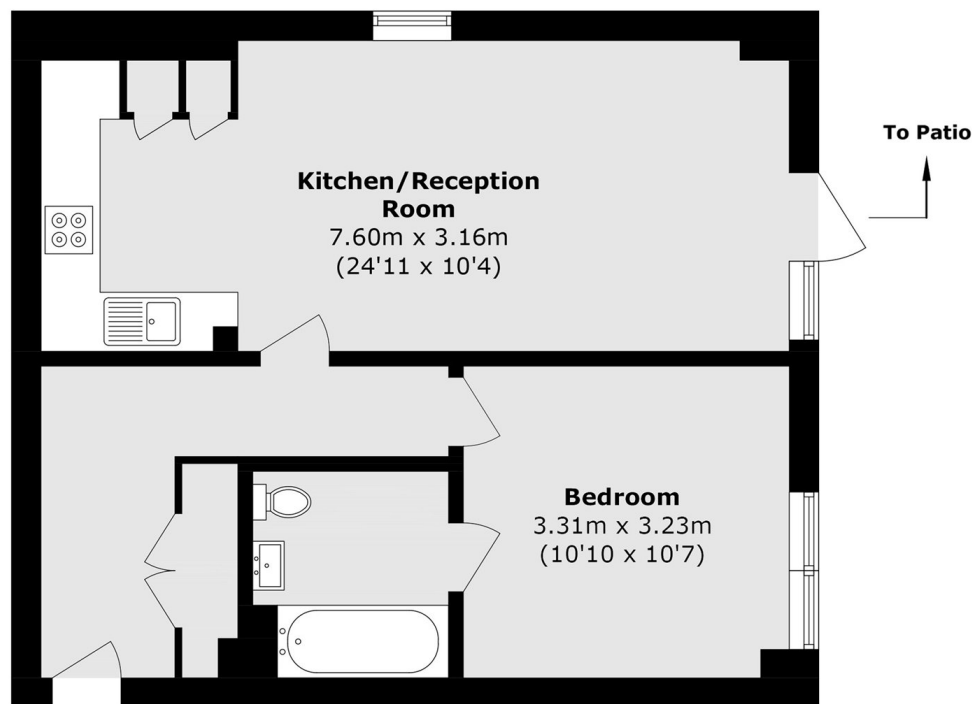

Total area (approx.): 49.6 sq. m (533.8 sq. ft)