



DavidJames
the estate agent

Staples Street, Nottingham, NG3 5HR

£875 Per Calendar Month

About This Property

Tucked away from the roadside, this charming and renovated terraced home blends period character with contemporary style, retaining some of its original features while benefiting from a series of thoughtful modern updates. Perfectly positioned close to Mapperley's excellent nearby amenities and frequent bus services to Nottingham City Centre.

Stepping inside, you're greeted by high ceilings and bright neutral décor. The two spacious reception rooms offer flexible living options - the front featuring an attractive period-style fireplace, while the rear benefits from a gas stove (currently capped).

The modern galley-style kitchen has been refitted with sleek cabinetry, integrated cooking appliances and has space for freestanding white goods alongside tiled splashbacks and marble-effect worktops. The bathroom also sits downstairs and has marble-effect shower board to the walls alongside a three-piece contemporary white suite.

Upstairs, there are two generous double bedrooms, neutrally decorated with large Georgian-styled windows.

Outside, the property enjoys a low-maintenance courtyard.

Available From: NOW

Tenancy Term: Minimum 6 months

Furnishing: Unfurnished

EPC Rating: E

Council Band: A

Pets: Not permitted



- Renovated terraced home
- Two well-proportioned double bedrooms with large Georgian-style windows and neutral décor
- Two spacious and neutrally decorated reception rooms with feature fireplaces
- Newly-fitted contemporary kitchen with integrated oven, hob and extractor
- Modern ground floor bathroom with a white three-piece suite
- Low-maintenance courtyard garden
- Ideal for those seeking easy access to Nottingham City Centre
- Situated close to Mapperley's excellent range of shops, restaurants and bars
- Excellent public transport links just a short walk away





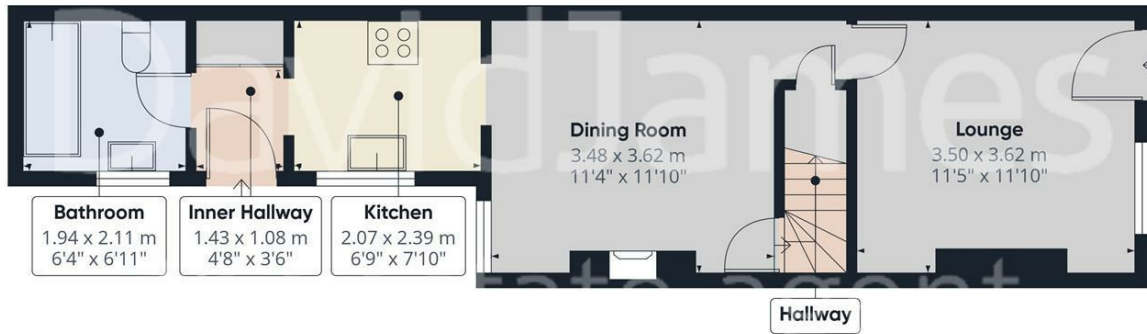

Floor 0

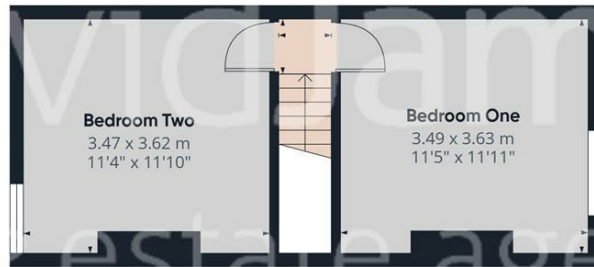

Floor 1



Approximate total area⁽¹⁾

63.9 m²
686 ft²

(1) Excluding balconies and terraces

Calculations reference the RICS IPMS 3C standard. Measurements are approximate and not to scale. This floor plan is intended for illustration only.

GIRAFFE360

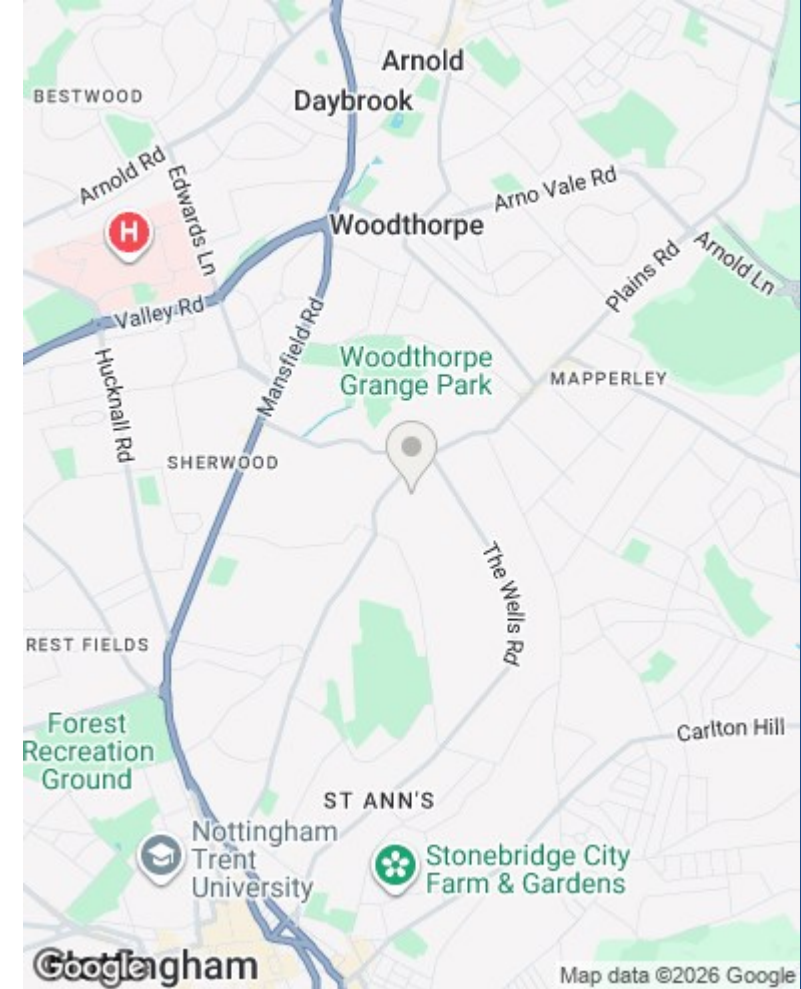

These particulars are produced in good faith, are set out as a general guide only and do not constitute any part of a contract. No person in the employment of David James Estate Agents Ltd has any authority to make any representation whatsoever in relation to the property. All services, together with electrical fittings or fitted appliances have NOT been tested. All the measurements given in the details are approximate. Floor plans are for illustrative purposes only and are not drawn to scale. The position and size of doors, windows, appliances and other features are approximate only. The photographs of this property have been taken with a 10mm wide-angle lens. No responsibility can be accepted for any loss or expense incurred in viewing. If you have a property to sell you may wish to take advantage of our free valuation service. David James Estate Agents have established professional relationships with third-party suppliers for the provision of services to Clients. As remuneration for this professional relationship, the agent receives referral commission from the third-party company. David James Estate Agents receives the following commission from each third party supplier on a per referral basis: W A Barnes Ltd: £60 including VAT. All Moves UK Ltd: 18% including VAT of the invoice total (£107 including VAT average). MoveWithUs Limited: £188 including VAT (average).

Council Tax Band: A
Nottingham City Council

DavidJames
the estate agent

David James Estate Agents
45b Plains Road, Mapperley, Nottingham, NG3 5JU
t: 0115 962 4213 e: lettings@david-james.com

