

WILKINSON

SALES • LETTINGS • MANAGEMENT

£325,000

Davey Road, Tewkesbury, GL20



 3

Bedrooms

 2

Bathrooms

101 High Street, Tewkesbury, Gloucestershire, GL20 5JZ |
Info@wilkinsonsIm.co.uk

01684 367736



- Town House
- Lounge & Kitchen
- Conservatory
- Downstairs WC
- Three Double Bedrooms
- Dressing Room & Ensuite
- Family Bathroom
- Garage
- Rear Garden
- Off Road Parking For Three Cars
- UPVC Double Glazing
- Gas Central Heating

Wilkinson SLM are delighted to present this beautifully maintained three-bedroom townhouse, offering generous and versatile accommodation arranged over three floors. Situated in the sought-after Saxon Park development, the property enjoys a convenient position close to local amenities, well-regarded schools, and excellent access to the M5—ideal for commuters. The ground floor welcomes you with a stylishly kitchen, featuring a range of base and wall units, and an integrated oven and hob with spaces for a washing machine and fridge freezer. To the rear, a spacious lounge/dining room provides a comfortable living space, complete with French doors opening to the conservatory. Patio doors here open to the rear garden which is mainly laid to lawn, making it low maintenance and perfect for both relaxing and entertaining. A convenient downstairs WC completes this level. On the first floor are two well-proportioned double bedrooms, along with a family bathroom. An airing cupboard adds practical storage. The top floor is dedicated to an impressive principal suite, offering a spacious main bedroom with an over-stairs storage cupboard. This level also benefits from a separate dressing room or study, and an en-suite shower room. A side gate in the rear garden provides access to both the front and rear, the garage and driveway parking for 2 cars and an additional parking space to the front of the property. Further benefits include UPVC double glazing, gas central heating, and a pleasant outlook overlooking a green. This is a spacious and well-presented home that must be viewed to be fully appreciated.

Kitchen 10' 10" x 8' 1" (3.30m x 2.46m)

Lounge/Dining Room 15' 5" x 13' 10" (4.70m x 4.22m) *maximum measurements*

Conservatory 12' 0" x 10' 8" (3.66m x 3.25m)

Bedroom One 15' 11" x 15' 5" (4.85m x 4.70m) *maximum measurements*

Dressing Room/Study 9' 2" x 7' 2" (2.79m x 2.18m)

Ensuite 7' 2" x 6' 1" (2.18m x 1.85m)

Bedroom Two 13' 1" x 9' 0" (3.99m x 2.74m)

Bedroom Three 15' 5" x 9' 0" (4.70m x 2.74m) *maximum measurements*

Bathroom 8' 7" x 6' 8" (2.62m x 2.03m)

Ground Floor

Approx. 64.8 sq. metres (698.0 sq. feet)

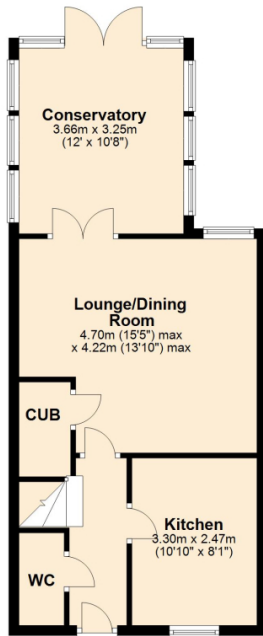
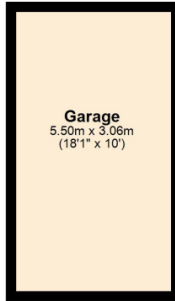

First Floor

Approx. 35.8 sq. metres (385.4 sq. feet)

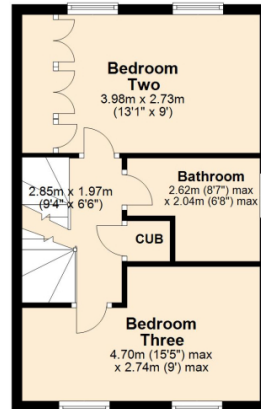

Second Floor

Approx. 32.6 sq. metres (350.7 sq. feet)

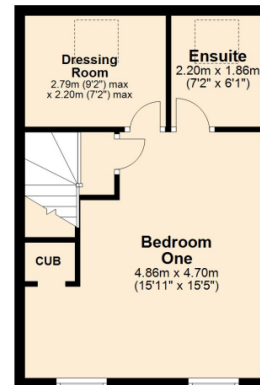

Total area: approx. 133.2 sq. metres (1434.0 sq. feet)

Energy Efficiency Rating

	Current	Potential
Very energy efficient - lower running costs		
(92+) A		
(81-91) B		
(69-80) C	79	83
(55-68) D		
(39-54) E		
(21-38) F		
(1-20) G		
Not energy efficient - higher running costs		
England, Scotland & Wales		EU Directive 2002/91/EC

Address: Davey Road, Tewkesbury, GL20

