



16, Whitfield Crescent, Copthorne Keep, Shrewsbury, SY3 8FD
£1,050 Per Month



16, Whitfield Crescent, Copthorne Keep, Shrewsbury, SY3 8FD

£1,050 Per Month

VIRTUAL TOUR AVAILABLE - An attractive two bedroom terraced house found in this historic location on the site of the former Copthorne Barracks. The Copthorne Keep development is conveniently located just a short walk from Shrewsbury town centre and the Quarry Park. Two allocated parking spaces.

Available: 22/08/2026

Description

Comprising: Entrance hall, WC, living room, kitchen/dining room with integrated washer/dryer, fridge/freezer, electric oven and gas hob. Stairs to first floor landing, two double bedrooms, bathroom with shower over bath. Front and rear gardens with storage unit yet to be installed in rear. Double glazing. Gas central heating. Two allocated parking spaces. EPC B.



Unfurnished

Council Tax Band: B

Available: 22nd August 2026

EPC: B

Floor Plans

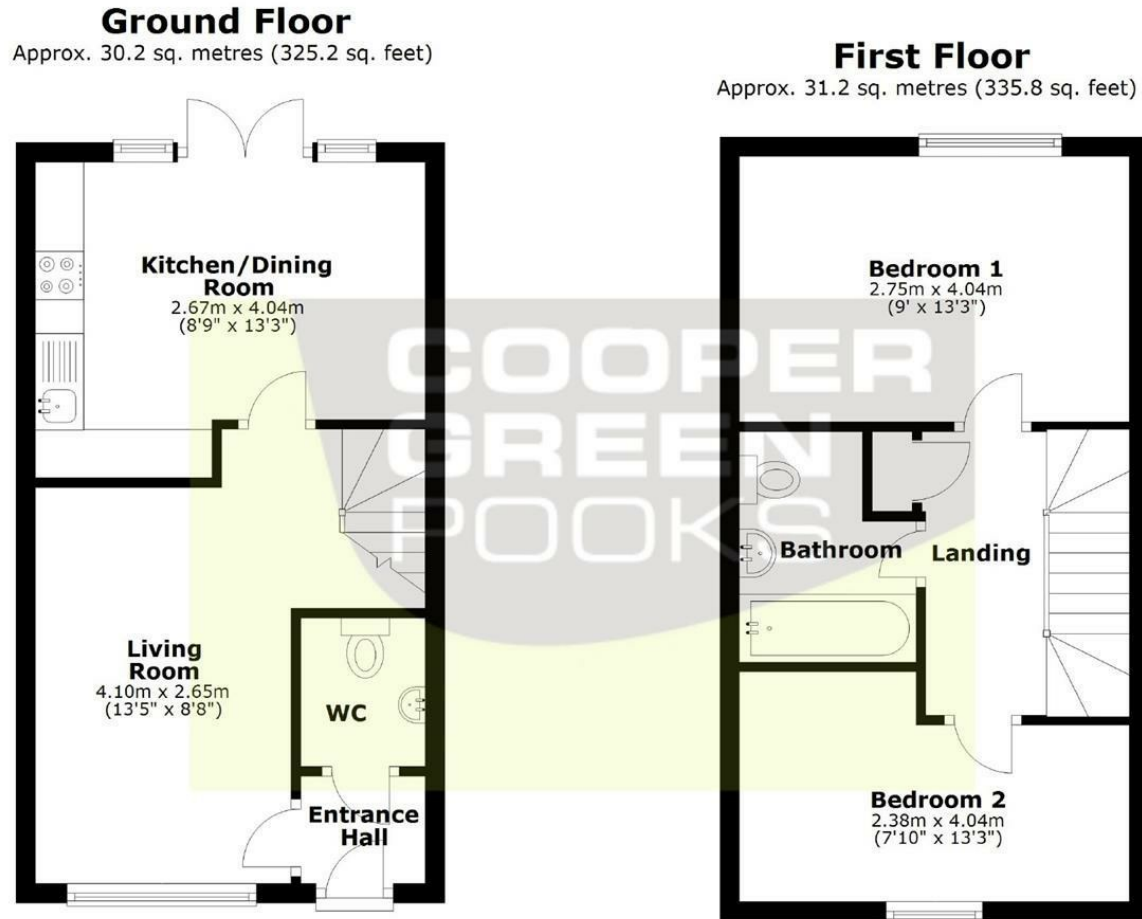

Total area: approx. 61.4 sq. metres (661.0 sq. feet)

We accept no responsibility for any mistake or inaccuracy contained within the floorplan. The floorplan is provided as a guide only and should be taken as an illustration only. The measurements, contents and positioning are approximations only and provided as a guidance tool and not an exact replication of the property.

Plan produced using PlanUp.

These particulars, whilst believed to be accurate are set out as a general outline only for guidance and do not constitute any part of an offer or contract. Intending purchasers should not rely on them as statements of representation of fact, but must satisfy themselves by inspection or otherwise as to their accuracy. No person in this firm's employment has the authority to make or give any representation or warranty in respect of the property.