



38 Twin Foxes, Woolmer Green

Knebworth

CHANDLERS

Guide Price £450,000

38 Twin Foxes

Woolmer Green, Knebworth

Council Tax band: D

Tenure: Freehold

EPC Energy Efficiency Rating: C

EPC Environmental Impact Rating: C

- GUIDE PRICE £450,000 - £465,000
- Mews-style three bedroom home
- Arranged over three floors
- Kitchen opening to sitting/dining
- Two first-floor double bedrooms
- Walk in cupboards to bedrooms
- Family bathroom
- Top-floor main bedroom suite with en-suite and walk-in wardrobe
- Covered carport plus parking
- Rear garden and village setting

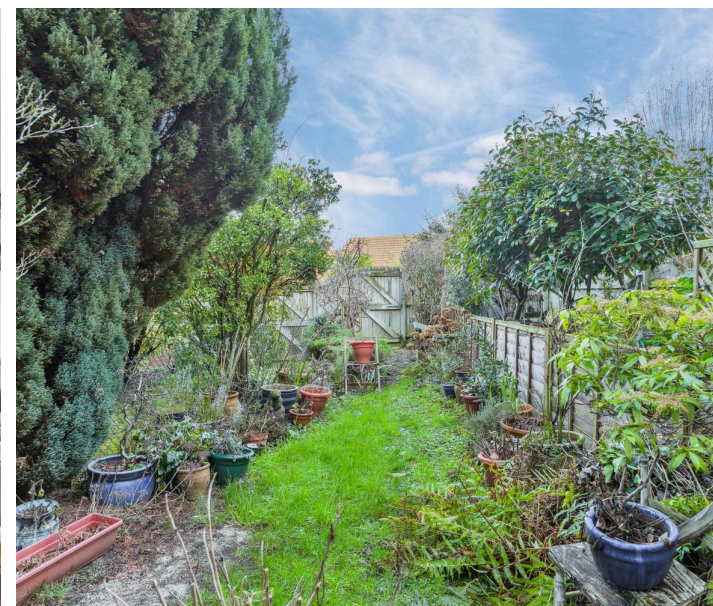



Approximate Gross Internal Area
Ground Floor = 38.1 sq m / 410 sq ft
First Floor = 36.7 sq m / 395 sq ft
Second Floor = 24.2 sq m / 260 sq ft
Total = 99.0 sq m / 1,065 sq ft
(Excluding Carport)

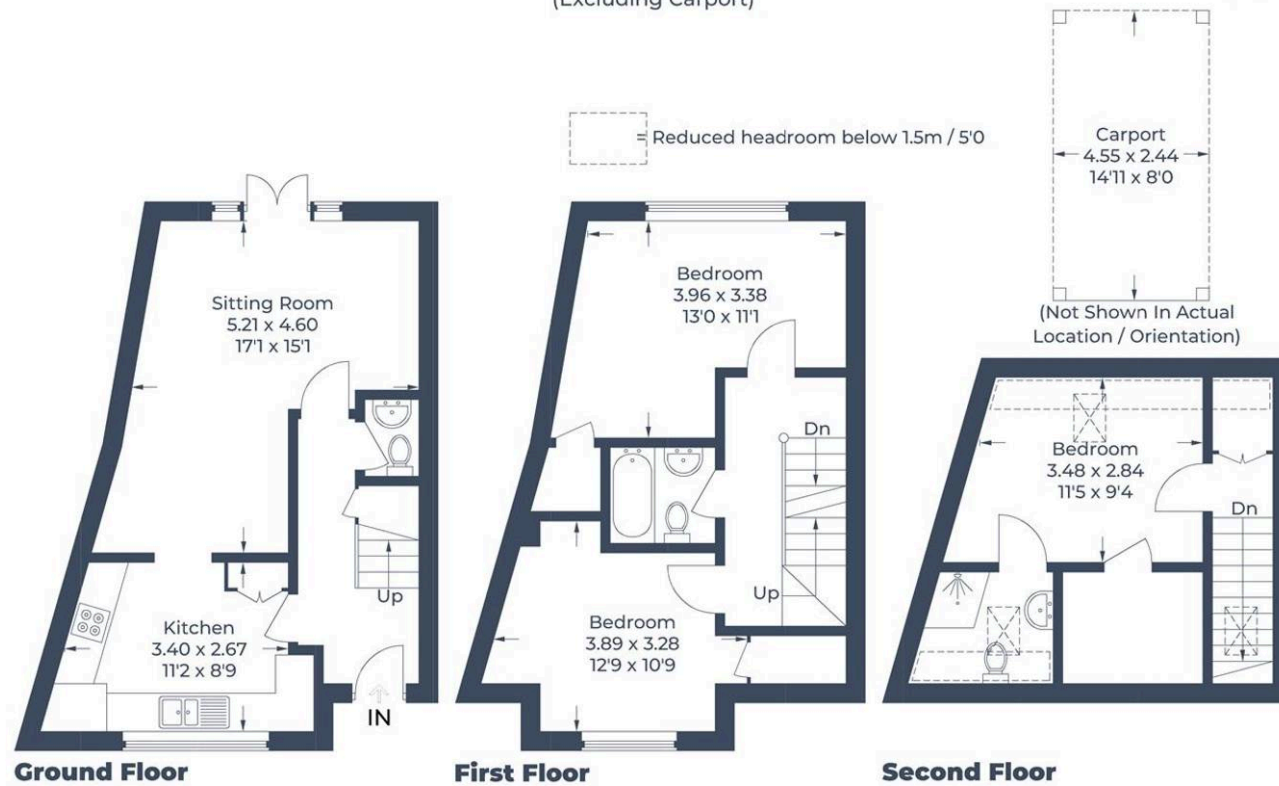

Illustration for identification purposes only,
measurements are approximate, not to scale.
© CJ Property Marketing Produced for Chandlers

Chandlers Estate Agents

Chandlers, 18 Market Place – SG1 1DB

01438356635

sales@chandlers-estates.co.uk

www.chandlers-estates.co.uk/

While we believe the details provided to be correct, we do not guarantee their accuracy. Prospective buyers should verify all information independently before making any decisions. No responsibility is taken for any errors, omissions, or misstatements.