



Connells

Auklet Close
BASINGSTOKE



Property Description

A beautifully presented three-bedroom end-of-terrace residence, enviably positioned in the sought-after Auklet Close within the highly regarded Kempshott area of Basingstoke.

This attractive home combines well-balanced accommodation with an abundance of natural light, creating a bright and inviting living environment throughout.

The ground floor is thoughtfully arranged, This flows seamlessly through to a well-appointed kitchen/dining area, fitted with a range of units and providing ample space for both everyday living and entertaining.

Upstairs, the property continues to impress with three well-proportioned bedrooms, each enjoying excellent natural light and a pleasant outlook. These versatile spaces are perfectly suited to family living, guest accommodation or home working. The bedrooms are served by a well-maintained family bathroom, finished in a clean and neutral style.

Externally, the property offers a private rear garden, providing a tranquil space for outdoor dining and relaxation. To the front, the convenience of driveway parking further enhances the home's appeal.

Kempshott remains one of Basingstoke's most desirable residential areas, well known for its strong community feel, reputable schools, and excellent access to local amenities and transport links.

Lounge

Double glazed window to front, double glazed window to rear, double glazed french doors to rear.

Kitchen

Double glazed window to rear, stainless steel sink with mixer tap, space for washing machine

Garage

Up and over door

Bedroom 1

Double glazed window to front

Bedroom 2

Double glazed window to rear

Bedroom 3

Double glazed window to front

Bathroom

Frosted double glazed window, enclosed panel bath, low level w/c, pedestal hand wash basin







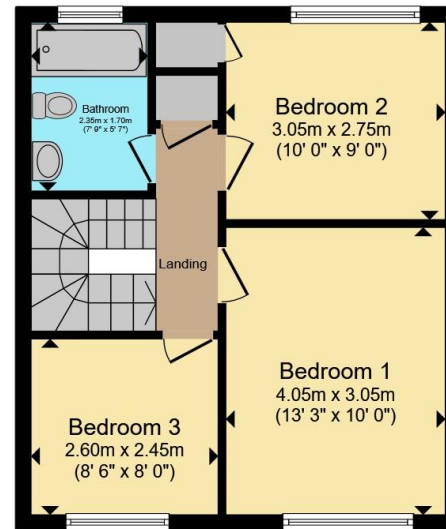
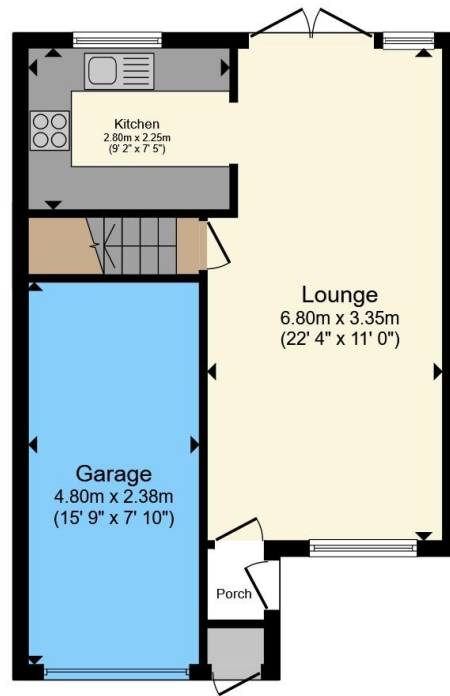

Ground Floor

First Floor

Total floor area 83.4 m² (897 sq.ft.) approx

This floor plan is for illustrative purposes only. It is not drawn to scale. Any measurements, floor areas (including any total floor area), openings and orientation are approximate. No details are guaranteed, they cannot be relied upon for any purpose and they do not form part of any agreement. No liability is taken for any error, omission or misstatement. A party must rely upon its own inspection(s). Powered by www.propertybox.io



To view this property please contact Connells on

T 01256 398237
E basingstokesouth@connells.co.uk

56 Broadmere Road Beggarwood
BASINGSTOKE RG22 4AQ

EPC Rating: Council Tax
Awaited Band: D

Tenure: Freehold

view this property online connells.co.uk/Property/KSH105910



1. MONEY LAUNDERING REGULATIONS Intending purchasers will be asked to produce identification documentation at a later stage and we would ask for your co-operation in order that there will be no delay in agreeing the sale. 2. These particulars do not constitute part or all of an offer or contract. 3. The measurements indicated are supplied for guidance only and as such must be considered incorrect. Potential buyers are advised to recheck measurements before committing to any expense. 4. We have not tested any apparatus, equipment, fixtures, fittings or services and it is in the buyers interest to check the working condition of any appliances.

Connells Residential is registered in England and Wales under company number 1489613, Registered Office is Cumbria House, 16-20 Hockliffe Street, Leighton Buzzard, Bedfordshire, LU7 1GN. VAT Registration Number is 500 2481 05.

See all our properties at www.connells.co.uk | www.rightmove.co.uk | www.zoopla.co.uk

Property Ref: KSH105910 - 0004