



Jupiter Road, Barton Seagrave, Kettering **Freehold** £275,000 O.I.E.O.

**Pattison  
Lane**

# Key Features

 3  2  B  C

- Semi-Detached Family Home
- Three Double Sized Bedrooms
- Spacious Living Room
- En-Suite to Master
- Driveway for Two Vehicles

Welcome to the market, this beautifully presented three-bedroom semi-detached home, perfectly positioned within the highly sought-after Hanwood Park development. Situated within close proximity to local amenities including shops, schools, and exceptional road links for easy access.



The heart of the home features a sleek, modern kitchen/dining room designed for family life, complemented by a bright and airy living room. Large French doors create a seamless transition to the private rear garden, while a generously sized cloakroom/WC adds everyday convenience.

Upstairs boasts three well-proportioned double bedrooms. The master bedroom serves as a private retreat, complete with a contemporary en-suite shower room and additional storage.

The rear garden offers a secure, landscaped escape perfect for alfresco dining. To the front, a private driveway provides side-by-side parking for two vehicles.

Viewings are highly advised to appreciate all this home has to offer!

The accommodation comprises:

ENTRANCE HALL

CLOAKROOM

KITCHEN / DINING ROOM 13' x 104' (3.96m x 3.14m)

LIVING ROOM 15'10 x 11' (4.82m x 3.35m)



GROUND FLOOR

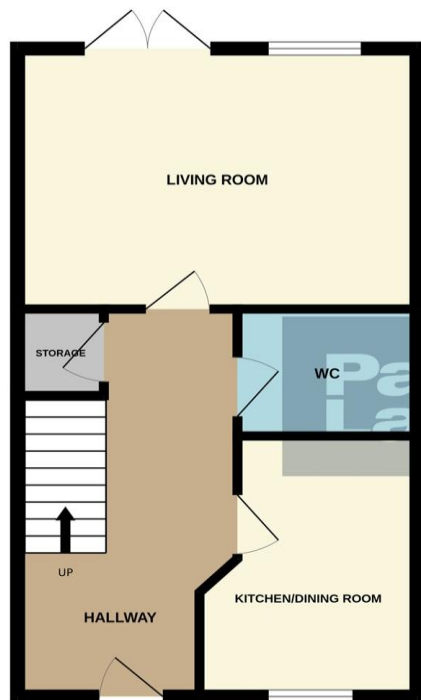

1ST FLOOR

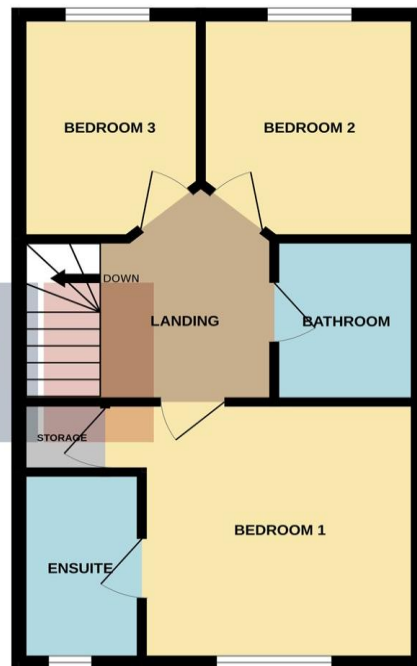

Whilst every attempt has been made to ensure the accuracy of the floorplan contained here, measurements of doors, windows, rooms and any other items are approximate and no responsibility is taken for any error, omission or mis-statement. This plan is for illustrative purposes only and should be used as such by any prospective purchaser. The services, systems and appliances shown have not been tested and no guarantee as to their operability or efficiency can be given.  
Made with Metropix ©2026

## FIRST FLOOR LANDING

BEDROOM ONE 11' x 10' (3.35m x 3.04m)

## EN SUITE

BEDROOM TWO 9'6 x 8'6 (2.89m x 2.59m)

BEDROOM THREE 9'6 x 7'2 (2.89m x 2.18m)

## BATHROOM

## OUTSIDE

FRONT GARDEN / DRIVEWAY

REAR GARDEN

## AGENTS NOTE:

Annual Management / Service charge - £189.68

To view this property call Pattison Lane on:  
**01536 524425**

# Selling your property?



SCAN ME

Contact us to arrange a **FREE** home valuation.

 01536 524425

 68-70 Gold Street, Kettering, Northamptonshire, NN16 8JB

 [kettering@pattisonlane.co.uk](mailto:kettering@pattisonlane.co.uk)

 [www.pattisonlane.co.uk](http://www.pattisonlane.co.uk)



SCAN ME



Sharman Quinney Holdings Limited is registered in England and Wales under company number 4174227, Registered Office is Cumbria House, 16-20 Hockliffe Street, Leighton Buzzard, Bedfordshire, LU7 1GN. VAT Registration Number is 500 2481 05.

1: These particulars do not constitute part or all of an offer or contract. 2: The measurements indicated are supplied for guidance only and as such must be considered incorrect. 3: Potential buyers are advised to recheck the measurements before committing to any expense. 4: Sharman Quinney has not tested any apparatus, equipment, fixtures, fittings or services and it is the buyers interests to check the working condition of any appliances. 5: Sharman Quinney has not sought to verify the legal title of the property and buyers must obtain verification from their legal representative. 6: Intending purchasers will be asked to produce identification documentation at a later stage and we would ask your co-operation in order that there will be no delay in agreeing the sale. Ref: KPL206818 - 0003

