



Bevills Close, Doddington PE15 0TT

welcome to

Bevills Close, Doddington

Beautifully Renovated Three Bedroom Semi Detached Home - Located in the popular Village of Doddington
Finished to an exceptionally high standard throughout - New Heating System - Recently re-fitted stunning Kitchen
& Bathroom - Off Road Parking Garage with RCD unit - Enclosed Rear Garden



Entrance Door**Entrance Hall**

Poly vinyl flooring.

Lounge

Two windows to front. Radiator. Stairs leading off. Under stairs storage cupboard.

Kitchen

Window to rear. Range of wall cupboards and base units with work surfaces and tiled splashbacks. Additional breakfast bar area. Wall mounted enclosed boiler. Under counter oven with induction hob. Space for appliances. Single drainer sink with mixer taps. Radiator.

Bathroom (Ground Floor)

Window to rear. Marble floor and wall tiles. Panelled bath with mixer taps with shower over. Low level and combi vanity wash hand basin.

Stairs To First Floor Landing

Window to side. Loft access. Storage cupboard. Radiator.

Bedroom One

Two windows to front. Radiator.

Bedroom Two

Window to rear. Laminate floor. Radiator.

Bedroom Three

Window to rear. Radiator.

Outside

Laid grass. Paths. Parking fronting garage. Additional lawned area. Gated access to rear garden.

Rear garden has outside lighting. Outside tap. Outside sockets. Enclosed with decked raised seating area. Raised beds. Low maintenance laid stone.

Garage

21' 4" x 9' 7" (6.50m x 2.92m)

Up and over door. Personal door to side. Boarded space above. Separate RCD unit. Power and lighting. Please note: the garage is currently studded off for internal storage however could be opened back up, if required.

Special Features

Re-wired
Replacement boiler
Renovated to a high standard throughout



view this property online williamhbrown.co.uk/Property/MCH114598



welcome to

Bevills Close, Doddington

- Three Bedroom Semi Detached House
- Recently Renovated
- New Kitchen / Bathroom
- NEW Central Heating System & RCD Unit
- Garage & Off Road Parking

Tenure: Freehold
EPC Rating: D
Council Tax Band: B

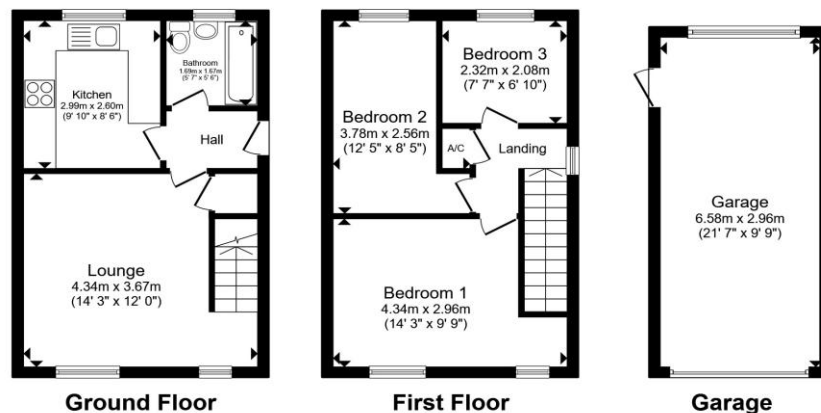

£240,000

Total floor area 79.5 m² (855 sq.ft.) approx
This floor plan is for illustrative purposes only. It is not drawn to scale. Any measurements, floor areas (including any total floor area), openings and orientation are approximate. No details are guaranteed, they cannot be relied upon for any purpose and they do not form part of any agreement. No liability is taken for any error, omission or misstatement. A party must rely upon its own inspection(s). Powered by www.propertybox.io



Please note the marker reflects the postcode not the actual property

view this property online williamhbrown.co.uk/Property/MCH114598



Property Ref:
MCH114598 - 0003

1. MONEY LAUNDERING REGULATIONS Intending purchasers will be asked to produce identification documentation at a later stage and we would ask for your co-operation in order that there is no delay in agreeing the sale. 2. These particulars do not constitute part or all of an offer or contract. 3. The measurements indicated are supplied for guidance only and as such must be considered incorrect. Potential buyers are advised to recheck measurements before committing to any expense. 4. We have not tested any apparatus, equipment, fixtures or services and it is in the buyers interest to check the working condition of any appliances. 5. Where an EPC, or a Home Report (Scotland only) is held for this property, it is available for inspection at the branch by appointment. If you require a printed version of a Home Report, you will need to pay a reasonable production charge reflecting printing and other costs. 6. We are not able to offer an opinion either written or verbal on the content of these reports and this must be obtained from your legal representative. 7. Whilst we take care in preparing these reports, a buyer should ensure that his/her legal representative confirms as soon as possible all matters relating to title including the extent and boundaries of the property and other important matters before exchange of contracts.



william h brown



01354 654545



march@williamhbrown.co.uk



34 High Street, MARCH, Cambridgeshire, PE15 9JR



williamhbrown.co.uk