

Mark Anthony

Estate Agents



56 Stoneleigh Crescent, Stoneleigh, KT19 0RW
Offers in excess of £800,000

 3  2  2  C



56 Stoneleigh Crescent, Stoneleigh, KT19 0RW

Offers in excess of £800,000

Mark Anthony are proud to bring to the market this stunning three double bedroom family home situated on one of the areas most sought after premier roads. The property has been skillfully upgraded by the current owners to provide a fabulous free flowing modern family home.

From the moment you first step into the property you realise that you are in a home of exceptional quality. The welcoming entrance hall leads to a spacious 18 ft reception room with a deep bay window flooding the room with natural light, making this the perfect space to relax in. The rear of the property provides modern an open plan kitchen / family room with a gorgeous high end fitted kitchen and large family / dining area overlooking and accessing the landscaped rear garden. This is a wonderful space for modern family living and entertaining. The useful utility room /garage is accessed internally from the hallway and offers further potential to convert. The ground floor accommodation is completed with a luxury WC.

The light and airy first floor provides three immaculately presented double bedrooms all with built in wardrobes and the master has ensuite shower room. The luxury family bathroom with large walk in shower and separate bath is finished with underfloor heating and mood lighting making this the perfect room to relax and unwind in.

Outside the landscaped Southerly aspect rear garden extends to 75 ft with two beautiful patios allowing you to have both shade or sun whichever is your preference. The home worker has not been forgotten as there is a superb home office to the rear of the garden. With power, lighting and internet this is a fantastic space to work from. This light room could have numerous other uses from art room to family playroom.

This stunning property offers the potential to extend (stpp) and plans for a spectacular 330 ft loft conversion are available for inspection upon viewing. Brought to the market with no onward chain, this wonderful home merits immediate viewing.

- Stunning three double bedroom family home situated on one of the areas most sought after premier roads
- Easy 7 minute walk to the mainline station Zone 5, with a direct line into the Capital
- Potential to extend (stpp) and plans for loft conversion (spectacular 330 sq ft) are available for inspection upon viewing
- Spacious 18 ft reception room with a deep bay window flooding the room with natural light
- Modern open plan kitchen / family room with a gorgeous high end fitted kitchen and large family / dining area
- Three immaculately presented double bedrooms all with built in wardrobes and the master has ensuite shower room
- Luxury family bathroom with large walk in shower and separate bath is finished with underfloor heating and mood lighting
- Landscaped Southerly aspect 75 ft rear garden with two gorgeous patio areas
- Superb garden office with power, lighting and internet making this is a fantastic space to work from
- Herringbone block paved driveway providing ample off street parking



Floor Plans

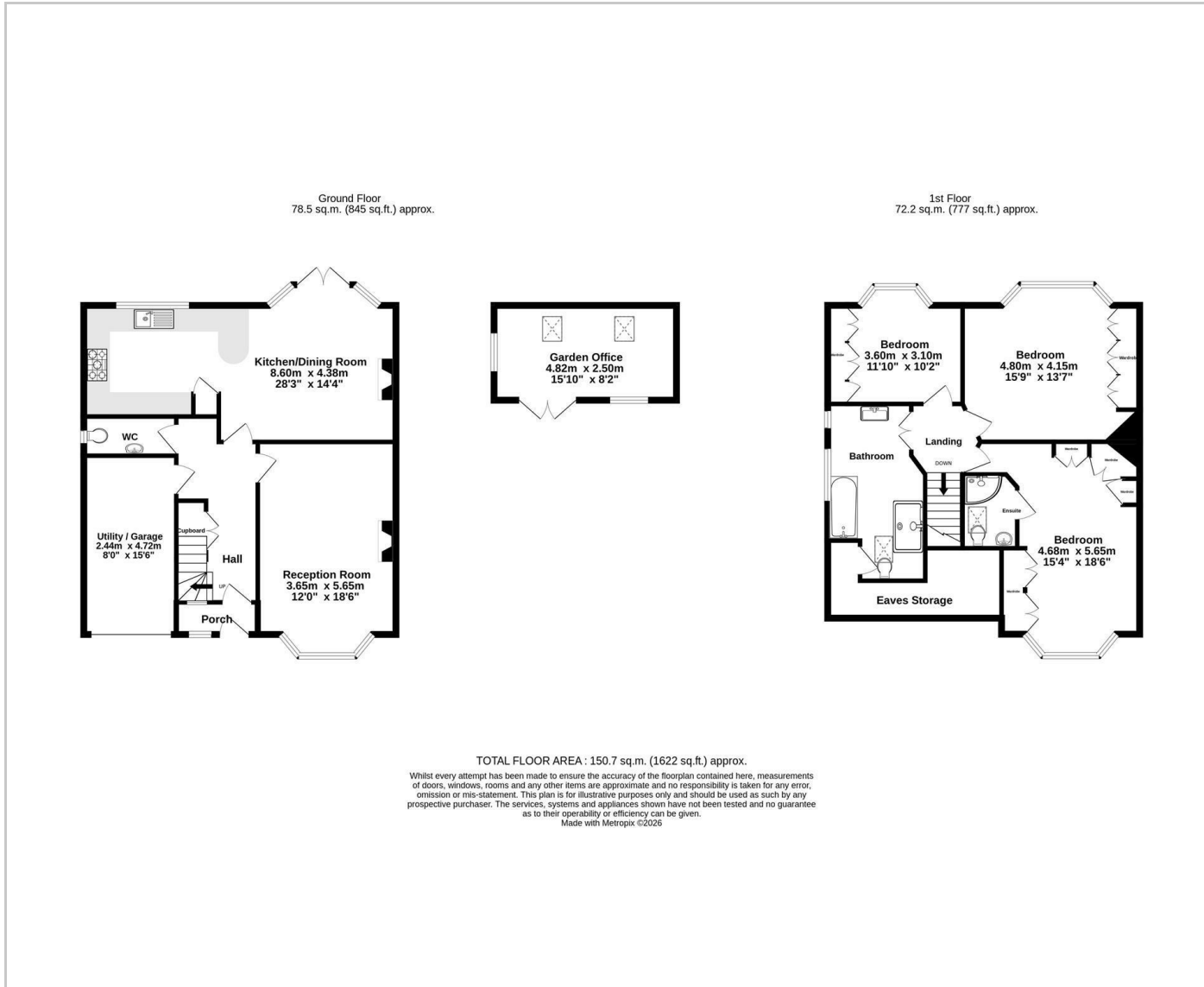

Area Map

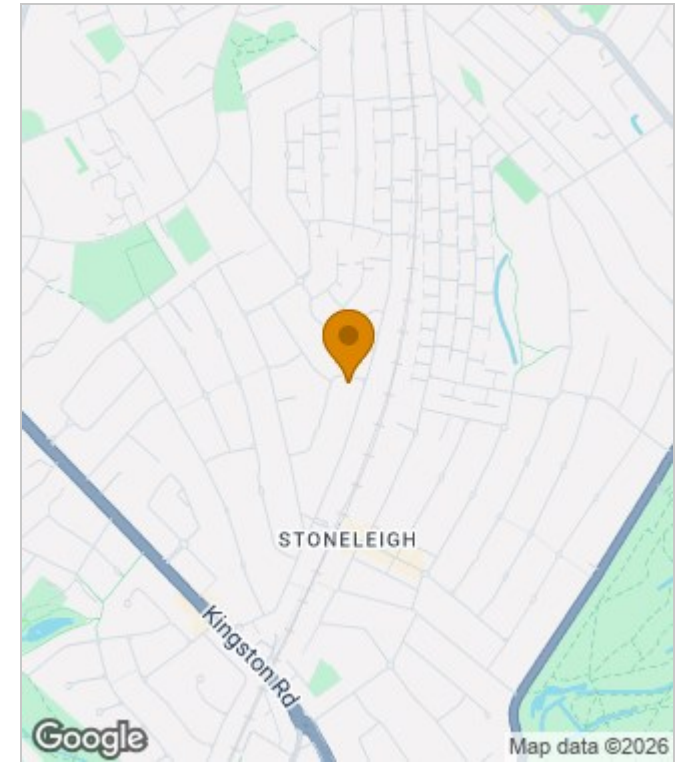

Energy Performance Graph

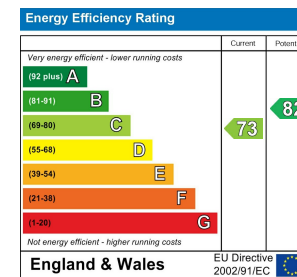

These particulars, whilst believed to be accurate are set out as a general outline only for guidance and do not constitute any part of an offer or contract. Intending purchasers should not rely on them as statements of representation of fact, but must satisfy themselves by inspection or otherwise as to their accuracy. No person in this firm's employment has the authority to make or give any representation or warranty in respect of the property.