



Pelham Close, Newark

Guide Price £170,000 to £175,000



## Pelham Close, Newark

MARKETED WITH NO CHAIN Conveniently positioned a stone's throw from Newark town centre and its host of local amenities, this semi-detached home represents a brilliant first time or investment home and offers a blank canvas for a buyer to make it their own.

The property's accommodation comprises: spacious lounge with useful downstairs cupboard, dining kitchen that stretches across the rear of the property with appliances to include a four-ring gas hob and electric oven, two double bedrooms, with the main bedroom having built in wardrobes, and a superb shower room.

Outside, this home enjoys a driveway to the side of the property with access to a single garage. The rear garden is predominantly laid to lawn with a variety of plants to borders. Other features of this home include gas central heating and UPVC double glazing.

Council Tax Band: A

Tenure: Freehold

EPC Energy Efficiency Rating: C





## ACCOMMODATION - Rooms & Measurements

### Lounge

16' 7" x 14' 1" (5.06m x 4.29m)  
maximum measurements

### Dining Kitchen

13' 10" x 9' 4" (4.22m x 2.85m)  
maximum measurements

### First Floor Landing

### Bedroom One

13' 7" x 10' 9" (4.14m x 3.28m)

### Bedroom Two

11' 2" x 7' 9" (3.40m x 2.36m)

### Shower Room

8' 1" x 5' 10" (2.46m x 1.78m)

### Garage

18' 0" x 8' 0" (5.49m x 2.44m)

### Agent's Note - Probate

The sale of the property is subject to Probate which has been granted.

### Agent's Note - Access

There is right of access through neighbouring land to access the rear gate of the property.



### Services

Mains gas, electricity, water and drainage are connected.

### Square Footage

The square footage for this property is approximately 855 sq ft. Please note whilst every care is taken in providing this information as accurately as possible, this figure is calculated whilst creating the property's floor plan, which does not factor in a number of potential variations including wall thickness, curves, triangular walls, chimney breasts etc and alterations to the floorplan to ensure it is representative of the property's layout. The square footage may also include garages, porches, outbuildings, garden buildings and external corridors where applicable, please contact the office for further information/clarification. The EPC and Interactive Property Report may show a different total square footage.

### Agent's Note - Sales Particulars

Although these particulars are thought to be materially correct, their accuracy cannot be guaranteed, and they do not form part of any contract. All services, heating systems and appliances have not and will not be tested, and no guarantees have been provided for any aspects of the property, measurements are taken internally and cannot be assumed to be accurate, they are given as a guide only.





### **Anti-Money Laundering Regulations**

Intending purchasers will be asked to confirm their identity at the offer stage and we ask for your co-operation in order that there will be no delay in agreeing a sale.

### **Referrals**

Newton Fallowell Newark and our partners provide a range of services to our vendors and buyers. Conveyancing - If you require a solicitor to handle your sale or purchase, we can refer you on to a panel of preferred providers, we may receive a referral of up to £350 if you choose to use their services, there is no obligation to use solicitors we refer to. Mortgage Advice - Correct budgeting is crucial before committing to purchasing a property. You are free to arrange your own advice, but we can refer you to the Mortgage Advice Bureau who are in house for specialist advice on 1000s of mortgage deals if required. Please be aware that we may receive a fee of £332 if you ultimately choose to arrange a mortgage/insurance through them. Property Surveys - If you require a property survey of any kind, we can refer you to an RICS surveyor, and we may receive a referral fee of up to £30 should you choose to arrange a survey through them. For more information, please call the office.

GROUND FLOOR



1ST FLOOR

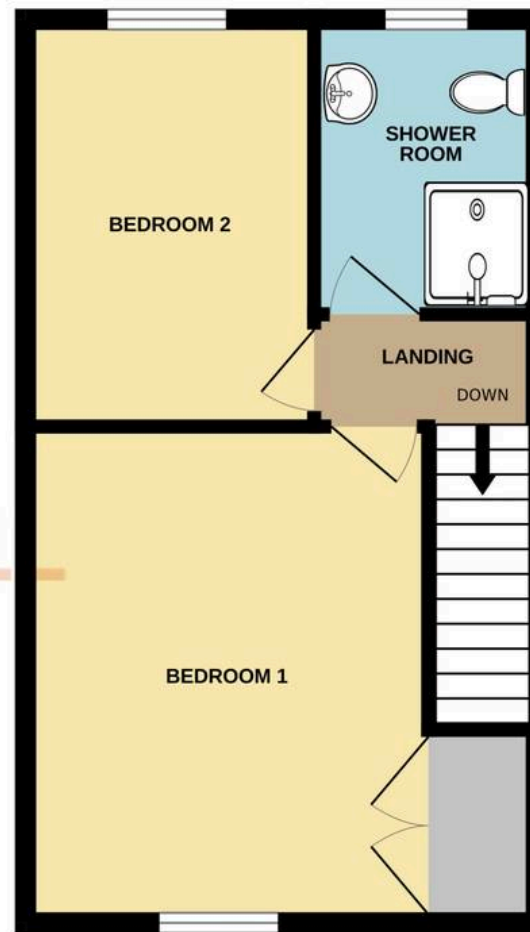

Whilst every attempt has been made to ensure the accuracy of the floorplan contained here, measurements of doors, windows, rooms and any other items are approximate and no responsibility is taken for any error, omission or mis-statement. This plan is for illustrative purposes only and should be used as such by any prospective purchaser. The services, systems and appliances shown have not been tested and no guarantee as to their operability or efficiency can be given.  
Made with Metropix ©2025



## Newton Fallowell

Newton Fallowell, 12-14 Middle Gate - NG24 1AG

01636706444 · [newark@newtonfallowell.co.uk](mailto:newark@newtonfallowell.co.uk) · [www.newtonfallowell.co.uk/](http://www.newtonfallowell.co.uk/)

 **NEWTON FALLOWELL**