



**Connells**

Joyce Rise  
Glebe Farm Milton Keynes



### Property Description

Set within the desirable and modern community of Glebe Farm, this beautifully presented two bedroom home offers comfortable, contemporary living in a peaceful yet well connected location. Perfect for first time buyers, downsizers, or investors, the property delivers a thoughtful layout and stylish finishes throughout. The home features a bright and inviting living space, a modern fitted kitchen, and two well-proportioned bedrooms offering flexibility for sleeping, working, or guest accommodation. A convenient ground floor WC adds to the practicality of the layout.

Outside, the property truly shines with its professionally landscaped garden, a low maintenance, attractive space ideal for relaxing, entertaining, or enjoying a quiet moment outdoors.

Further enhancing the appeal are two dedicated parking spaces, providing valuable convenience for residents and visitors.

Located close to local amenities, landscaped parks, and excellent transport links, this delightful home represents a fantastic opportunity to become part of a vibrant and growing community.

### Entrance

Antico flooring, wall mounted radiator, entrance to WC & family room.

### Cloakroom

Toilet, Sink, Radiator and laminate flooring.

### Lounge

Radiator, Windows to the front with laminate flooring.

### Kitchen

Dishwasher, Washing Machine, Gas Hob, Integrated Oven, Fridge/Freezer, Combi Boiler with Laminate Flooring throughout,

## Landing

Carpet, radiator and cupboard space.

## Bedroom One

Carpet, window to the rear, radiator and fitted wardrobe.

## Bedroom Two

Carpet, radiator with window to front.

## Bathroom

Half tiled, full wall mirror, 3 piece suite, shaver socket.

## Rear Garden

Landscaped, artificial grass, outside tap, Indian sandstone tiled patio.



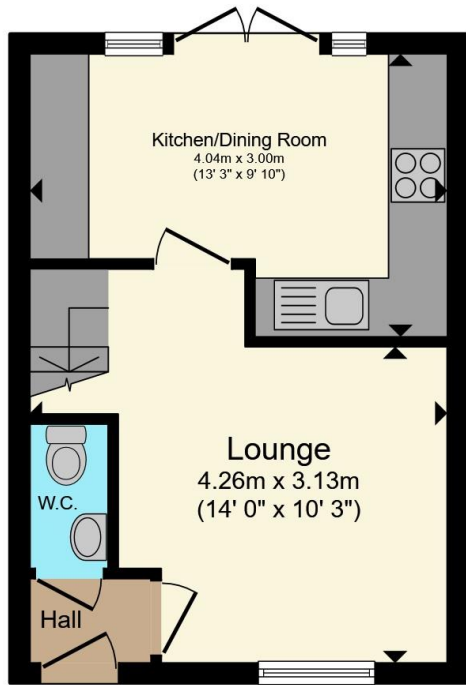

**Ground Floor**

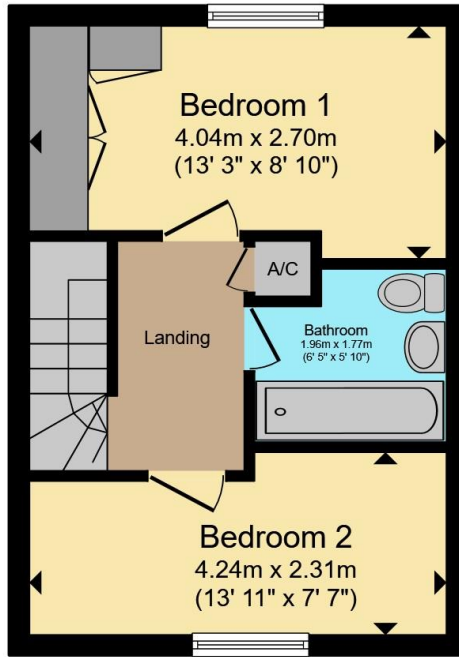

**First Floor**



Total floor area 53.1 m<sup>2</sup> (571 sq.ft.) approx

This floor plan is for illustrative purposes only. It is not drawn to scale. Any measurements, floor areas (including any total floor area), openings and orientation are approximate. No details are guaranteed, they cannot be relied upon for any purpose and they do not form part of any agreement. No liability is taken for any error, omission or misstatement. A party must rely upon its own inspection(s). Powered by [www.propertybox.io](http://www.propertybox.io)



To view this property please contact Connells on

**T 01908 691606**

**E [walnuttree@connells.co.uk](mailto:walnuttree@connells.co.uk)**

26A Fyfield Barrow The Walnut Tree Local Centre Walnut Tree

EPC Rating: B Council Tax Band: C

**view this property online [connells.co.uk/Property/WNT308018](http://connells.co.uk/Property/WNT308018)**

Tenure: Freehold



1. MONEY LAUNDERING REGULATIONS Intending purchasers will be asked to produce identification documentation at a later stage and we would ask for your co-operation in order that there will be no delay in agreeing the sale. 2. These particulars do not constitute part or all of an offer or contract. 3. The measurements indicated are supplied for guidance only and as such must be considered incorrect. Potential buyers are advised to recheck measurements before committing to any expense. 4. We have not tested any apparatus, equipment, fixtures, fittings or services and it is in the buyers interest to check the working condition of any appliances.

Connells Residential is registered in England and Wales under company number 1489613, Registered Office is Cumbria House, 16-20 Hockliffe Street, Leighton Buzzard, Bedfordshire, LU7 1GN. VAT Registration Number is 500 2481 05.

**See all our properties at [www.connells.co.uk](http://www.connells.co.uk) | [www.rightmove.co.uk](http://www.rightmove.co.uk) | [www.zoopla.co.uk](http://www.zoopla.co.uk)**

Property Ref: WNT308018 - 0012