



2 Bed  
Flat  
located in  
Albermale  
Mansions, Medina  
Terrace

Asking price £600,000



TAYLOR  
MICHAEL

# Albermarle Mansions, Medina Terrace, Hove, BN3 2WL

Approximate Gross Internal Area = 95.9 sq m / 1032 sq ft

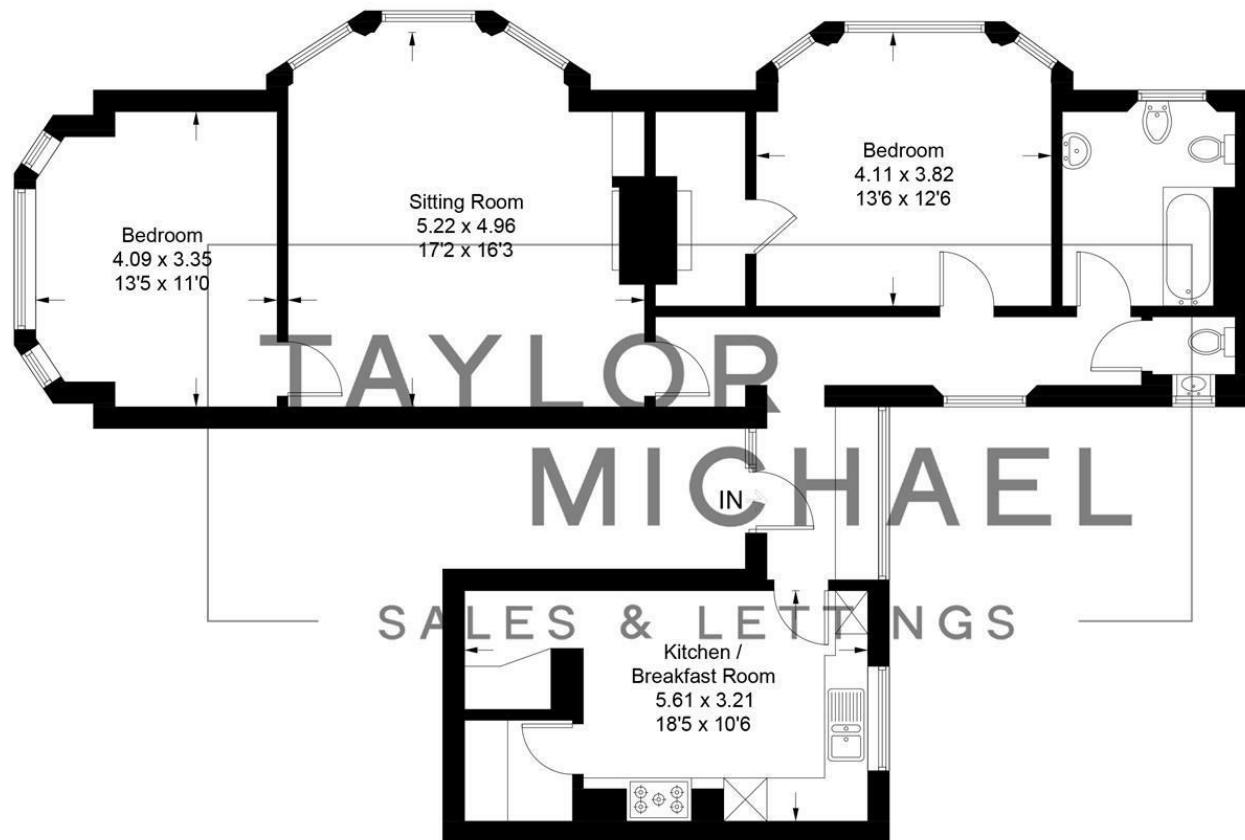

## Ground Floor

Illustration for identification purposes only, measurements are approximate, not to scale.  
Imageplansurveys @ 2026

## DIRECTIONS

## CONTACT

62 Church Road  
Hove  
East Sussex  
BN3 2FP

E: [lettings@taylormichael.agency](mailto:lettings@taylormichael.agency)  
T: 01273 600100  
<https://taylormichael.agency/>

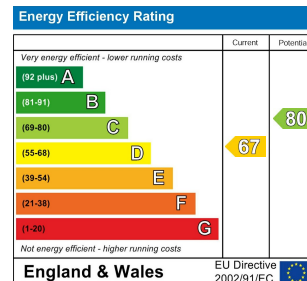

TAYLOR  
MICHAEL