



BROOK GAMBLE



Berkeley House 26-28 Gildredge Road , Eastbourne, BN21 4SA

Brook Gamble offer to the market this 1 bedroom 4th (top) floor apartment in Eastbourne Town Centre. The property benefits from wonderful panoramic views across rooftops toward The South Downs. The flat enjoys an open plan Lounge/Kitchen whilst the Bedroom benefits from fitted wardrobes. Further benefits include electric heating and uPVC double glazing as well as an allocated parking space. The Town Centre location provides easy access to Eastbournes' shops, seafront, railway station, restaurants and theatres. Being sold chain free, viewing is considered essential. Sole agents.

£167,500

Berkeley House 26-28 Gildredge Road , Eastbourne, BN21 4SA



- Top Floor Apartment
- Open Plan Lounge/Kitchen
- Town Centre Location
- Sole Agents
- Stunning Far Reaching Views
- UPVC Double Glazing
- Close Railway Station
- Allocated Parking
- Electric Heating
- Chain Free

Communal Entrance

Private Entrance

Lounge

12' x 8'5 (3.66m x 2.57m)

Kitchen

6'2 x 9'5 (1.88m x 2.87m)

Bedroom

14'1 x 10'9 (4.29m x 3.28m)

Bathroom

Allocated Parking Space

Other Information



Directions

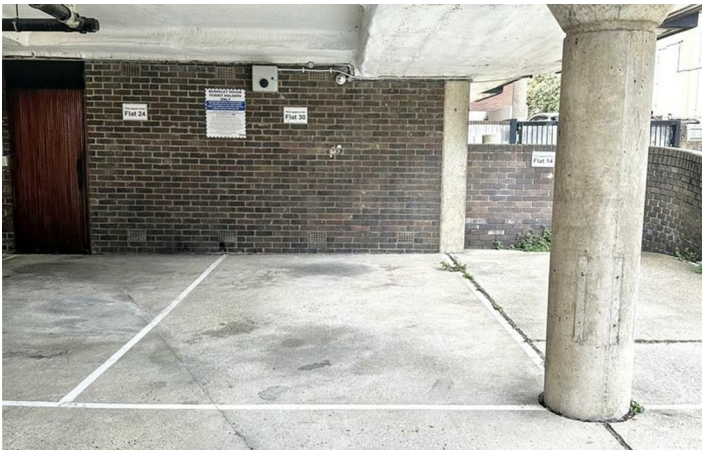



Floor Plan

Approx Gross Internal Area
41 sq m / 442 sq ft

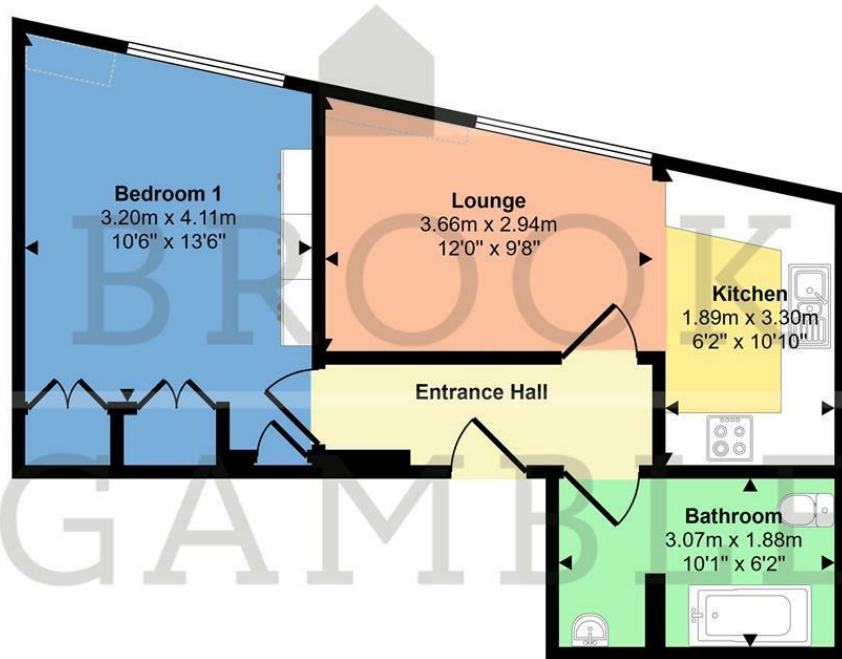

Floorplan

Denotes head height below 1.5m

This floorplan is only for illustrative purposes and is not to scale. Measurements of rooms, doors, windows, and any items are approximate and no responsibility is taken for any error, omission or mis-statement. Icons of items such as bathroom suites are representations only and may not look like the real items. Made with Made Snappy 360.

These particulars, whilst believed to be accurate are set out as a general outline only for guidance and do not constitute any part of an offer or contract. Intending purchasers should not rely on them as statements of representation of fact, but must satisfy themselves by inspection or otherwise as to their accuracy. No person in this firm's employment has the authority to make or give any representation or warranty in respect of the property.

